

TEC Professional Services Questionnaire

A. Project Name and Advertisement Resolution Number:
Professional Landscape Architectural Services
SOQ 24-008

B. Firm Name & Address:



Duplantis Design Group, PC
9015 Bluebonnet Boulevard
Baton Rouge, LA 70810

C. Name, title and contact information of Principal, as defined in Section 2-926 of the Jefferson Parish Code of Ordinances, who is a registered, licensed architect, professional engineer, or surveyor in the State of Louisiana:

Chad D. Danos, PLA, FASLA- Professional in Charge of Project
Vice President of Landscape Architecture + Principal
9015 Bluebonnet Boulevard, Baton Rouge, LA 70810
225.751.4490
cdanos@ddgpc.com

D. Name and contact information of employee who is a registered and licensed architect, professional engineer, or surveyor in the State of Louisiana in the applicable discipline. A subcontractor may be substituted here only if the advertised Project requires more than one discipline.

Chad D. Danos, PLA, FASLA- Professional in Charge of Project
Vice President of Landscape Architecture + Principal
9015 Bluebonnet Boulevard, Baton Rouge, LA 70810
225.751.4490
cdanos@ddgpc.com

E. Please provide the number of employees whose primary function corresponds with each category:

<u>22</u> Administrative	___ Estimators	___ Specification Writers
<u>9</u> Architects (Licensed)	___ Geologists	___ Structural Engineers
___ Chemical Engineers	___ Geotechnical Engineers	___ Graduate Engineers
<u>26</u> Civil Engineers	___ Interior Designers	<u>28</u> Project Managers
<u>5</u> Construction Inspectors	<u>4</u> Landscape Architects	___ Clerical
___ Ecologists	<u>2</u> Land Surveyor	<u>1</u> Grant/Funding Specialist
___ Electrical Engineers	___ Mechanical Engineers	___ Sanitary Engineers
<u>18</u> Engineer Intern	___ Environmental Engineers	
<u>4</u> Professional Land Surveyors		

Other: 23 Survey Crew 2 GIS 170 TOTAL
2 Environmental Scientists 24 Drafters

F. Is this submittal by a JOINT-VENTURE? Please check:

☐

YES

☒

NO

If marked "No" skip to Section I. "Yes" completed Sections G-H.

TEC Professional Services Questionnaire

G. If submittal is by JOINT-VENTURE, list the firms participating and outline specific areas of responsibility (including administrative, technical, and financial) for each firm. Please attach additional pages if necessary.

1. N/A

2. N/A

H. Has this JOINT-VENTURE previously worked together? Please check: Yes_____ No _____

I. List all subcontractors anticipated for this Project. Please note that all subcontractors must submit a fully completed copy of this questionnaire, applicable licenses, and any other information required by the advertisement. See Jefferson Parish Code of Ordinances, Sec. 2-928(a)(3). Please attach additional pages if necessary.

Name & Address:	Specialty:	Worked with Firm Before (Yes or No):
 Moses Engineers 909 Poydras Street, Ste 1100 New Orleans, LA 70112	Mechanical, Electrical, Plumbing Engineering Consultants	Yes, Moses Engineers has worked with DDG before.

J. Please specify the total number of support personnel that may assist in the completion of this Project: 14

TEC Professional Services Questionnaire

PROFESSIONAL IN CHARGE OF PROJECT:
Name & Title:
Chad D. Danos, PLA, FASLA Vice President of Landscape Architecture + Principal
Project Assignment:
Professional in Charge of the Project
Name of Firm with which associated:
Duplantis Design Group, PC
Years' experience with this firm:
14 Years
Education: Degree(s)/Year/Specialization:
Bachelor of Landscape Architecture, 1990, Louisiana State University
Active registration: Year first registered/discipline:
Licensed in 1996/ Registered Landscape Architect / Landscape Architecture Louisiana, #D-261
Other experience and qualifications relevant to the proposed Project:
<p>John Alario, Jr. Sports Complex - Westwego, LA</p> <p>Moncus Park Phase II - Lafayette, LA</p> <p>Iberville Parish Parks Framework Guide + Park Audit - Iberville Parish, LA</p> <p>St. Tammany Parish Sportsplex Master Plan - Slidell, LA</p> <p>Iberville Parish - Belleview Park Master Plans + Renovation - Plaquemine, LA</p> <p>Rotary Centennial Plaza - Houma, LA</p> <p>Port Fourchon Recreation Coastal Wetlands Park Master Plan - Lafourche Parish, LA</p> <p>Willow + Castille Corridors - Lafayette, LA</p> <p>Lafourche Multi-Use Trail Master Plan - Lafourche Parish, LA</p> <p>Jimmie Davis Bridge Linear Park - Shreveport, LA</p> <p>BREC Howell Community Park - Baton Rouge, LA</p> <p>Center Circle Park Master Plan + Renovations - Sulphur, LA</p> <p>Louisiana Statewide Comprehensive Outdoor Recreation Plan (SCORP) 2020 - Statewide, LA</p> <p>BREC Burbank Soccer Park - Baton Rouge, LA</p>

CHAD D. DANOS, FASLA, PLA

PROFESSIONAL IN CHARGE OF PROJECT

VICE PRESIDENT OF LANDSCAPE ARCHITECTURE + PRINCIPAL



A leader in his field, Chad Danos approaches each challenge with conviction inspired by his South Louisiana heritage and work ethic. Chad has an intimate awareness of the rich cultural differences and shared values throughout the state, offering Louisiana clients a local and cultural perspective that he utilizes to create successful and regionally appropriate designs. Chad offers a set of skills to the DDG portfolio of planning, design and implementation of outdoor environments that provide added value to our client's projects. Chad combines three decades of project and leadership experience with his passion for functional, yet sustainable design.

NOTABLE AWARD WINNING DESIGNS

- Iberville Parks & Recreation Framework Guide - Louisiana Chapter ASLA Merit Award
- Lafourche Parish Multi-use Path Master Plan - Louisiana Chapter ASLA Merit Award
- Episcopal High School Rain Garden - Louisiana Chapter ASLA Merit Award
- North Boulevard Town Square - Louisiana Chapter ASLA Honor Award
- East Baton Rouge Stormwater BMP Manual - Louisiana Chapter ASLA Merit Award
- Louisiana Speaks: Regional Plan - Louisiana Chapter ASLA Award of Excellence

RELEVANT PROJECT EXPERIENCE

John Alario, Jr. Sports Complex - Westwego, LA

Master Planning, Conceptual Design, Stakeholder Engagement, Competitive Sports Fields, Capital Outlay

Moncus Park Phase II - Lafayette, LA

Design and Implementation of Themed and Inclusive Playground, Water Feature, Treehouse, Community Amphitheater, Veteran's Memorial, Park Wayfinding, Walking Trails and Dog Park

Iberville Parish Parks Framework Guide + Park Audit - Iberville Parish, LA

Master Planning, Park Audits, Municipality Partnership, Community Outreach

St. Tammany Parish Sportsplex Master Plan- Slidell, LA

Schematic Master Planning, Multi-Functional Sports Complex, Stakeholder Engagement

Iberville Parish - Belleview Park Master Plans + Renovation - Plaquemine, LA

Park Planning, Community Engagement, Multi-Use Sports Fields, Restroom and Concession Building, Inclusive Playground And Multi-Functional Spaces

Rotary Centennial Plaza - Houma, LA

Pedestrian-Oriented Community Space, Brick Colonnade Matching the Adjacent Historic Architectural Vocabulary with Steel Arches, Concept Planning

Port Fourchon Recreation Coastal Wetlands Park Master Plan - Port Fourchon, LA

Master Planning, Paddle Trails, Walking Trails, Coastal Interpretive Areas and Outdoor Educational Classrooms

Willow + Castille Corridors - Lafayette, LA

Community Outreach Meetings, GIS and Traffic Studies, Multi-Modal Solutions to Reduce Conflicts Between Pedestrians and Increasing Vehicular Traffic

Lafourche Multi-Use Trail Master Plan- Lafourche Parish, LA

Feasibility Study, Master Planning, Health and Economic Report, Design Development, Branding and Wayfinding Signage

Jimmie Davis Bridge Linear Park- Shreveport, LA

Cost- Based Design, Historic and Cultural Preservation, Public Space Design Featuring Greenery, Benches, Bike Lanes, and Art Installations

AVAILABILITY

Throughout duration of Project

CONTACT

O: 225.751.4490

C: 225.938.0259

F: 985.447.7009

E: cdanos@ddgpc.com

EDUCATION

Bachelor of Landscape Architecture,
1990, Louisiana State University

EXPERIENCE

34 Years of Experience

WITH DDG

2011 to Present

CERTIFICATIONS

Registered Landscape Architect

- Texas, #1947

- Alabama, #708

- Louisiana, #D-261

- Mississippi, #505

- Florida, #666959

TEC Professional Services Questionnaire

KEY PERSON, SPECIALIST, OR INDIVIDUAL CONSULTANT:

Name & Title:

Amelia Rusbar, PLA
Senior Project Manager

Project Assignment:

Senior Project Manager

Name of Firm with which associated:

Duplantis Design Group, PC

Years' experience with this firm:

11 Years

Education: Degree(s)/Year/Specialization:

Bachelor of Landscape Architecture, 2012, Louisiana State University

Active registration: Year first registered/discipline:

Licensed in 2018/ Registered Landscape Architect / Landscape Architecture Louisiana, #R-656

Other experience and qualifications relevant to the proposed Project:

John Alario, Jr. Sports Complex - Westwego, LA
Moncus Park Phase II - Lafayette, LA
Iberville Parish Parks Framework Guide + Park Audit - Iberville Parish, LA
Iberville Parish - Belleview Park Master Plans + Renovation - Plaquemine, LA
Rotary Centennial Plaza - Houma, LA
Port Fourchon Recreation Coastal Wetlands Park Master Plan - Lafourche Parish, LA
Willow + Castille Corridors - Lafayette, LA
Center Circle Park Master Plan + Renovation - Sulphur, LA
Nicholls Bayou-side Park Master Plan - Thibodaux, LA
BREC Scottlandville Parkway Park Master Plan and Design - Baton Rouge, LA
Louisiana Statewide Comprehensive Outdoor Recreation Plan (SCORP) 2020 - Statewide, LA
BREC - Howell Community Park - Baton Rouge, LA

AMELIA RUSBAR, PLA

SENIOR PROJECT MANAGER



Amelia grew up in Covington, Louisiana; the only daughter of two landscape architects. She was introduced to the profession at an early age and quickly discovered her passion for designing spaces that bring people together. Joining DDG's Landscape Architecture Division in 2013, Amelia has added a fresh perspective and strong digital design skills to the team. With over ten years of experience, Amelia continues to advance her design skills and honed in on project management. She is always looking for design solutions beneficial to DDG's regional clientele. Armed with AutoCAD, Adobe's Creative Suite, and her tablet, she enjoys creating dramatic and well put together graphics and renderings.

NOTABLE AWARD WINNING DESIGNS

- Louisiana Statewide Comprehensive Outdoor Recreation Plan 2020 (SCORP) - Louisiana Chapter ASLA Merit Award
- Lafourche Parish Multi-use Path Master Plan - Louisiana Chapter ASLA Merit Award

RELEVANT PROJECT EXPERIENCE

John Alario, Jr. Sports Complex - Westwego, LA

Master Planning, Conceptual Design, Stakeholder Engagement, Competitive Sports Fields, Capital Outlay

Moncus Park Phase II - Lafayette, LA

Design and Implementation of Themed And Inclusive Playground, Water Feature, and Treehouse, Community Amphitheater, Veteran's Memorial, Park Wayfinding, Walking Trails And Dog Park

Iberville Parish Parks Framework Guide + Park Audit - Iberville Parish, LA

Master Planning, Park Audits, Municipality Partnership, Community Outreach

Iberville Parish - Belleview Park Master Plans + Renovation - Plaquemine, LA

Park Planning, Community Engagement, Multi-Use Sports Fields, Restroom and Concession Building, Inclusive Playground And Multi-Functional Spaces

Rotary Centennial Plaza - Houma, LA

Pedestrian-Oriented Community Space, Brick Colonnade Matching the Adjacent Historic Architectural Vocabulary with Steel Arches, Concept Planning

Port Fourchon Recreation and Coastal Wetlands Park Master Plan and Design - Lafourche Parish, LA

Master Planning, Paddle Trails, Walking Trails, Coastal Interpretive Areas and Outdoor Educational Classrooms

Willow + Castille Corridors - Lafayette, LA

Community Outreach Meetings, GIS and Traffic Studies, Multi-Modal Solutions to Reduce Conflicts Between Pedestrians and Increasing Vehicular Traffic

Center Circle Park Master Plan + Renovations - Sulphur, LA

Master Planning, Community Outreach, Conceptual Design, 25 Meter Swimming Pool, Bathhouse, Splash Pad, Restroom Building, Playground Enhancements, Re-Organization of the Parking Lot

Nicholls Bayou-Side Park Master Plan - Thibodaux, LA

Master Planning, Park Audits, Municipality Partnership, Community Outreach

AVAILABILITY

Throughout duration of Project

CONTACT

T: 225.751.4490

F: 985.447.7009

E: arusbar@ddgpc.com

EDUCATION

Bachelor of Landscape Architecture,
1990, Louisiana State University

EXPERIENCE

11 Years of Experience

WITH DDG

2013 to Present

CERTIFICATIONS

Registered Landscape Architect
- Louisiana, #R-656

TEC Professional Services Questionnaire

KEY PERSON, SPECIALIST, OR INDIVIDUAL CONSULTANT:
Name & Title:
Michael Petty, PLA Senior Project Manager
Project Assignment:
Senior Project Manager
Name of Firm with which associated:
Duplantis Design Group, PC
Years' experience with this firm:
<1 Year
Education: Degree(s)/Year/Specialization:
Master of Landscape Architecture, 2012, Louisiana State University Bachelor Of Science In Plant Sciences, 2007, University of Tennessee
Active registration: Year first registered/discipline:
Licensed in 2013/ Licensed Landscape Architect / Landscape Architecture Louisiana, #P-259
Other experience and qualifications relevant to the proposed Project:
<p>Lamar Dixon Master Plan Updates + Soccer Complex - Gonzales, LA*</p> <p>Team of Dreams All Abilities Field - Gonzales, LA*</p> <p>East Ascension High School Replacement - Gonzales, LA*</p> <p>LA Park Splash Pad - Donaldsonville, LA*</p> <p>Levee Bike Path Park - St. Gabriel, LA*</p> <p>St. Gabriel Community Center Park and Spray Parks - St. Gabriel, LA*</p> <p>White Castle Spray Park - White Castle, LA*</p> <p>BREC Kathy Drive Park - Baton Rouge, LA*</p> <p>BREC Manchac Park - Baton Rouge, LA*</p> <p> *=Experience prior to DDG</p>

MICHAEL PETTY, PLA
SENIOR PROJECT MANAGER



Michael’s career in landscape architecture and urban planning is a testament to his versatile expertise and leadership. His roles at QES, LLC, Reich Associates, LLC, and the Parish of Ascension Government have showcased his ability to oversee significant projects from inception to completion. His comprehensive ability in project coordination and design execution illustrates his commitment to client satisfaction. With a focus on strategic business development and client relations, Michael has successfully mentored teams, managed budgets, and served as a key coordinator between planning commissions and legislative bodies, ensuring that every project he touches is executed with precision and foresight.

RELEVANT PROJECT EXPERIENCE

Lamar Dixon Master Plan Updates + Soccer Complex - Gonzales, LA*

Team of Dreams All Abilities Field - Gonzales, LA*

East Ascension High School Replacement - Gonzales, LA*

LA Park Splash Pad - Donaldsonville, LA*

Levee Bike Path Park - St. Gabriel, LA*

St. Gabriel Community Center Park and Spray Parks - St. Gabriel, LA*

White Castle Spray Park - White Castle, LA*

BREC Kathy Drive Park - Baton Rouge, LA*

BREC Manchac Park - Baton Rouge, LA*

* = Experience prior to DDG

AVAILABILITY
Throughout duration of Project

CONTACT
T: 225.751.4490
F: 985.447.7009
E: mpetty@ddgpc.com

EDUCATION
Master of Landscape Architecture,
2012, Louisiana State University

Bachelor Of Science In Plant Sciences,
2007, University of Tennessee

EXPERIENCE
27 Years of Experience

WITH DDG
2024 to Present

CERTIFICATIONS
Licensed Landscape Architect
- Louisiana, #P-259

TEC Professional Services Questionnaire

KEY PERSON, SPECIALIST, OR INDIVIDUAL CONSULTANT:

Name & Title:

Mark Gauthier, ASLA, PLA
Senior Project Manager

Project Assignment:

Senior Project Manager

Name of Firm with which associated:

Duplantis Design Group, PC

Years' experience with this firm:

<1 Year

Education: Degree(s)/Year/Specialization:

Bachelor of Landscape Architecture, 1997, Louisiana State University

Active registration: Year first registered/discipline:

Licensed in 2007/ Registered Landscape Architect / Landscape Architecture Louisiana,
#G-244

Other experience and qualifications relevant to the proposed Project:

BREC Central Community Sports Park - Central, LA*
Hilltop Arboretum Education Facility - Baton Rouge, LA*
Henry 'Hank' Aaron Park - Mobile, AL*
Memphis Parks Rehabilitation - Memphis, TN*
AutoZone Minor League Baseball Stadium - Memphis, TN*

*=Experience prior to DDG

MARK GAUTHIER, ASLA, PLA

SENIOR PROJECT MANAGER



Mark is a seasoned Landscape Architect, boasting a robust 27-year career in the field. His expertise encompasses a broad range of services, including site and landscape design, as well as the meticulous preparation of construction documents and plans. Mark’s proficiency extends to overseeing construction administration for a diverse array of projects, such as commercial ventures, office complexes, and production facilities.

His specialized knowledge in land development regulations and landscape codes is particularly noteworthy. Mark excels in the design of commercial sites, with a keen eye for the aesthetic and functional landscaping of parking lot areas. His skills in site grading and storm water management on-site are exemplary, ensuring that commercial developments, regardless of size, benefit from his comprehensive approach to construction planning and environmental sustainability.

AVAILABILITY

Throughout duration of Project

CONTACT

T: 225.751.4490
F: 985.447.7009
E: mgauthier@ddgpc.com

EDUCATION

Bachelor of Landscape Architecture,
1997, Louisiana State University

EXPERIENCE

27 Years of Experience

WITH DDG

2024 to Present

CERTIFICATIONS

Registered Landscape Architect
- Louisiana, #G-244

RELEVANT PROJECT EXPERIENCE

BREC Central Community Sports Park - Central, LA*

Hilltop Arboretum Education Facility - Baton Rouge, LA*

Henry ‘Hank’ Aaron Park - Mobile, AL*

Memphis Parks Rehabilitation - Memphis, TN*

AutoZone Minor League Baseball Stadium - Memphis, TN*

* = Experience prior to DDG

TEC Professional Services Questionnaire

KEY PERSON, SPECIALIST, OR INDIVIDUAL CONSULTANT:

Name & Title:

LeeAnn Fitch, MS, PE, CFM
Water Resources Lead + Associate

Project Assignment:

Water Resources Lead + Associate

Name of Firm with which associated:

Duplantis Design Group, PC

Years' experience with this firm:

7 Years

Education: Degree(s)/Year/Specialization:

Doctor of Philosophy Civil and Environmental Engineering, Louisiana State University, Course Completion
MS, Coastal and Ecological Engineering, 2016 Louisiana State University
BS, Environmental Engineering, 2014 Louisiana State University

Active registration: Year first registered/discipline:

Licensed in 2019/ Licensed Professional Engineer/ Civil Engineering #44323

Other experience and qualifications relevant to the proposed Project:

Moncus Park Drainage Impact Study - Lafayette, LA
W-14 Improvements & Fritchie Marsh Hydrologic Restoration - St. Tammany Parish, LA
Abita Nursery Regional Drainage Study - St. Tammany Parish, LA
Lower W-15 Basin Drainage Improvements - St. Tammany Parish, LA
Drainage and Coastal Protection Plan - St. Tammany Parish, LA
Bayou Bonfouca Marsh Creation (Po-0104) - Slidell, LA
Barringer Drive Drainage Improvements - Ponchatoula, LA
Southwest Ponchatoula Drainage Study - Ponchatoula, LA
D-Man Fallout and Webb Coulee Flood Study - Lafayette Parish, LA
W-11 and W-29 Canals Flood Study - Lafayette Parish, LA
Morganfield Development Master Drainage Plan - Lake Charles, LA
Rienzi and Coulon Canals Modeling Study - Lafourche Parish, LA
Grand Canard Mitigation Bank Hydrologic Study - Jefferson Davis Parish, LA
Lake Borgne Marsh Creation - St. Bernard Parish, LA

LEEANN FITCH, MS, PE, CFM

WATER RESOURCES LEAD + ASSOCIATE



LeeAnn has pioneered DDG's water resources services over the last 7 years. She is a licensed professional engineer in the State of Louisiana, Certified Floodplain Manager, and has been a member of ASCE Coast, Oceans, Ports and Rivers Institute (COPRI), Louisiana Floodplain Management Association (LFMA), and Louisiana Water Environment Association (LWEA), and serves as commissioner for the Amite River Basin Drainage and Conservation District. At DDG, she continually expands DDG's expertise in hydrodynamic software, mapping procedures, and data analysis. LeeAnn is a leader and mentor within our firm and continues to exert her passion for reducing flood risk through higher standards and regional improvement solutions throughout the state. She has extensive experience with 1D/2D hydrodynamic models including USACE's HEC-suite, EPA's SWMM / CHI's PCSWMM and DHI's MIKE. She has utilized these models to evaluate existing drainage conditions, conduct flood mapping, and develop solutions to identify and reduce the risk of flooding to communities. She has conducted and led efforts involving in situ monitoring and various data collection methods, master planning, design, permitting, and construction administration.

AVAILABILITY

Throughout duration of Project

CONTACT

T: 225.751.4490

F: 985.447.7009

E: lfitch@ddgpc.com

EDUCATION

M.S. Coastal and Ecological Engineering, 2016, Louisiana State University

B.S. Environmental Engineering, 2014, Louisiana State University

Doctorate of Philosophy Civil and Environmental Engineering, Louisiana State University, Course Completion

EXPERIENCE

7+ Years of Experience

WITH DDG

2017 to Present

CERTIFICATIONS

Licensed Professional Engineering, LA #44323

Certified Floodplain Manager (CFM)

RELEVANT PROJECT EXPERIENCE

Moncus Park Drainage Impact Study - Lafayette, LA

HEC-RAS 1D Model, No-Rise Analysis for Moncus Park Bark Park Fence Development in Coulee Mine FEMA Regulatory Floodway

W-14 Basin Drainage Improvements + Fritchie Marsh Hydrologic Restoration - St. Tammany Parish, LA

Engineering Design, Modeling, Canal Widening, Flood Reduction

Abita Nursery Regional Drainage Study - St. Tammany Parish, LA

1D/2D SWMM Model to Evaluate Existing Drainage Evaluation, Flood Reduction

Lower W-15 Basin Drainage Improvements - St. Tammany Parish, LA

Drainage Improvements, Canal Widening, Permitting, Bid Documents, Construction of 324 Ac-Ft. Detention Pond

Drainage and Coastal Protection Plan - St. Tammany Parish, LA

Drainage + Coastal Protection Plan, Modeling Assessment, Funding Sources

Bayou Bonfouca Marsh Creation - Slidell, LA

591-Acre of Marsh Creation, Project Grant Management, Permitting + Entitlements, Shoreline Protection, Construction Administration

Barringer Drive Drainage Improvements - Ponchatoula, LA

Expand Phase 1 Existing Model to Include Additional Drainage Areas, Identify Existing Drainage Capacities Downstream, Expanding and Updating Phase 1 PCSWMM model

Southwest Ponchatoula Drainage Study - Ponchatoula, LA

Evaluation of Regional Drainage Conditions to Create a Mitigation Strategy and Alleviate Drainage Issues, HEC-HMS model, HEC-RAS 2D rain on grid model

D-Man Fallout and Webb Coulee Flood Study - Lafayette Parish, LA

HEC-HMS + HEC-RAS Model, Hydrologic Survey, Improved D-Man Outfall Conveyance

W-11 and W-29 Canals Flood Study - Lafayette Parish, LA

HEC-HMS and 1D/2D HEC-RAS Model, Flood Reduction, Improved Conveyance, Flood Wall

Morganfield Development Master Drainage Plan - Lake Charles, LA

Master Drainage Plan for a 1200-Acre Development, HEC-RAS Model, Hydraflow

TEC Professional Services Questionnaire

KEY PERSON, SPECIALIST, OR INDIVIDUAL CONSULTANT:
Name & Title:
Bryan Olinger Environmental + Regulatory Lead
Project Assignment:
Environmental + Regulatory Lead
Name of Firm with which associated:
Duplantis Design Group, PC
Years' experience with this firm:
1 Year
Education: Degree(s)/Year/Specialization:
Bachelor of Science in Resource Biology + Biodiversity, 2012, University of Louisiana Lafayette
Active registration: Year first registered/discipline:
N/A
Other experience and qualifications relevant to the proposed Project:
<p>Houma Heights Park Master Plan - Houma, LA</p> <p>Bayou Bonfouca Detention Pond - St. Tammany Parish, LA</p> <p>Bayou Boyle Detention Pond - Ascension Parish, LA</p> <p>Cypress Bayou Green Infrastructure Project - Parish of East Baton Rouge, LA</p> <p>Louisiana Mitigation Bank - LA</p> <p>Bayou Terrebonne Biodiversity + Resiliency CSR Projects*</p> <p>*=Experience prior to DDG</p>

BRYAN OLINGER

ENVIRONMENTAL + REGULATORY LEAD



Bryan is a project manager and environmental biologist with over 12 years of experience in environmental permitting in the public and private sectors, and a background in academic research. He has experience in both data gathering and permitting of long, linear projects in the energy sector, and has expertise in all facets of mitigation bank and PRM project development and implementation. He has worked on over 50,000 acres in multiple states performing wetland delineations, overseeing planting operations, monitoring native and invasive species, and managing forested, coastal prairie, grasslands, and long-leaf pine savanna habitats and reporting on their status'. In the alternative energy sector, he has experience creating vegetation management plans for post-construction reclamation of native grassland vegetation and habitats.

AREAS OF EXPERTISE

- Wetland Delineations
 - USACE Sec. 404/10 Permitting
 - Wildlife + Habitat Management
- Ecology + Ecosystems of the Gulf South
 - Wetland Mitigation Project Design
 - Wetland Policy + Management

RELEVANT PROJECT EXPERIENCE

Houma Heights Park Master Plan - Houma, LA

Master Planning, Community + Stakeholder Engagement, Data Collection, Local, State, and Federal Permitting, Addressed Local and Residential Concerns/Park Safety

Bayou Bonfouca Detention Pond - St. Tammany Parish, LA

Data Collection, Reporting, Permitting (Local, State, and Federal), Detention Pond Design to Reduce Flood Risks

Bayou Boyle Detention Pond - Ascension Parish, LA

Data Collection, Reporting, Permitting (Local, State, and Federal), Detention Pond Design to Reduce Flood Risks

Cypress Bayou Green Infrastructure Project - Parish of East Baton Rouge, LA

Improvements in the Greenwood Community Park, Hooper Road Park, and Comite River Park, Field Studies, Environmental Permitting

Louisiana Mitigation Bank - LA

Acquisition, Permitting, Design, Implementation, Management, Field Operations and/or Long-Term Stewardship and Maintenance of the Following Mitigation Banks, PRM Sites and CSR Project Sites with Varying Habitat Types and Regulatory Requirements

Bayou Terrebonne Biodiversity + Resiliency CSR Projects*

Planting of 31,000 Bald-Cypress Trees, Permitting, Designing, Monitoring and Maintenance of 9,000 Linear Feet of Earthen Terrace within a 50-Acre Project Foot Print

*=Experience prior to DDG

AVAILABILITY

Throughout duration of Project

CONTACT

T: 337.233.9914

F: 985.447.7009

E: bolinger@ddgpc.com

EDUCATION

B.S. Resource Biology + Biodiversity, 2012, University of Louisiana Lafayette

EXPERIENCE

12+ Years of Experience

WITH DDG

2023 to Present

CERTIFICATIONS

Burn Manager

Wetland Delineator

TEC Professional Services Questionnaire

KEY PERSON, SPECIALIST, OR INDIVIDUAL CONSULTANT:

Name & Title:

Scott Tabary, PE
New Orleans Civil Engineering Lead + Partner

Project Assignment:

Civil Engineering Lead

Name of Firm with which associated:

Duplantis Design Group, PC

Years' experience with this firm:

14 Years

Education: Degree(s)/Year/Specialization:

Bachelor of Science in Civil Engineering, 2010 - Louisiana State University

Active registration: Year first registered/discipline:

Licensed in 2016/ Licensed Professional Engineer/ Civil Engineering #40541

Other experience and qualifications relevant to the proposed Project:

Elmwood Shopping Center Revitalization Project - New Orleans, LA

Fremaux Towncenter Master Plan + Development - Slidell, LA

Ochsner Medical Complex The Grove - Baton Rouge, LA

The Blake Assisted Living - Multiple Locations

Riverchase Master Plan and Development - Covington, LA

Hollywood Drainage Improvements - Terrebonne Parish, LA

Lakeshore Villages (Dog park included) - Slidell, LA

Meadowlake Subdivision Pond Improvements - Slidell, LA

ER Clinics - Multiple Clients - New Orleans, LA

SCOTT TABARY, PE

NEW ORLEANS CIVIL ENGINEERING LEAD + PARTNER



Scott leads DDG's civil engineering team in our New Orleans branch office. Born and raised in the New Orleans area, Scott attended Brother Martin High School prior to attending LSU for his civil engineering degree. Scott joined the DDG Covington team in 2011 and quickly exemplified his expertise in hydrology and hydraulics, as well as his client and project management skills. Those attributes, among others, allowed Scott to obtain a leadership position within DDG and is now running the firm's New Orleans office. Scott is currently licensed in Louisiana and Florida. He has experience working on and overseeing projects as well as in preparing site, grading, utility, erosion control, and stormwater quantity and quality plans (including H&H calculations). Scott's experience working on projects spans through the entire project cycle from conceptual site and master planning to re-zoning, annexation, plan production, permitting, and construction observation.

RELEVANT PROJECT EXPERIENCE

Ochsner Medical Complex The Grove - Baton Rouge, LA

- Private Onsite Parking Lot Design
- Public Roadway Extension of Grove Blvd.
- Public Sanitary Sewer Improvements including new lift station, force main, and gravity sewer design
- Private Onsite Parking Lot Design

The Blake Assisted Living - Multiple Locations

Developed Stormwater Quality and Detentions for All Sites. Overall Drainage Models were Prepared and Modified for Colonial Club, Miramar Beach, and Panama City to Help Determine that the Projects would have Minimal Effect to Adjacent Properties.

Elmwood Shopping Center Revitalization Project - New Orleans, LA

Assisted with Drainage. Installing Green Infrastructure to Capture Stormwater Runoff for Collection, Filtration, and Urban Heat Island Reduction. Revitalizing Permeable Parking, Walking Paths, Outdoor Recreation Opportunities, and Multi-Use Facilities.

Fremaux Towncenter Master Plan + Development - Slidell, LA

Master Planning of a 350-Acre Site, Construction Documents, Drainage Design, and Utility Infrastructure.

Riverchase Master Plan and Development - Covington, LA

Master Planning, Construction Documents, Drainage Design, Road Design, and Utility Infrastructure.

Hollywood Drainage Improvements- Terrebonne Parish, LA

Analyzed Existing Stormwater System to Determine Existing Drainage Issues. Analyzed and Designed Proposed Drainage Improvements.

Lakeshore Villages (Dog park included) - Slidell, LA

Grading, Storm Drainage, Sewer, Water, and Roadways. Provided Hydraulic Modeling Services, and Proposed Conditions to Help Inform Master Planning.

Meadowlake Subdivision Pond Improvements- Slidell, LA

ER Clinics - Multiple Clients - New Orleans, LA

AVAILABILITY

Throughout duration of Project

CONTACT

T: 504.434.6565

F: 985.447.7009

E: stabary@ddgpc.com

EDUCATION

Bachelor of Science in Civil Engineering, 2010, Louisiana State University

EXPERIENCE

14 Years of Experience

WITH DDG

2011 to Present

CERTIFICATIONS

Licensed Professional Engineering, LA #40541

TEC Professional Services Questionnaire

KEY PERSON, SPECIALIST, OR INDIVIDUAL CONSULTANT:
Name & Title:
Ashley N. Webre, AIA Senior Project Manager + Associate
Project Assignment:
Architecture Lead
Name of Firm with which associated:
Duplantis Design Group, PC
Years' experience with this firm:
11 Years
Education: Degree(s)/Year/Specialization:
Bachelor of Architecture, 2014, Louisiana State University
Active registration: Year first registered/discipline:
Licensed in 2022 / Licensed Architect / Architecture #9674
Other experience and qualifications relevant to the proposed Project:
John Alario, Jr. Sports Complex - Westwego, LA Center Circle Park Design Services - Sulphur, LA Lafourche Community Center - Lockport, LA Nicholls State University Coastal Center Facility - Thibodaux, LA Nicholls State University John Folse Culinary Institute - Thibodaux, LA Bayou Community Academy New Campus - Thibodaux, LA Nicholls State University 25 Year Campus Master Plan - Thibodaux, LA Mandeville Elementary School Classroom Addition - Mandeville, LA River Parishes Community College - PTEC Building - Gonzales, LA Terrebonne Port Commission Multi-Use Facility- Terrebonne Parish, LA St. John Senior Center - Edgard, LA Nicholls State University Greenhouse Renovations - Phase 1 - Thibodaux, LA

ASHLEY N. WEBRE, AIA

SENIOR PROJECT MANAGER + ASSOCIATE



Ashley has added a fresh perspective and strong digital design skills to DDG's Architecture team. Beginning with a heavy concentration in retail design and development, Ashley has broadened her skills and honed in on project management since joining DDG in 2013. She has since worked on historical renovations, private offices, public institutions, and educational facilities, ranging in size and complexity. She is always motivated to advance her skills in architectural design and construction. Ashley provides innovative design solutions and building systems that is beneficial to regional clientele.

AREAS OF EXPERTISE

- Project Management
- Construction Administration
- Public / Private Relationships
- Strategic Planning
- Community Outreach

RELEVANT PROJECT EXPERIENCE

John Alario, Jr. Sports Complex - Westwego, LA

Master Planning, Conceptual Design, Stakeholder Engagement, Competitive Sports Fields, Capital Outlay

Center Circle Park Design Services - Sulphur, LA

Comprehensive Park Master Plan, Design Development of a Community Center, 25-Meter Swimming Pool, Bathhouse, Splash Pad, Restroom Building, Playground Enhancements, Parking Lot Re-Organization

Lafourche Community Center - Lockport, LA

Community Outreach, Outdoor Gathering Space, Multi-Use Space

Nicholls State University Coastal Center Facility - Thibodaux, LA

New Two-Story Building, Collaborative Spaces, Public Meeting Rooms, Office, Classroom Space, Flex + Web Research Labs with Support Space

Nicholls State University John Folse Culinary Institute - Thibodaux, LA

Full-Service Kitchen, Bistro-Style Restaurant, Cultural Research Center, Offices, Classrooms, Teaching Kitchen, Visitor Parking

Bayou Community Academy New Campus - Thibodaux, LA

Schematic Design for the 60,072 SF Facility which Includes 20 Classrooms, Cafetorium, Pemb Gymnasium, Administration Wing, Library, Computer Labs

Nicholls State University 25 Year Campus Master Plan - Thibodaux, LA

Wayfinding, Community Outreach, Master Planning

Mandeville Elementary School Classroom Addition

New Classroom Building, Teacher's Lounge, Restrooms, Site Work

River Parishes Community College - PTEC Building

New Classroom Building, Shop Area, Restrooms, Multipurpose Space, Testing Center, Administration Offices

Terrebonne Port Commission Multi-Use Facility

Multi-Use space, Offices, Capital Outlay / Grant Funding, Interpretive Design

St. John Senior Center

Multi-Purpose Space, Restrooms, Outdoor Seating and Gardens, Site Improvements

AVAILABILITY

Throughout duration of Project

CONTACT

T: 985.447.0090

F: 985.447.7009

E: awebre@ddgpc.com

EDUCATION

Bachelor of Architecture, 2014,
Louisiana State University

EXPERIENCE

10+ Years of Experience

WITH DDG

2013 to Present

CERTIFICATIONS

Licensed Architect, LA #9674

TEC Professional Services Questionnaire

KEY PERSON, SPECIALIST, OR INDIVIDUAL CONSULTANT:
Name & Title:
Cory MacMenamin, PLS Vice President of Survey + Partner
Project Assignment:
Survey Lead
Name of Firm with which associated:
Duplantis Design Group, PC
Years' experience with this firm:
5 Years
Education: Degree(s)/Year/Specialization:
Survey + Mapping, 2020, University of Wyoming Bachelors in Business Management, 2019, Southeastern University Associates in Land Surveying, 2008, Community College of Southern Nevada
Active registration: Year first registered/discipline:
Licensed in 2021/ Professional Land Surveyor/ Land Surveying #5269
Other experience and qualifications relevant to the proposed Project:
<p>Moncus Park Phase II - Lafayette, LA</p> <p>Parc Sans Souci Playground - Lafayette, LA</p> <p>Rotary Centennial Plaza - Houma, LA</p> <p>Amazon Distribution Center - Slidell, LA</p> <p>Fremaux Town Center - Slidell, LA</p> <p>Lakeshore Village Subdivision (Phase 6, 9-11) - Slidell, LA</p> <p>South Alabama Logistics Park - Theodore, AL</p> <p>Broussard Main Street - Broussard, LA</p> <p>LA 22 Pine Street Pedestrian Improvements - Ponchatoula, LA</p> <p>Belfleur Road Extension - Rouzan Residential Development - Baton Rouge, LA</p> <p>Lafourche Consolidated Government Drainage Initiative - Lafayette Parish, LA</p> <p>St. Martin Parish Drainage Improvements - St. Martin Parish, LA</p> <p>FTA Program - Ponchatoula Pedestrian Improvements - Tangipahoa Parish, LA</p>

CORY MACMENAMIN, PLS

SURVEY LEAD



The DDG Surveying Division is managed from DDG's Covington office by Cory MacMenamin. Having surveyed with his father since he was a boy, he has experienced many different facets of the industry, and he appreciates the historical significance of the survey profession and the challenges it faces as technological advancements shape its future. He has performed many different types of surveys ranging across multiple states and specialties. He has also worked on master planning, industrial, commercial, and residential projects throughout the state of Louisiana as well as projects in Mississippi, Alabama, Florida and Nevada.

AREAS OF EXPERTISE

- Topographic Surveying
- Hydrographic Surveys
- Drone Licensed Pilot

RELEVANT PROJECT EXPERIENCE

Moncus Park Phase II - Lafayette, LA

Design and Implementation of Themed and Inclusive Playground, Water Feature, and Treehouse, Community Amphitheater, Veteran's Memorial, Park Wayfinding, Walking Trails and Dog Park

Parc Sans Souci Playground - Lafayette, LA

Planning and Design of a Children's Playground Activity Hub for the Highly Successful Downtown Park which is Directly Adjacent to the Vermilion Street Corridor

Rotary Centennial Plaza - Houma, LA

Topographic, Boundary, and Underground Utilities Surveys of the Subject Properties and Right of Way for Public Streets

Amazon Distribution Center - Slidell, LA

150,000 SF Building, Parking and Vehicle Storage on the 31 Acre Site, Topographic, Tree, and Boundary Survey, Right of Way Maps for the Roundabout to be Dedicated to the City of Slidell

Fremaux Town Center - Slidell, LA

350-Acre Site Development, Master Planning, Construction Documents, Drainage Design, and Utility Infrastructure for the Design of Retail Stores, Restaurants, Outparcels, Tech Park, Apartment Sites, Medical Offices, Commercial Offices, Single and Multifamily Residents

Lakeshore Village Subdivision (Phase 6, 9-11) - Slidell, LA

Design Services for All Eleven Phases Including a Dog Park, Grading, Storm Drainage, Sewer, Water, and Roadways, 1,113-Acre Mixed-Use Development

South Alabama Logistics Park - Theodore, AL

300-Acre Master-Planned Industrial Park, Development of Approximately 500 Acres and 6.7 Million Square Feet of Buildings, Survey Support for Phase 1 Utilizing Drone and Traditional Surveying.

Broussard Main Street - Broussard, LA

Master Planning to Re-Develop the Downtown District, DOTD Right Sizing Program, Street and Pathway Lighting, Major Drainage Crossing

LA 22 Pine Street Pedestrian Improvements - Ponchatoula, LA

Existing Roadway and Pedestrian Walkway Alignments Alterations, Pedestrian Experience Enhancements, Enhance Existing Sidewalks to Comply with Contemporary Accessibility Standards

AVAILABILITY

Throughout duration of Project

CONTACT

T: 985.249.6180

F: 985.447.7009

E: cmacmenamin@ddgpc.com

EDUCATION

Associates in Land Surveying,
Community College of Southern
Nevada, 2008

Bachelor of Science in Business
Louisiana State University, 2019

Survey + Mapping, University of
Wyoming, 2020

EXPERIENCE

25+ Years of Experience

WITH DDG

2019 to Present

CERTIFICATIONS

Professional Land Surveyor
- Louisiana, #5269

Drone Pilot

TEC Professional Services Questionnaire

K. List the professional in charge, key persons, specialists, and individual consultants anticipated for this Project and provide their relevant information below. If necessary, please attach additional documentation (i.e. resume) that demonstrates the employment history and experience of the Firm's key persons that may assist in the completion of this Project. Please attach additional pages if necessary.

KEY PERSON, SPECIALIST, OR INDIVIDUAL CONSULTANT:

Name & Title:

Joseph Guillory, PE
Vice President of Specialty Services + Principal-in-Charge

Project Assignment:

Professional in Charge of Project

Name of Firm with which associated:

Duplantis Design Group, PC

Years' experience with this firm:

11 Years

Education: Degree(s)/Year/Specialization:

Bachelor of Civil Engineering, 2010, University of New Orleans

Active registration: Year first registered/discipline:

Licensed in 2016/ Licensed Professional Engineer / Civil Engineering #41131

Other experience and qualifications relevant to the proposed Project:

W-14 Basin Drainage Improvements + Fritchie Marsh Hydrologic Restoration - St. Tammany Parish, LA
Lake Borgne Marsh Creation - St. Bernard Parish, LA
Bayou Bonfouca Marsh Creation - Slidell, LA
Lower W-15 Drainage Improvements - St. Tammany Parish, LA
Program Management OCD/CDBG Drainage Project - St. Tammany Parish, LA
Watershed Management Study - St. Tammany Parish, LA
Coastal Management Assistance - St. Tammany Parish, LA

JOSEPH GUILLORY, PE

VICE PRESIDENT OF SPECIALTY SERVICES + PARTNER



Joe has lead our coastal division to exponential growth. Currently, he and his team are designing and managing the construction of the largest marsh creation project, Lake Borgne, implemented by CPRA to date. As a civil and coastal engineer, Joe brings a technical yet practical approach to Louisiana's coastal challenges – land loss, sea level rise, subsidence, storm surge, water management, and erosion. He began his engineering career working for CPRA where he supported the design of thousands of acres of marsh creation. He has helped analyze and develop sound approaches to water management through his involvement with operation plans for Mississippi River diversions as well as his support of the State's 2012 Coastal Master Plan. His understanding and familiarity with Louisiana's coast ensures that his design concepts will work with the natural processes that shape our coast.

AREAS OF EXPERTISE

- Program + Project Management
- Coastal Engineering + Restoration
- Marsh Creation
- Hydrologic Restoration
- Alternative Funding Sources
- Freshwater Diversion
- Benefit Cost Analysis
- Grant Management

RELEVANT PROJECT EXPERIENCE

W-14 Basin Drainage Improvements + Fritchie Marsh Hydrologic Restoration - St. Tammany Parish, LA

Engineering Design, Modeling, Canal Widening, Flood Reduction

Lake Borgne Marsh Creation - St. Bernard Parish, LA

Engineering and Design Services, 3,703 Acres of Marsh Creation

Bayou Bonfouca Marsh Creation - Slidell, LA

591-Acre of Marsh Creation, Project Grant Management, Permitting + Entitlements, Shoreline Protection, Construction Administration

Lower W-15 Drainage Improvements - St. Tammany Parish, LA

Design, Permitting, Preparation of Bid Documents, Construction Inspection, Drainage Improvements Include Widening of the Lower W-15 Canal And Construction of a 324 Ac-Ft Detention Pond.

Program Management OCD/CDBG Drainage Project - St. Tammany Parish, LA

Prepared Exhibits, Wetlands Permitting, Construction Administration, FEMA Documentation

Watershed Management Study - St. Tammany Parish, LA

Water Quality Samples Collection for Dissolved Oxygen Monitoring, Prepared GIS Files of All Waterways and Drainage Basins for St. Tammany Parish, Conceptual Design and Cost Estimation of Water Quality Ponds and Regional Detention Ponds

Coastal Management Assistance - St. Tammany Parish, LA

Coastal Management and Planning, Identification of Areas That are in Need of Protection or Restoration, Identify and Secure Funding Sources for Various Coastal Projects. Map Preparation, and Project Cost Estimates.

AVAILABILITY

Throughout duration of Project

CONTACT

T: 985.249.6180

F: 985.447.7009

E: jguillory@ddgpc.com

EDUCATION

B.S. Civil Engineering, 2010,
University of New Orleans

EXPERIENCE

10+ Years of Experience
Licensed in 2016

WITH DDG

2013 to Present

CERTIFICATIONS

Professional Engineer
- Louisiana, #41131

TEC Professional Services Questionnaire

L. Work by Firm or Joint-Venture members which best illustrates current qualifications relevant to this Project. Please include any and all work performed for the Lafitte Area Independent Levee District (LAILD). Please attach additional pages if necessary.

PROJECT NO. 1

Project Name, Location and Owner's contact information:

JOHN ALARIO JR. SPORTS COMPLEX

Westwego, LA

Louisiana Stadium + Exposition District (LSED)

Eileen Long

P.O. Box 52439, New Orleans, LA 70152

(504) 587-3920

Nature of Firm's Responsibility:

DDG is working with the Louisiana Stadium and Exposition District (LSED) to develop Phase 1 of The John Alario, Jr. Sports Complex in Westwego, LA. The \$20.6 million project will be a state, and regional sports facility catering to recreational and youth sports travel teams and tournaments. It is anticipated to be an economic driver for the region. The project, at completion, is to encompass approximately 94 acres.

The project included significant offsite public drainage and infrastructure improvements which were funded by a cooperative endeavor agreement with the local jurisdiction. DDG provided preparation of design drawings, bid documents, cost estimates. The DDG team will provide construction administration support services for the client by performing SWPPP site observations, milestone site visits, and a construction punch list observation. Additionally, DDG prepared Wetland Data Reports per U.S. Army Corps of Engineers guidelines, required for a Jurisdictional Determination of Section 404 wetlands and Waters of the U.S. Data presented in the report include topographic, true-color aerial imagery, LiDAR, aerial infrared, Web Soil Survey, and wetland boundary maps created with ArcGIS.



Completion Date
(Actual or Estimated):

Estimated Cost:

Entire Project:

Work for which
Firm was Responsible:

Construction began: June 2023
Est. Completion Date: July 2024

\$20.6 Million

\$1.2 Million

TEC Professional Services Questionnaire

PROJECT NO. 2

Project Name, Location and Owner's contact information:

MONCUS PARK

Lafayette, LA

Lafayette Central Park

JP MacFadyen

2901 Johnson St., Lafayette, LA

(337) 500-1177



Nature of Firm's Responsibility:

DDG led the design and construction for Phase II of Moncus Park located in the heart of Lafayette, LA. This phase includes an amphitheater and performance stage, an Acadiana Nature Play Area, a water feature, a tree house, Veterans Memorial, walking trails, a dog park, and overall site improvements. Our landscape architecture team led the effort on these improvements with support from surveying, architecture, and civil engineering for the 100+ acre park. The project was completed in July 2022 with construction costs totaling \$4.8 million.

The Moncus Park playground is a South Louisiana "Acadian Swamp" inspired playground. The themed playground showcases a playful rustic look with a "swamp shack" environment which incorporates the feel throughout all the elements designed for the playground area. The main inclusive play structure was designed to be accommodating for all ages with disabilities from ground level play to inside the structure itself. Other Louisiana plays pieces include naturalistic crawl through logs and log steppers and a custom-made alligator in the swamp. We also included musical play pieces for the auditory sensory aspect of the playground. The play surface was designed to mimic a Louisiana swamp.

For the Veteran's Memorial, DDG's team heavily collaborated with Veterans' groups and Moncus Park members for input and refinement on design ideas to make sure our team created a space they could be proud of that properly commemorated our local heroes. DDG coordinated with community vendors and artisans to assist in the production of custom cast 8' tall monuments, custom cast 60' long benches, and all the custom metal work within the memorial. Our team collaborated with historians to ensure the language on the monuments was historically accurate and consistent across all designed pieces.



Completion Date
(Actual or Estimated):

Phase 2: July 2022
Additional phases: Ongoing

Estimated Cost:

Entire Project:

\$4.8 Million (Construction)

Work for which
Firm was Responsible:

\$750,000

TEC Professional Services Questionnaire

PROJECT NO. 3		
Project Name, Location and Owner's contact information:	Nature of Firm's Responsibility:	
<p>IBERVILLE PARISH PARKS FRAMEWORK GUIDE + PARK AUDIT</p> <p>Iberville Parish, LA</p> <p>Iberville Parish Government Randall Dunn, CFO 23405 Church Street Plaquemine, LA 70764 (225) 687-5190</p>	<p>The Iberville Parish Council engaged DDG to evaluate the state of the Iberville Parks and Recreation District (IPRD), conduct meetings for public feedback, and form recommendations for system-wide improvements. Community outreach included a two-tiered approach of municipal town hall meetings and a public survey disseminated throughout the Parish. With cooperation from each Mayor, DDG facilitated 38 public park audit and assessments, and interactive exercises to establish community values around recreation and build consensus around needs and budget constraints.</p> <p>Evaluations determined community needs, safety issues, and accessibility shortfalls with a systematic method of addressing these concerns. A reorganization of the operations and management of the Park system was developed with a recommendation to focus investments to elevate the benchmark of excellence for Parish parks.</p> <p><i>Iberville Parks & Recreation Framework Guide won the 2018 Louisiana Chapter ASLA Merit Award.</i></p> 	
Completion Date (Actual or Estimated):	Estimated Cost:	
	Entire Project:	Work for which Firm was Responsible:
Professional Services Completed: 2017	N/A - Master Planning Only	\$122,000

TEC Professional Services Questionnaire

PROJECT NO. 4

Project Name, Location and
Owner's contact information:

ST. TAMMANY PARISH SPORTSPLEX MASTER PLAN

Slidell, LA

St. Tammany Parish Development District

Keith Espadron
21489 Koop Drive #7
Madeville, LA 70471
(985)409-7847



Nature of Firm's Responsibility:

The master plan was for a proposed sports complex in East St. Tammany Parish, Louisiana, that aimed to capitalize on the youth sports tourism industry and provide a family-friendly destination for residents and visitors. It's initial objective was to develop a multi-functional sports complex that would generate revenue from a \$35 million investment and position the facility's maintenance and operations to have a positive economic impact. DDG developed site selection criteria that would guide the choice of an ideal location for the complex.

The master plan presented a performance matrix that illustrate the expected range of revenue and expenses for the complex based on industry benchmarks and real-world operations. A schematic master plan incorporating various features and amenities to create a unique and flexible sports experience was included.

The economic impact and program of the complex would have a significant economic impact on the region, attracting over 100,000 out-of-town visitors, generating over \$21 million in direct spending, and supporting over 125 jobs in year 3. The document also outlines the program for the project, which includes a kickoff meeting, stakeholder feedback, and a final master plan delivery.



Completion Date
(Actual or Estimated):

Expected Completion: xxx

Estimated Cost:

Entire Project:

N/A- Master Planning Only

Work for which
Firm was Responsible:

\$31,000

TEC Professional Services Questionnaire

PROJECT NO. 5						
Project Name, Location and Owner's contact information:		Nature of Firm's Responsibility:				
<p>BELLEVIEW PARK MASTER PLAN + RENOVATIONS</p> <p>Plaquemine, LA</p> <p>Iberville Parish Government J. Mitchell J. Ourso, Jr. P.O. Box 389, Plaquemine, LA (225) 687-5186</p>		<p>DDG was retained to conduct a comprehensive Parish-wide audit of all parks within the Iberville Parish park system. Evaluations determined community needs, safety issues, and accessibility shortfalls with a systematic method of addressing these concerns. A reorganization of the operations and management of the Park system was developed with a recommendation to focus investments to elevate the benchmark of excellence for Parish parks. In response to the report findings and prescribed improvements, a visionary master plan was crafted for Belleview Park's future. DDG's landscape architecture team led the renovations of the 16 acre park that includes two new multi-functional synthetic turf fields to serve all athletic sporting events, a restroom/concession building, new picnic shelters, a new synthetic turf sports field, a drop-off area, pedestrian walks, relocation of play equipment and installation of new equipment, wayfinding, and resurfacing of existing tennis courts in the park. DDG's team will assist with bidding, negotiation, and permitting and once the construction begins, DDG provided construction administration services.</p>				
		 				
Completion Date (Actual or Estimated):		Estimated Cost:				
		<table border="1"> <tr> <td>Entire Project:</td> <td>Work for which Firm was Responsible:</td> </tr> <tr> <td>\$8,000,000</td> <td>\$281,000</td> </tr> </table>	Entire Project:	Work for which Firm was Responsible:	\$8,000,000	\$281,000
Entire Project:	Work for which Firm was Responsible:					
\$8,000,000	\$281,000					
Project Completed: March 2023 (Actual)						

TEC Professional Services Questionnaire

PROJECT NO. 6						
Project Name, Location and Owner's contact information:		Nature of Firm's Responsibility:				
<p>ROTARY CENTENNIAL PLAZA</p> <p>Houma, LA</p> <p>Terrebonne Parish Consolidated Government Christopher Pulaski 8026 W Main St #101 Houma, LA 70360 (985) 873-6569</p>		<p>Located in Downtown Houma along Belanger street, this project has transformed a public street into a pedestrian-oriented community space open to merchants, festivals, and downtown events. The Rotary Club of Houma commemorated 100 years of community service and contributed to the project as a centennial celebration and gift to the community. DDG assisted Terrebonne Parish Consolidated Government (TPCG) and the Rotary Club of Houma with the development of a downtown parklet concept. An accurate survey of topographic, boundary, and underground utilities prepared by DDG's Survey team was paramount in ensuring that the proposed improvements would co-exist within a historic street with numerous infrastructure adaptations over the years. Our landscape architects, then created a concept of accentuating the ground plane with etched gears, reminiscent of the logo of the Rotary Club and the gears of the classical industrial machinery. To encompass an overhead element to create a sense of place, DDG designed a brick colonnade matching the adjacent historic architectural vocabulary with steel arches spanning across the width of the street with festoon lights strung between the arches to create a special ambiance.</p>				
						
Completion Date (Actual or Estimated):		Estimated Cost:				
		<table border="1"> <tr> <td>Entire Project:</td> <td>Work for which Firm was Responsible:</td> </tr> <tr> <td>\$1,390,000</td> <td>\$204,000</td> </tr> </table>	Entire Project:	Work for which Firm was Responsible:	\$1,390,000	\$204,000
Entire Project:	Work for which Firm was Responsible:					
\$1,390,000	\$204,000					
Project Completed: 2024 (Actual)						

TEC Professional Services Questionnaire

PROJECT NO. 7

Project Name, Location and Owner's contact information:

PORT FOURCHON COASTAL WETLANDS PARK MASTER PLAN

Port Fourchon, LA

Greater Lafourche Port Fourchon
Chett Chiasson, MPA
Executive Director
16829 East Main Street
Cut Off, LA 70345
chettc@portfourchon.com



Nature of Firm's Responsibility:

DDG developed a comprehensive master plan for a 43-acre recreational and wetlands park for the Greater Lafourche Port Commission (GLPC). The master plan envisions a functional ecosystem that can be utilized as a recreational and educational asset to the community. Amenities include a one mile tidal creek to allow for a viable marsh estuary and will permit paddling activities with an adjacent walking trail and boardwalk system to allow visitors recreational opportunities and tourist a chance to immerse oneself in the middle of a coastal marsh estuary. The mitigated coastal marsh estuary system is part of the GLPC's expansion of the Port which is responsible for service to 90% of the Gulf of Mexico's deep-water oil production.

DDG assisted the GLPC with preparation of exhibits and documents required in the second stage of the application for the Land and Water Conservation Fund (LWCF) by the Louisiana Department of Culture, Recreation and Tourism, Office of State Parks, and Division of Outdoor Recreation (DOR). This grant proposal seeks to designate the entire 108.7 acres for outdoor recreation with 6f protection. The initial phase of this project will seek to develop an orientation hub (pavilion, lookout tower), and walking trail with seating. A portable multi restroom facility will be on site for visitor use. Additional amenities planned for future phases include additional walking trails, boardwalks, interpretative signage on flora and fauna of the area, a picnic pavilion, and an outdoor classroom. This project will serve as a leading example of ecotourism in Louisiana by creating a fascinating coastal environment while enhancing the quality of life for those who work and play in South Louisiana.

Recently, DDG has assisted GLPC in the application for the LOFG grant. This grant will be used to enhance the boardwalk in the original master plan by 400+ linear feet. The pathway will provide an immersive experience for visitors as they move into the heart of the salt marsh towards a fishing pond at the end of the walkway. The walkway will have exceptional views of the marsh fauna and wildlife, provide a platform for birdwatching and observation of the tidal creek, and offer recreational fishing opportunities.



Completion Date
(Actual or Estimated):

Expected Completion: XXX

Estimated Cost:

Entire Project:

TBD

Work for which
Firm was Responsible:

\$40,000

TEC Professional Services Questionnaire

PROJECT NO. 8

Project Name, Location and Owner's contact information:

WILLOW + CASTILLE CORRIDORS

LAFAYETTE, LA

Lafayette Consolidated Government

Cathie Gilbert
Public Works Department P. O. Box
4017-C, Lafayette, LA 70502
(337) 291-7358



Nature of Firm's Responsibility:

The Willow + Castille Corridor Street improvements are a bold commitment to improving connectivity and safety in preparation for the reconfiguration of I-49/Evangeline Thruway through the heart of Lafayette. The project site sits at the gateway to the city, that in the past was a bustling commercial hub surrounded by thriving neighborhoods with the Northgate Mall as its anchor. As the city has aged, this area fell into disrepair and now suffers from disjointed circulation, lack of investment, and undeserved communities. This project aims to resolve these issues through design interventions that will re-invigorate the area, increase safe circulation, and revitalize a once prosperous community to ultimately drive economic bloom. The design team held numerous community outreach meetings, targeting residents along with local business leaders, to make sure each stakeholder and user group was accurately heard. With collected feedback, our goals were then defined: to utilize GIS and traffic study data to evaluate these corridors and develop design solutions that can be employed within the public domain, to help mitigate the impacts from the I-49 Connector, and to provide a more complete street solutions that offers safer pedestrian and bicycle access within the Willow St Corridor. The objective of evaluating the Castille Avenue corridor with multi-modal solutions to reduce conflicts between pedestrians and increasing vehicular traffic that will support the future revitalization of the Northgate Mall site and act as a catalyst for future community well-being. The success of this project is predicted on the desire of the current LCG leadership to stimulate economic growth and revitalization to an area of Lafayette that has been neglected far too long.

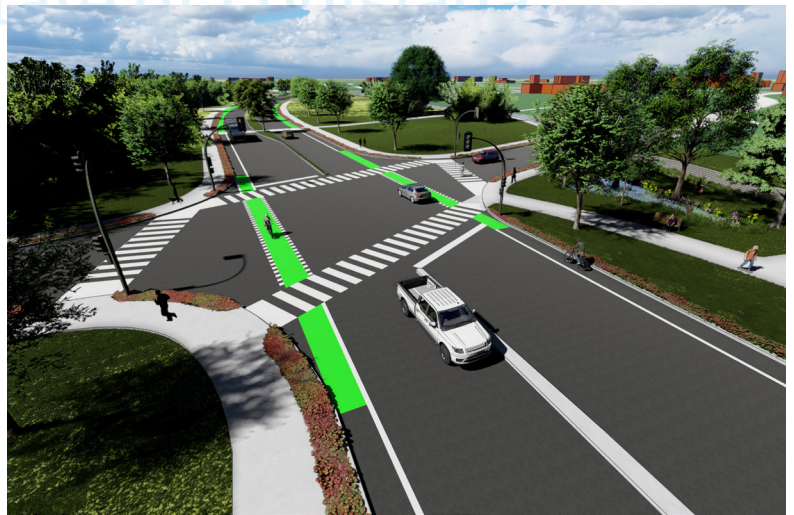

Completion Date
(Actual or Estimated):

Project Completed: December 2023
(Actual)

Estimated Cost:

Entire Project:

\$408,000

Work for which
Firm was Responsible:

\$144,000

TEC Professional Services Questionnaire

PROJECT NO. 9

Project Name, Location and
Owner's contact information:

LAFOURCHE MULTI-USE TRAIL MASTER PLAN

Lafourche Parish, LA

Lafourche Parish Government

Archie Chaisson

402 Green Street,

Thibodaux, LA 70301

(985) 446 - 8427

chaissonap@lafourchegov.org



Nature of Firm's Responsibility:

For nearly a decade, Lafourche Parish has worked toward the vision of creating a path to link the cultural destinations, artistic expressions, and rich heritage that reflects the past, present, and future of communities connected along Bayou Lafourche. Together two design firms, Duplantis Design Group (DDG) and Alta Planning and Design, created a much needed feasibility study in response to the public's desire for a multi-use trail that will enhance safety, improve livability, attract visitors, and increase economic vitality. The study focused on the reality of implementing two phases of the trail: the segment through Raceland to the Bayou Lafourche Visitors Center and the link from the Mathews Government Complex to Lockport Community Park.

The Multi-Use Path Master Plan and Feasibility Study contained an opportunities and challenges analysis and recommendations and implementation chapters that outline the preferred trail alignment and trail treatment throughout its entirety. Branding and wayfinding signage for the trail was also developed, which consisted of a logo, trail name, and wayfinding signage package that aim to inspire outreach, increase awareness, and enhance connectivity. A health and economic impact report was also completed within this plan and reflects the potential impacts to the community if the entire 56 mile alignment is implemented. To support future feasibility studies and design development, a future expansion tool kit illustrated typical cross sections, design elements, and guidance for trail support amenities.

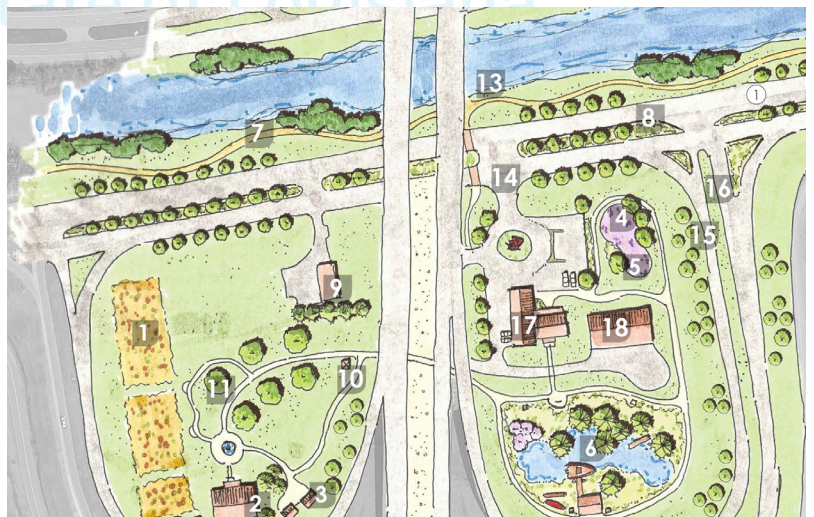

Completion Date
(Actual or Estimated):

Project Completed: March 2016
(Actual)

Estimated Cost:

Entire Project:

N/A- Master Planning Only

Work for which
Firm was Responsible:

\$30,000

TEC Professional Services Questionnaire

PROJECT NO. 10								
Project Name, Location and Owner's contact information:		Nature of Firm's Responsibility:						
<p>JIMMIE DAVIS BRIDGE LINEAR PARK</p> <p>Shreveport, LA</p> <p>TRC Companies Durk Krone 8550 United Plaza Boulevard, Suite 502 Baton Rouge, LA 70809 (225) 216-7483</p>		<p>The Jimmie Davis Bridge is a historic landmark in Shreveport, Louisiana, that spans the Red River and connects Shreveport and Bossier City. The bridge was built in 1936 and named after Jimmie Davis, a former governor and a country music singer. The bridge needs repairs and upgrades to meet modern safety standards.</p> <p>In 2019, a proposal was made to convert the bridge into a linear park, a public space that would feature greenery, benches, bike lanes, art installations, and other amenities. The idea was inspired by similar projects in other cities, such as the High Line in New York and the 606 in Chicago. The linear park would provide a new attraction and a way to preserve the historic and cultural value of the bridge.</p> <p>The design-build team that included DDG's landscape architects was among the finalists to get the project contract. The team had to create design ideas with the costs based on feasible ways of execution.</p>						
								
Completion Date (Actual or Estimated):		Estimated Cost:						
		<table border="1"> <tr> <td>Entire Project:</td> <td>Work for which Firm was Responsible:</td> </tr> <tr> <td>Expected Completion: XXX</td> <td> <table border="1"> <tr> <td>XXX</td> <td>\$44,000</td> </tr> </table> </td> </tr> </table>	Entire Project:	Work for which Firm was Responsible:	Expected Completion: XXX	<table border="1"> <tr> <td>XXX</td> <td>\$44,000</td> </tr> </table>	XXX	\$44,000
Entire Project:	Work for which Firm was Responsible:							
Expected Completion: XXX	<table border="1"> <tr> <td>XXX</td> <td>\$44,000</td> </tr> </table>	XXX	\$44,000					
XXX	\$44,000							

TEC Professional Services Questionnaire

M. List all prior and/or on-going litigation between Firm and Jefferson Parish. Please attach additional pages if necessary.

Parties:		Status/Result of Case:
Plaintiff:	Defendant:	
N/A	N/A	N/A

N. Use this space to provide any additional information or description of resources supporting Firm's qualifications for the proposed project.



THIBODAUX
LAFAYETTE
COVINGTON
BATON ROUGE
NEW ORLEANS
HOUSTON
MOBILE



170+

EMPLOYEES

16

STATES
LICENSED

4,500+

PROJECTS
COMPLETED

40

LICENSED
PROFESSIONALS

7

OFFICE
LOCATIONS

A LEADING EDGE APPROACH

DDG is a multi-disciplinary firm that offers ten (10) service lines: project management, architecture, civil engineering, landscape architecture, coastal engineering, water resources, environmental, surveying, structural engineering, and transportation. DDG has successfully completed over 4,500 projects across the Gulf Coast Region. Whether through our in-house project management and design services or using a network of trusted partner firms, our team's knowledge of material availability and construction practices have been invaluable in early planning decisions. DDG has over two decades of experience managing every aspect of a project. From the initial site assessment and due diligence through the project's substantial completion, DDG's team of design professionals pride themselves not only on the technical aspects of a project, but also on our ability to focus on exceeding clients' expectations and providing top rated client satisfaction.

OUR SERVICES



PROJECT
MANAGEMENT



CIVIL
ENGINEERING



ARCHITECTURE



LANDSCAPE
ARCHITECTURE



WATER
RESOURCES



SURVEYING



COASTAL
ENGINEERING



ENVIRONMENTAL
+ REGULATORY



TRANSPORTATION
ENGINEERING



STRUCTURAL
ENGINEERING

N. Use this space to provide any additional information or description of resources supporting Firm's qualifications for the proposed project. (Continued)

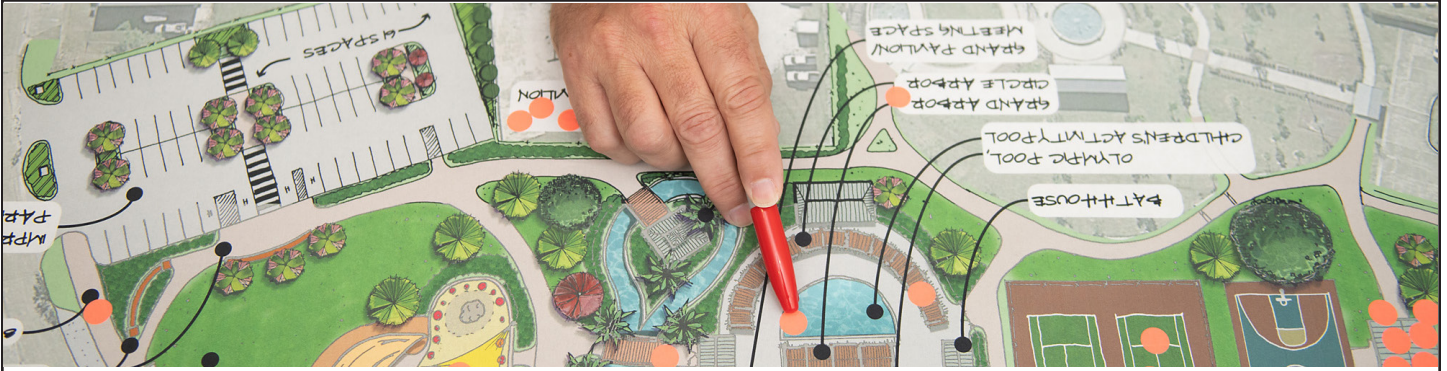

LANDSCAPE ARCHITECTURE

PLACEMAKING

Placemaking is, first and foremost, the most effective way to build community. Understanding a community's cultural and natural resources in the planning and design stages of a project leads to a well integrated and connective result. DDG's landscape architecture division will develop an intimate understanding of your community's rich cultural heritage and how to express that in design to create a cohesive sense of place. Our team's extensive experience in transforming the community's public spaces over the last 30 years has generated venues for gathering, passage, enjoyment, and pause that accentuates the characteristics of the community it is created for. DDG's proficiency in master planning, design, and implementation of public parks, plazas, complete streets, bicycle and pedestrian facilities, streetscape enhancements, and nature-based stormwater infrastructure projects is renowned by our clients and colleagues.

DDG's Landscape Architects, Architects, and Civil Engineers are committed to resilient design as a sustainable approach to designing solutions that not only to meet jurisdictional compliance, but the challenges of adapting to nature's forces. In an effort to best provide the wealth of resources DDG's team has to offer our clients, we have established a Green Infrastructure Program (GI) by offering a trans-disciplinary team to address stormwater challenges utilizing Green Infrastructure as an intervention. The value of DDG's GI Program is that we have augmented our Landscape Architecture / Civil Engineering team with expert contributors in the areas of geotechnical, hydrology, agronomy, water quality, and native vegetation. Our unprecedented approach to sustainable park design is leading the industry with proven techniques, and with a particular understanding of the local characteristics.

REFLECTING ECOLOGY + CULTURE

DDG's landscape architecture group is well known for the planning and design of inspired landscapes that reflect the ecology and culture of places throughout the South. Our reputable experience and leadership has generated value-added solutions that create a sense of place while offering sustainable solutions that are precisely suited to the client and the site. Regardless of the client or project scope, we are committed to developing aesthetically pleasing, functional design that lay a strong foundation for the future of your community.

Our extensive experience in the public sector demonstrates the confidence our clients have entrusted with us over the years. Regardless of the place's intended function, we understand not only the planning and development side, but we understand the perspective of the public agency's responsibility for maintenance and management of the venue. We offer this experience as part of our design solution process. Our experience in the planning, design, management, and maintenance of public spaces have afforded us the opportunity to utilize a multitude of funding mechanisms.

100+ combined years of experience.

100+ completed parks + rec projects.

500+ acres of parks designed.

30+ placemaking projects

N. Use this space to provide any additional information or description of resources supporting Firm's qualifications for the proposed project. (Continued)

SEAMLESS INTEGRATION

DDG offers an integrated design delivery method with our landscape architects, civil engineers, architects, and surveyors all working collaboratively under one roof providing the highest level of quality control throughout the project life-cycle.

PROJECT MANAGEMENT

DDG has experience in managing a vast range projects spanning across the South Coast. DDG has always maintained success in fully leveraging the capacity of the Project Team based on understanding of each individual's expertise, communication of roles and responsibilities, clear assignments, and establishing effective project schedules and fee allocations. DDG is committed to utilizing its local knowledge and experience to expedite normally hindering project milestones and optimize project outcomes.

CIVIL ENGINEERING

Our experience across many types of projects has forged strong relationships with the many local, state, and federal agencies. We pride ourselves in strong communication, exceptional service, and a broad range of experience from which we develop solutions to meet the needs of project stakeholders. We serve clients in many different ways to suit the needs of each project. Our professional civil engineering staff and diverse experience equips us with the ability to serve clients in multiple market segments on projects with all levels of complexity.

ARCHITECTURE

DDG's Architecture division is honored to celebrate a long history of creating exciting architectural environments. A strong foundation in retail architecture quickly led to growth in numerous areas of practice. By leveraging the remarkable strengths and talents of our resourceful architectural team, DDG has developed into a unified team of professional architects and interns dedicated to our company's core values. Our mission is to elevate architectural experiences through responsive communication and innovation. Our vision is to provide high-quality building design environments, to create sought after design experiences, and to exceed client expectations in the Gulf Coast region.

LANDSCAPE ARCHITECTURE

DDG's landscape architecture group is well known for the planning and design of inspired landscapes that reflect the ecology and culture of places throughout the South. Our reputable experience and leadership has generated value-added solutions that create a sense of place while offering sustainable solutions that are precisely suited to the client and the site. Regardless of the client or project scope, we are committed to developing aesthetically pleasing, functional design that lay a strong foundation for the future of your community.

WATER RESOURCES

DDG's expertise in hydrology and hydraulics engineering was developed through our years of experience with site development activities across the State, together with our support of local municipalities with flood risk assessments and regional drainage improvement projects. DDG is well-versed in both steady and unsteady one dimensional / two dimensional modeling. DDG has extensive experience utilizing public domain and proprietary models such as SWMM, HEC-HMS, HEC-RAS, AutoDesk Storm and Sanitary Analysis, for hydrologic assessments, conveyance / storage analysis and drainage design.

SURVEYING

DDG's in-house survey personnel and licensed surveyors have over 100 years of land surveying experience in topographic, property boundary and hydrographic surveys. Our team has successfully and safely completed numerous surveying and mapping projects across the Gulf Coast region. DDG raises the bar by utilizing the latest and most efficient methods for collecting and staking data points for property and topographic surveys.

COASTAL ENGINEERING

DDG is committed to the livelihood of the Gulf Coast and has extensive knowledge of the Gulf Coast's terrain, coastline, wildlife and fisheries, and other driving economic factors. DDG's internal team of coastal experts has over fifty years of combined experience, many of which were in direct alignment with various agencies responsible for the protection of the Gulf Coast. Since the inception of DDG's Coastal Division in 2013, the firm's team has successfully designed over 4,000 acres of marsh creation projects and has worked on an abundance of drainage projects benefiting thousands of homes and families throughout the Gulf Coast.

ENVIRONMENTAL + REGULATORY

DDG's environmental professionals are thoroughly familiar with the regulations and regulatory process of numerous governing agencies, and we work with these agencies on a daily basis. DDG has significant experience with permitting services including data consolidation, application preparation and submittal, as well as facilitating correspondence with appropriate agencies and stakeholders. DDG offers a diverse range of services designed to meet and exceed our clients' needs and expectations.

TRANSPORTATION ENGINEERING

DDG's transportation services involves analyzing, developing, and delivering functional solutions to increase the safety and efficiency of transportation systems. The funding advisory practice will allow for both public and private clients to improve their project potential by maximizing funding from numerous new and/or established funding programs.

STRUCTURAL ENGINEERING

What sets DDG's Structural Engineering team apart is our real world experience and in-depth knowledge that enables us to solve even the most challenging structural engineering tasks. We work closely with our clients to ensure that our designs meet their requirements and exceed their expectations.

N. Use this space to provide any additional information or description of resources supporting Firm's qualifications for the proposed project. (Continued)

CAPABILITY OF FIRM

Fully leveraging the capacity of DDG's staff will be achieved on an understanding of each individual's expertise, communication of roles and responsibilities, clear assignments, and establishing attainable project milestones. Additional factors highlighting the capacity of our firm/team include:

- **Local Availability** - All of DDG's staff that will work on this project are licensed in the State of Louisiana, work out of our New Orleans, Covington, Thibodaux, and Baton Rouge office locations.
- **Efficient Execution** - With the pertinent skills in hydraulics and hydrology combined with our history of efficient production for large scale site development projects, we have the ability to deliver these services more cost effectively than our competitors. We know what to do and have the skills and tools to execute the work.
- **Ideal Firm Size** - With the key individuals who are assigned to this project backed by resources who are all Louisiana-based, we are dedicated to providing reliable, responsive service on this project. With a total staff of over 170 individuals, annual revenues of almost \$35M, and with the ability to execute hundreds of projects each year, DDG will provide the leadership necessary to ensure the work is delivered on time, on budget, and to the quality expected by Jefferson Parish Government.



O. To the best of my knowledge, the foregoing is an accurate statement of facts.

Signature: 

Printed Name: Chad D. Danos, PLA, FASLA

Title: Vice President of Landscape Architecture + Principal

Date: 05/06/2024



DUPLDES-01

BWEAVER1

CERTIFICATE OF LIABILITY INSURANCE

DATE (MM/DD/YYYY)

1/2/2024

THIS CERTIFICATE IS ISSUED AS A MATTER OF INFORMATION ONLY AND CONFERS NO RIGHTS UPON THE CERTIFICATE HOLDER. THIS CERTIFICATE DOES NOT AFFIRMATIVELY OR NEGATIVELY AMEND, EXTEND OR ALTER THE COVERAGE AFFORDED BY THE POLICIES BELOW. THIS CERTIFICATE OF INSURANCE DOES NOT CONSTITUTE A CONTRACT BETWEEN THE ISSUING INSURER(S), AUTHORIZED REPRESENTATIVE OR PRODUCER, AND THE CERTIFICATE HOLDER.

IMPORTANT: If the certificate holder is an ADDITIONAL INSURED, the policy(ies) must have ADDITIONAL INSURED provisions or be endorsed. If SUBROGATION IS WAIVED, subject to the terms and conditions of the policy, certain policies may require an endorsement. A statement on this certificate does not confer rights to the certificate holder in lieu of such endorsement(s).

PRODUCER License # 231432 Hub International Gulf South 3861 Ambassador Caffery Parkway Suite 550 Lafayette, LA 70503	CONTACT NAME: Lisa Savant PHONE (A/C, No, Ext): FAX (A/C, No): E-MAIL ADDRESS: lisa.savant@hubinternational.com
INSURED Duplantis Design Group, PC 314 East Bayou Road Thibodaux, LA 70301	INSURER(S) AFFORDING COVERAGE INSURER A : Beazley Insurance Company 37540 INSURER B : Houston Specialty Insurance Company 12936 INSURER C : Navigators Insurance Company 42307 INSURER D : Manufacturers Alliance Insurance Company 36897 INSURER E : HDI Global Specialty SE 086486 INSURER F :

COVERAGES

CERTIFICATE NUMBER:

REVISION NUMBER:

THIS IS TO CERTIFY THAT THE POLICIES OF INSURANCE LISTED BELOW HAVE BEEN ISSUED TO THE INSURED NAMED ABOVE FOR THE POLICY PERIOD INDICATED. NOTWITHSTANDING ANY REQUIREMENT, TERM OR CONDITION OF ANY CONTRACT OR OTHER DOCUMENT WITH RESPECT TO WHICH THIS CERTIFICATE MAY BE ISSUED OR MAY PERTAIN, THE INSURANCE AFFORDED BY THE POLICIES DESCRIBED HEREIN IS SUBJECT TO ALL THE TERMS, EXCLUSIONS AND CONDITIONS OF SUCH POLICIES. LIMITS SHOWN MAY HAVE BEEN REDUCED BY PAID CLAIMS.

INSR LTR	TYPE OF INSURANCE	ADDL INSD	SUBR WVD	POLICY NUMBER	POLICY EFF (MM/DD/YYYY)	POLICY EXP (MM/DD/YYYY)	LIMITS
A	<input checked="" type="checkbox"/> COMMERCIAL GENERAL LIABILITY <input type="checkbox"/> CLAIMS-MADE <input checked="" type="checkbox"/> OCCUR <input checked="" type="checkbox"/> Occurrence Basis GEN'L AGGREGATE LIMIT APPLIES PER: <input checked="" type="checkbox"/> POLICY <input checked="" type="checkbox"/> PROJECT <input type="checkbox"/> LOC OTHER:			V35998230101	9/1/2023	9/1/2024	EACH OCCURRENCE \$ 1,000,000 DAMAGE TO RENTED PREMISES (Ea occurrence) \$ 50,000 MED EXP (Any one person) \$ 5,000 PERSONAL & ADV INJURY \$ 1,000,000 GENERAL AGGREGATE \$ 2,000,000 PRODUCTS - COMP/OP AGG \$ 2,000,000
B	AUTOMOBILE LIABILITY <input type="checkbox"/> ANY AUTO OWNED AUTOS ONLY <input checked="" type="checkbox"/> SCHEDULED AUTOS <input checked="" type="checkbox"/> HIRED AUTOS ONLY <input checked="" type="checkbox"/> NON-OWNED AUTOS ONLY			HSLR180890700	9/1/2023	9/1/2024	COMBINED SINGLE LIMIT (Ea accident) \$ 1,000,000 BODILY INJURY (Per person) \$ BODILY INJURY (Per accident) \$ PROPERTY DAMAGE (Per accident) \$
C	<input checked="" type="checkbox"/> UMBRELLA LIAB <input checked="" type="checkbox"/> OCCUR <input type="checkbox"/> EXCESS LIAB <input type="checkbox"/> CLAIMS-MADE DED RETENTION \$			HO23LIAZ0F16302	9/1/2023	9/1/2024	EACH OCCURRENCE \$ 5,000,000 AGGREGATE \$ 5,000,000
D	WORKERS COMPENSATION AND EMPLOYERS' LIABILITY ANY PROPRIETOR/PARTNER/EXECUTIVE OFFICER/MEMBER EXCLUDED? (Mandatory in NH) Y/N <input checked="" type="checkbox"/> N If yes, describe under DESCRIPTION OF OPERATIONS below	N/A		2023011484005Y	9/1/2023	9/1/2024	<input checked="" type="checkbox"/> PER STATUTE <input type="checkbox"/> OTHER E.L. EACH ACCIDENT \$ 1,000,000 E.L. DISEASE - EA EMPLOYEE \$ 1,000,000 E.L. DISEASE - POLICY LIMIT \$ 1,000,000
E	Professional Liabili			12086317-B	1/18/2024	1/18/2025	Professional 5,000,000
A	Protection & Ind			V35999230101	9/1/2023	9/1/2024	P&I 1,000,000

DESCRIPTION OF OPERATIONS / LOCATIONS / VEHICLES (ACORD 101, Additional Remarks Schedule, may be attached if more space is required)

CERTIFICATE HOLDER

CANCELLATION

Insured's Copy

SHOULD ANY OF THE ABOVE DESCRIBED POLICIES BE CANCELLED BEFORE THE EXPIRATION DATE THEREOF, NOTICE WILL BE DELIVERED IN ACCORDANCE WITH THE POLICY PROVISIONS.

AUTHORIZED REPRESENTATIVE

TEC Professional Services Questionnaire

A. Project Name and Advertisement Resolution Number:
Professional Landscape Architectural Services

B. Firm Name & Address:



Moses Engineers
909 Poydras St. Ste 1100
New Orleans, LA. 70112

C. Name, title and contact information of Principal, as defined in Section 2-926 of the Jefferson Parish Code of Ordinances, who is a registered, licensed architect, professional engineer, or surveyor in the State of Louisiana:

- Howard Moses, Principal
 - hmoses@mosesengineers.com
 - 504-939-1377
 - Moses Engineers License #EF.0001882

D. Name and contact information of employee who is a registered and licensed architect, professional engineer, or surveyor in the State of Louisiana in the applicable discipline. A subcontractor may be substituted here only if the advertised Project requires more than one discipline.

- Blake Hosli, P.E. (Chief Electrical Engineer)
 - bhosli@mosesengineers.com
 - 504-910-2557
 - P.E. #38688

E. Please provide the number of employees whose primary function corresponds with each category:

<u>4</u> Administrative	___ Estimators	___ Specification Writers
___ Architects (Licensed)	___ Geologists	___ Structural Engineers
___ Chemical Engineers	___ Geotechnical Engineers	___ Graduate Engineers
___ Civil Engineers	___ Interior Designers	<u>1</u> Project Managers
<u>1</u> Construction Inspectors	___ Landscape Architects	___ Clerical
___ Ecologists	___ Land Surveyor	___ Grant/Funding Specialist
<u>3</u> Electrical Engineers	<u>5</u> Mechanical Engineers	___ Sanitary Engineers
___ Engineer Intern	___ Environmental Engineers	
___ Professional Land Surveyors		

14 TOTAL

F. Is this submittal by a JOINT-VENTURE? Please check:

☐

YES

☒

NO

If marked "No" skip to Section I. "Yes" completed Sections G-H.

TEC Professional Services Questionnaire

G. If submittal is by JOINT-VENTURE, list the firms participating and outline specific areas of responsibility (including administrative, technical, and financial) for each firm. Please attach additional pages if necessary.

1. N/A

2. N/A

H. Has this JOINT-VENTURE previously worked together? Please check: Yes_____ No _____

I. List all subcontractors anticipated for this Project. Please note that all subcontractors must submit a fully completed copy of this questionnaire, applicable licenses, and any other information required by the advertisement. See Jefferson Parish Code of Ordinances, Sec. 2-928(a)(3). Please attach additional pages if necessary.

Name & Address:	Specialty:	Worked with Firm Before (Yes or No):
See Prime Consultant's TEC	See Prime Consultant's TEC	See Prime Consultant's TEC

J. Please specify the total number of support personnel that may assist in the completion of this Project: _____

TEC Professional Services Questionnaire

PROFESSIONAL IN CHARGE OF PROJECT:

Name & Title:

Blake Hosli, P.E.
Chief Electrical Engineer

Project Assignment:

Chief Electrical Engineer who will oversee all required Electrical Engineering on this project.

Name of Firm with which associated:

Moses Engineers

Years' experience with this firm:

9 years

Education: Degree(s)/Year/Specialization:

Louisiana Tech University, 2009; Master of Science, Engineering and Technology
Louisiana Tech University, 2008; Bachelor of Science, Electrical Engineering

Active registration: Year first registered/discipline:

Louisiana Electrical Engineer; LA PE Registration #38688
Mississippi Electrical Engineer; MS PE Registration #31186
Texas Electrical Engineer; TX PE Registration #134280

Other experience and qualifications relevant to the proposed Project:

- | | |
|------------------------------|-----------------------------------|
| 1. John Alario Sports Center | 5. Xavier Parking Garage |
| 2. Kenner Discovery School | 6. MCCNO Linear Park |
| 3. JPAWS | 7. Audubon Zoo (Various Projects) |
| 4. Woldenburg Park | |

- President of SELA IAEI (International Association of Electrical Inspectors, Southeast Louisiana Chapter)

Blake Hosli is an Electrical Engineer who has worked in the fields of planning, developing, and managing various electrical projects over the past 15 years. In addition to that, he is trained as an electrical technician and has experience in the installation of electrical devices, electrical systems, and alarm systems. Blake has the necessary training to work as a Revit engineer and designer. He has designed numerous projects for both public and private clients.

TEC Professional Services Questionnaire

KEY PERSON, SPECIALIST, OR INDIVIDUAL CONSULTANT:

Name & Title:

Raymond Smith, P.E.
Chief Mechanical Engineer

Project Assignment:

Chief Mechanical Engineer in charge of all HVAC, Plumbing and Fire Protection Engineering required.

Name of Firm with which associated:

Moses Engineers

Years' experience with this firm:

9 years

Education: Degree(s)/Year/Specialization:

Tulane University, 2006; Bachelors of Science, Mechanical Engineering

Active registration: Year first registered/discipline:

Louisiana Mechanical Engineer; LA PE Registration #36823

Other experience and qualifications relevant to the proposed Project:

- | | |
|----------------------------|-----------------------------------|
| 1. Xavier Parking Garage | 5. Lakeway Fuel Tank |
| 2. Kenner Discovery School | 6. John Alario Sports Center |
| 3. JPAWS | 7. Newman Levy Building |
| 4. Woldenburg Park | 8. Audubon Zoo (Several Projects) |

- Member of American Society of Heating
- ASHRAE, American Society of Heating, Refrigeration and Air Conditioning Services
- ASPE, American Society of Plumbing Engineers

Raymond has over 18 years of experience in the design of heating, ventilation, air conditioning (HVAC), controls, plumbing, and fire protection systems for commercial, industrial, residential, and municipal properties, both existing and new. Raymond has been responsible for the design of mechanical systems for a number of historically significant building refurbishment projects. He has also been the Lead Mechanical Engineer on over a dozen new public projects all over \$20M.

TEC Professional Services Questionnaire

KEY PERSON, SPECIALIST, OR INDIVIDUAL CONSULTANT:

Name & Title:

Howard Moses
Principal

Project Assignment:

Principal In Charge of all Mechanical and Electrical Engineering. He is responsible for making all deliverables and milestones.

Name of Firm with which associated:

Moses Engineers

Years' experience with this firm:

36 years

Education: Degree(s)/Year/Specialization:

Southern Methodist University, 1986; Bachelors of Science, Mechanical Engineering, LEED AP BD+C

Active registration: Year first registered/discipline:

N/A

Other experience and qualifications relevant to the proposed Project:

- | | |
|--|--|
| <ol style="list-style-type: none"> 1. Audubon Zoo (Several Projects) 2. Newman Levy Building Renovations 3. Woldenburg Park 4. JPAWS | <ol style="list-style-type: none"> 5. John Alario Sports Center 6. Kenner Discovery School 7. Xavier Parking Garage |
|--|--|
- LEED, AP BD+C
 - American Society of Heating, Refrigeration and Air Conditioning Engineers, ASHRAE
 - Construction Specifications Institute, CSI
 - Association of Energy Engineers, AEE
 - Central Area Committee, 1998 Chairman Member, New Orleans Council Executive Committee of the Chamber of Commerce
 - Area Council Coordinating Committee of the Chamber of Commerce
 - NFPA

Howard has over 35 years' experience in designing mechanical and electrical systems for both new and renovated commercial and institutional buildings throughout the Gulf South region. Howard is a second-generation owner of Moses Engineers with strong ties to the local real estate, development and code making and enforcement officials. Howard has managed over 30 large public projects for various clients.

TEC Professional Services Questionnaire

KEY PERSON, SPECIALIST, OR INDIVIDUAL CONSULTANT:

Name & Title:

Frank Schambach
Construction Administrator

Project Assignment:

Construction Administrator who will attend all required OAC meetings, attend site inspections and will be responsible for completing our punch list.

Name of Firm with which associated:

Moses Engineers

Years' experience with this firm:

12 years

Education: Degree(s)/Year/Specialization:

Tulane University, 1978; Bachelors of Science, Mathematics and Computer Science

Active registration: Year first registered/discipline:

N/A

Other experience and qualifications relevant to the proposed Project:

- | | |
|-------------------------------------|-----------------------------------|
| 1. Kenner Discovery School | 5. Woldenburg Park |
| 2. JPAWS | 6. Audubon Zoo (Various Projects) |
| 3. John Alario Sports Center | 7. Xavier Parking Garage |
| 4. Newman Levy Building Renovations | |

- ASHRAE, American Society of Heating, Refrigeration and Air Conditioning Services
- EMA, Energy Management Association

As Landmark Hotel Chief Engineer, Mr. Schambach received excellent HVAC, lighting and power system knowledge. Since 1979, Frank managed the University of New Orleans' Energy Management System. This role was expanded to encompass utilities during the University's rapid growth. From 1988 through 2000, Frank was the Facilities Director. From 2001 until 2011, Frank advised contractors and equipment manufacturers on many building projects. He was respected by owners, contractors and design professionals for his fair and knowledgeable construction project management. Frank has worked on over 20 public projects since joining Moses Engineers in 2012 as their Construction Administrator.

TEC Professional Services Questionnaire

L. Work by Firm or Joint-Venture members which best illustrates current qualifications relevant to this Project. Please include any and all work performed for the Lafitte Area Independent Levee District (LAILD). Please attach additional pages if necessary.

PROJECT NO. 1

Project Name, Location and Owner's contact information:

AUDUBON ZOO, JAGUAR JUNGLE

6500 Magazine Street
New Orleans, LA. 70118

Audubon Nature Institute:
Robert Schumacher
504-495-7695

Nature of Firm's Responsibility:

The Jaguar Jungle Expansion Project is a comprehensive initiative designed to enhance the visitor experience at our zoo. The project involves extending Jaguar Jungle's existing pathway, crossing over the water to allow visitors to get closer to the animals, thereby providing a more engaging and educational experience. A significant part of this project is the introduction of new lighting for walkways and pathways which will ensure safety for zoo patrons.

In an exciting development, we are adding power to a section of the park that has never had sufficient electrical utilities. This will serve the back of house barn areas which caters to the animals that inhabit the African Savannah portion of the zoo. We are also adding power for lighting and interactive exhibits to the island that is currently being built within the Jaguar Jungle. Supporting these Patron side enhancements, we are constructing a new animal holding facility for Tapirs and Rheas. This facility will be equipped with all necessary Mechanical, Electrical, and Plumbing (MEP) services, ensuring a sustainable and efficient operation. All MEP services to the new and renovated facilities within the Jaguar Jungle will be provided by Moses Engineers.



Completion Date
(Actual or Estimated):

Fall 2024

Estimated Cost:

Entire Project:

\$6.5 Million

Work for which
Firm was Responsible:

\$1.3 Million

TEC Professional Services Questionnaire

L. Work by Firm or Joint-Venture members which best illustrates current qualifications relevant to this Project. Please include any and all work performed for the Lafitte Area Independent Levee District (LAILD). Please attach additional pages if necessary.

PROJECT NO. 2

Project Name, Location and Owner's contact information:

AUDUBON ZOO, EARTHLAB RENOVATION

6500 Magazine Street
New Orleans, LA. 70118

Audubon Nature Institute:
Robert Schumacher
504-495-7695

Nature of Firm's Responsibility:

This project involved a comprehensive renovation of an existing works progress administration era building, transforming it into a new home for Audubon Zoo's animal ambassadors. The scope of the project included a full overhaul of the building's mechanical, electrical, and plumbing systems to ensure a safe, comfortable, and efficient environment for the zoo's animal ambassadors. The renovation was meticulously planned and executed, keeping in mind the unique needs of the animals and the operational requirements of the zoo.



Jefferson
Parish
State of Louisiana



Completion Date
(Actual or Estimated):

Estimated Cost:

Entire Project:

Work for which
Firm was Responsible:

Fall 2024

\$5 Million

\$1 Million

TEC Professional Services Questionnaire

L. Work by Firm or Joint-Venture members which best illustrates current qualifications relevant to this Project. Please include any and all work performed for the Lafitte Area Independent Levee District (LAILD). Please attach additional pages if necessary.

PROJECT NO. 3

Project Name, Location and Owner's contact information:

AUDUBON ZOO, LION EXHIBIT

6500 Magazine Street
New Orleans, LA. 70118

Audubon Nature Institute:
Robert Schumacher
504-495-7695

Nature of Firm's Responsibility:

This project involved the construction of a brand-new lion exhibit at the Audubon Zoo, executed by Moses Engineers. The new exhibit required the demolition of parts of the existing African Wild Dog Exhibit to make space. The new facility not only houses the lion exhibit but also includes a dedicated caring and cubbing holding area for female lions and their offspring, ensuring their safety and well-being. Moses Engineers was responsible for the design and implementation of all the mechanical, electrical, and plumbing services for this new build. The successful completion of this project has resulted in a state-of-the-art lion exhibit and cubbing facility, enhancing the visitor experience and providing an enriched habitat for the lions.



Jefferson
Parish
State of Louisiana



Completion Date
(Actual or Estimated):

2019

Estimated Cost:

Entire Project:

\$5 Million

Work for which
Firm was Responsible:

\$1.8 Million

TEC Professional Services Questionnaire

L. Work by Firm or Joint-Venture members which best illustrates current qualifications relevant to this Project. Please include any and all work performed for the Lafitte Area Independent Levee District (LAILD). Please attach additional pages if necessary.

PROJECT NO. 4

Project Name, Location and Owner's contact information:

AUDUBON ZOO, REPTILE EXHIBIT

6500 Magazine Street
New Orleans, LA. 70118

Audubon Nature Institute:
Robert Schumacher
504-495-7695

Nature of Firm's Responsibility:

This project was an electrical renovation of the Audubon Zoo's reptile exhibit, carried out by Moses Engineers. The renovation was focused on enhancing the electrical infrastructure of the exhibit. It included the installation of new lighting throughout the exhibit, creating an improved environment for both the reptiles and the visitors. Additional power connections were also added to the back of house for all exhibit areas, ensuring a robust and reliable power supply for the exhibit's diverse needs. This project has significantly improved the functionality and visitor experience of the reptile exhibit at the Audubon Zoo.

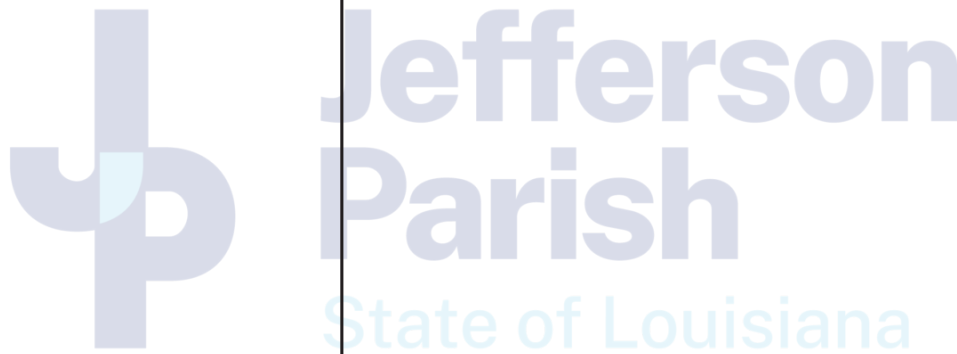

Completion Date
(Actual or Estimated):

2023

Estimated Cost:

Entire Project:

\$400,000

Work for which
Firm was Responsible:

\$400,000

TEC Professional Services Questionnaire

L. Work by Firm or Joint-Venture members which best illustrates current qualifications relevant to this Project. Please include any and all work performed for the Lafitte Area Independent Levee District (LAILD). Please attach additional pages if necessary.

PROJECT NO. 5

Project Name, Location and
Owner's contact information:

JOHN ALARIO SPORTS COMPLEX
2000 Segnette Blvd
Westwego, LA. 70094

Legends Project Development:
Daniel Rojas
623-363-1956

Nature of Firm's Responsibility:

This project involved the construction of a brand-new multi-sport facility, designed and executed by Moses Engineers, a leading MEP (Mechanical, Electrical, and Plumbing) Engineering consulting firm. The facility includes three large fields that can be configured for either soccer or baseball, with provisions for additional fields in the future. The project scope encompassed the entire site lighting, batting cages, multiple restroom buildings, ball field lighting, an administration/registration building, and a large concession building. Moses Engineers was responsible for the full MEP design and implementation, ensuring a well-lit, functional, and user-friendly environment for athletes and visitors alike.

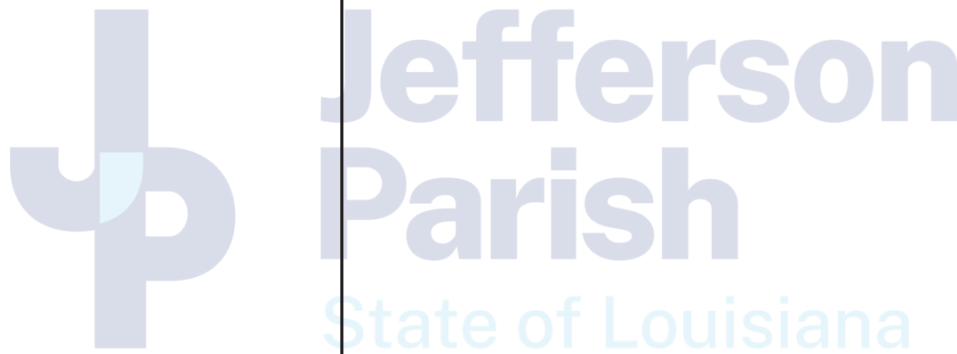

Completion Date
(Actual or Estimated):

Estimated Cost:

Entire Project:

Work for which
Firm was Responsible:

Winter 2024-2025

\$20.8 Million

\$8.5 Million

TEC Professional Services Questionnaire

L. Work by Firm or Joint-Venture members which best illustrates current qualifications relevant to this Project. Please include any and all work performed for the Lafitte Area Independent Levee District (LAILD). Please attach additional pages if necessary.

PROJECT NO. 6

Project Name, Location and Owner's contact information:

NEW ORLEANS ERNEST N. MORIAL CONVENTION CENTER LINEAR PARK
New Orleans, LA.

David Mason:
Senior Director of Capital Project Delivery
504-582-3041

Nature of Firm's Responsibility:

The Convention Center Linear Park project, a significant addition to the urban landscape of Downtown New Orleans, spans a length of one mile, extending from Henderson Street to Poydras Street. This strategic location has enhanced the connectivity between the convention center and the downtown area. The project's features were carefully selected to augment the aesthetic and functional aspects of the park. These included landscape lighting that added a warm and welcoming ambiance during the evening hours, an interactive fountain that served as a focal point of attraction, and pedestrian park lighting that ensured safety and visibility. To further enhance security, emergency phone boxes were installed at various points throughout the park. Decorative lighting was also incorporated to highlight key architectural and landscape features. The project was not just about aesthetics; it also catered to the practical needs of powering the park. Multiple electrical services were installed to ensure a steady and reliable power supply. Additionally, power connections were set up for park events such as festivals, ensuring that the park could host a variety of community events and celebrations. This project has successfully transformed the convention center's vicinity into a vibrant and dynamic public space.



Completion Date
(Actual or Estimated):

Spring 2022

Estimated Cost:

Entire Project:

\$52 Million

Work for which
Firm was Responsible:

\$7.1 Million

TEC Professional Services Questionnaire

L. Work by Firm or Joint-Venture members which best illustrates current qualifications relevant to this Project. Please include any and all work performed for the Lafitte Area Independent Levee District (LAILD). Please attach additional pages if necessary.

PROJECT NO. 7

Project Name, Location and Owner's contact information:

WOLDENBERG RIVERFRONT PARK

1 Canal Street
New Orleans, LA. 70130

Audubon Nature Institute:
Robert Schumacher
504-495-7695

Nature of Firm's Responsibility:

This project involved a partial electrical demolition and subsequent enhancement of an existing facility. The work included providing power to building façade lighting and controls that were designed by EOS. Moses Engineers also handled the selection and layout of lighting fixtures, and conducted a photometric study for the plaza area lighting. This encompassed poles, seating lighting, landscape lighting, and bollards. Additionally, the project involved the repair of two existing 100A 480V panels that feed the plaza area, ensuring a reliable power supply. Power was also provided to irrigation systems, pumps, and controllers, in coordination with other designers. Lastly, the installation of security cameras was carried out in coordination with Audubon's security team.

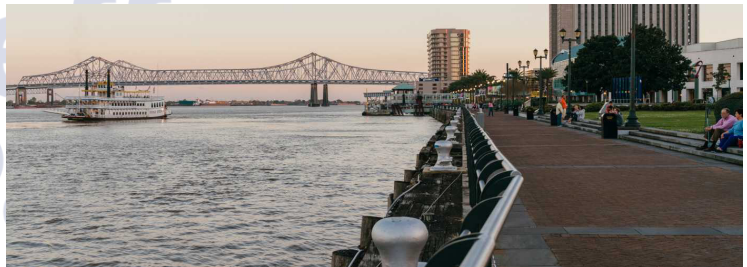

Completion Date
(Actual or Estimated):

Estimated Cost:

Entire Project:

Work for which
Firm was Responsible:

Winter 2024-2025

\$5 Million

\$400,000

TEC Professional Services Questionnaire

L. Work by Firm or Joint-Venture members which best illustrates current qualifications relevant to this Project. Please include any and all work performed for the Lafitte Area Independent Levee District (LAILD). Please attach additional pages if necessary.

PROJECT NO. 8

Project Name, Location and Owner's contact information:

KENNER DISCOVERY SCHOOL
2504 Maine Ave.
Kenner, LA. 70062

Rachelle Albright:
504-416-0890

Nature of Firm's Responsibility:

Moses Engineers was tasked with the full MEP (Mechanical, Electrical, and Plumbing) design for the new Kenner Discovery School. This project aligns with their commitment to energy-efficient design and their extensive experience in innovative technologies. Our design offered a cost-effective and eco-friendly solution for the school's construction.



Jefferson
Parish
State Police



Completion Date
(Actual or Estimated):

2021

Estimated Cost:

Entire Project:

\$32 Million

Work for which
Firm was Responsible:

\$7 Million

TEC Professional Services Questionnaire

L. Work by Firm or Joint-Venture members which best illustrates current qualifications relevant to this Project. Please include any and all work performed for the Lafitte Area Independent Levee District (LAILD). Please attach additional pages if necessary.

PROJECT NO. 9

Project Name, Location and
Owner's contact information:

KENNER DISCOVERY SCHOOL
2504 Maine Ave.
Kenner, LA. 70062

Rachelle Albright:
504-416-0890

Nature of Firm's Responsibility:

This project involves the MEP (Mechanical, Electrical, and Plumbing) design for a new seven-floor parking garage on Xavier Campus. The design includes full electrical, mechanical, and plumbing systems, two elevators, and a generator for the garage. The project is fully compliant with the International Energy Conservation Code (IECC) 2021, ensuring energy efficiency and sustainability. This design effort is significant, considering the complexity of enclosed parking garages. The project represents a commitment to creating a safe, efficient, and environmentally friendly parking solution for the campus community.



Jefferson
Parish
State of Louisiana

Completion Date
(Actual or Estimated):

Estimated Cost:

Entire Project:

Work for which
Firm was Responsible:

Summer 2025

\$8.5 Million

\$1.7 Million

TEC Professional Services Questionnaire

L. Work by Firm or Joint-Venture members which best illustrates current qualifications relevant to this Project. Please include any and all work performed for the Lafitte Area Independent Levee District (LAILD). Please attach additional pages if necessary.

PROJECT NO. 9

Project Name, Location and Owner's contact information:

JPAWS- JEFFERSON PARISH ANIMAL WELLNESS SHELTER

Michelle Brignac
mbrignac@jeffparish.net

Nature of Firm's Responsibility:

The Jefferson Parish Animal Wellness Shelter project involves a comprehensive MEP (Mechanical, Electrical, and Plumbing) design for a new animal shelter and wellness treatment facility. This new construction project, located on an existing site, aims to improve community welfare by saving and protecting animals, providing care and treatment. The design will ensure a healthy environment for the animals, controlling the transmission of diseases and bacteria. The project underscores a commitment to animal welfare and sustainable design.

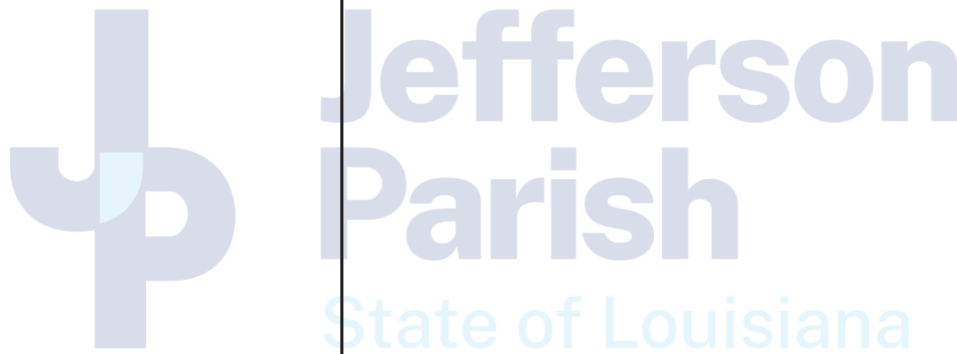

Completion Date
(Actual or Estimated):

Estimated Cost:

Entire Project:

Work for which
Firm was Responsible:

December 2025

\$17 Million

\$4.5 Million

TEC Professional Services Questionnaire

M. List all prior and/or on-going litigation between Firm and Jefferson Parish. Please attach additional pages if necessary.

Parties:		Status/Result of Case:
Plaintiff:	Defendant:	
N/A	N/A	N/A

N. Use this space to provide any additional information or description of resources supporting Firm's qualifications for the proposed project.

Moses Engineers is a reputable consulting engineering firm based in New Orleans. The firm was established in 1947 by Warren G. Moses and has since been passed down to the second generation of family management, currently led by Howard Moses. The firm offers a wide range of services, including mechanical, electrical, and telecommunications engineering consulting, catering to government agencies, developers, building owners, and architectural firms.

All senior design personnel at Moses Engineers are registered professional engineers, and 70% of the technical staff are LEED Accredited Professionals. The firm has an impressive portfolio of significant hospitality projects, including the Lucayan Plaza Resort on Grand Bahamas and local projects such as the Four Seasons Hotel and Residences, The Standard Condominiums, the Odeon Apartment, the Virgin Hotel, and the NOPSI Hotel.

Moses Engineers has extensive experience across various sectors, including hospitality, government, historic preservation, sustainability, multi-family residential commercial office space, and cultural projects. The firm has completed full MEP services for projects like The Four Seasons Hotel and Residences, The Canopy by Hilton Hotel, The Sazerac House, NOPSI Hotel, and many more.

Sustainability is a high priority for Moses Engineers. In 2012, the U.S. Green Building Council awarded the firm its first annual Sustainability Leadership "Community Championship Team" Award for its body of work in sustainable design practices. In 2009, the firm's MEP design contributed to Tulane's Lavin-Bernick Center being awarded the National AIA Top Ten Green Project award.

In recent years, sustainable design has become a major focus of the firm. Moses Engineers was the Mechanical, Electrical, and Plumbing Engineers for the USA Global Green Holy Cross Project, a sustainable residential and community center complex achieving LEED Platinum Ratings in the New Orleans Lower Ninth Ward. The firm also designed the first LEED-rated film studio in the country, achieving LEED Gold Certification, and over 15 LEED Silver and LEED Gold K-12 schools in New Orleans.

The firm also has a strong focus on resilience, with the ability of a building to perform both during and subsequent to a significant natural disaster being a key consideration in their designs. This was particularly evident in their response to Hurricane Katrina. Moses Engineers has also recently participated in the East Jefferson Levee District Safe House and the Saint John the Baptist Parish Safe Room projects, both of which are hardened facilities for First Responder Operations Centers and Emergency Housing. The firm has a strong track record in working with Historic Preservation Projects across New Orleans, with notable projects including Second Line Stages, New Orleans Culinary and Hospitality Institute, Brennan's Restaurant, NOPSI Hotel, and the Garage Apartments and Condominiums. This rich history and commitment to excellence make Moses Engineers a leading firm in the field of MEP Engineering consulting.

O. To the best of my knowledge, the foregoing is an accurate statement of facts.

Signature:  Printed Name: Howard Moses

Title: Principal Date: May 8, 2024



DIVISION OF SMALL BUSINESS SERVICES

This certification acknowledges that

MOSES ENGINEERS INC

is Certified-Active as a Small Entrepreneurship with
Louisiana Economic Development's Hudson Initiative.

This certification is valid from 1/25/2023 to 1/25/2024 .

Certification No. 16555

A handwritten signature in black ink, reading "Stephanie Hartman", is written over a horizontal line.

Stephanie Hartman,
Director, Entrepreneurial Services

Statement of Qualifications

AFFIDAVIT

STATE OF Louisiana

PARISH/COUNTY OF St. Tammany

BEFORE ME, the undersigned authority, personally came and appeared: Thomas H. Buckel, (Affiant) who after being by me duly sworn, deposed and said that he/she is the fully authorized Principal of Duplantis Design Group, PC (Entity), the party who submitted a Statement of Qualifications (SOQ) to Jefferson Parish Government (Briefly describe the services the SOQ will cover), to the Parish of Jefferson.

Affiant further said:

Campaign Contribution Disclosures

(Choose A or B, if option A is indicated please include the required attachment):

Choice A X

Attached hereto is a list of all campaign contributions, including the date and amount of each contribution, made to current or former elected officials of the Parish of Jefferson by Entity, Affiant, and/or officers, directors and owners, including employees, owning 25% or more of the Entity during the two-year period immediately preceding the date of this affidavit or the current term of the elected official, whichever is greater. Further, Entity, Affiant, and/or Entity Owners have not made any contributions to or in support of current or former members of the Jefferson Parish Council or the Jefferson Parish President through or in the name of another person or legal entity, either directly or indirectly.

Choice B _____

there are **NO** campaign contributions made which would require disclosure under Choice A of this section.

Affiant further said:

Debt Disclosures

(Choose A or B, if option A is indicated please include the required attachment):

Choice A _____ Attached hereto is a list of all debts owed by the affiant to any elected or appointed official of the Parish of Jefferson, and any and all debts owed by any elected or appointed official of the Parish to the Affiant.

Choice B X There are **NO** debts which would require disclosure under Choice A of this section.

Affiant further said:

Solicitation of Campaign Contribution Disclosures

(Choose A or B, if option A is indicated please include the required attachment):

Choice A _____ Attached hereto is a list of all elected officials of the Parish of Jefferson, whether still holding office at the time of the affidavit or not, where the elected official, individually, either by **telephone or by personal contact**, solicited a campaign contribution or other monetary consideration from the Entity, including the Entity's officers, directors and owners, and employees owning twenty-five percent (25%) or more of the Entity, during the two-year period immediately preceding the date the affidavit is signed. Further, to the extent known to the Affiant, the date of any such solicitation is included on the attached list.

Choice B X there are **NO** solicitations for campaign contributions which would require disclosure under Choice A of this section.

Affiant further said:

Subcontractor Disclosures

(Choose A or B, if option A is indicated please include the required attachment):

Choice A X

Affiant further said that attached is a listing of all subcontractors, excluding full time employees, who may assist in providing professional services for the aforementioned SOQ.

Choice B

There are **NO** subcontractors which would require disclosure under Choice A of this section.

Affiant further said:

That Affiant has employed no person, corporation, firm, association, or other organization, either directly or indirectly, to secure the public contract under which he received payment, other than persons regularly employed by the Affiant whose services in connection with the construction, alteration or demolition of the public building or project or in securing the public contract were in the regular course of their duties for Affiant; and

[The remainder of this page is intentionally left blank.]

That no part of the contract price received by Affiant was paid or will be paid to any person, corporation, firm, association, or other organization for soliciting the contract, other than the payment of their normal compensation to persons regularly employed by the Affiant whose services in connection with the construction, alteration or demolition of the public building or project were in the regular course of their duties for Affiant.



Signature of Affiant

Thomas H. Buckel

Printed Name of Affiant

SWORN AND SUBSCRIBED TO BEFORE ME

ON THE 8th DAY OF May, 2024.



Notary Public

Brad Villemuer

Printed Name of Notary

173946

Notary/Bar Roll Number

My commission expires at death.



CAMPAIGN CONTRIBUTIONS

Below is a list of all elected officials of the Parish of Jefferson, whether still holding office at the time of the affidavit or not, where the elected official, individually, either by telephone or by personal contact, solicited a campaign contribution or other monetary consideration from the Entity, including the Entity's officers, directors and owners, and employees owning twenty-five percent (25%) or more of the Entity, during the two-year period immediately preceding the date the affidavit is signed. Further, to the extent known to the Affiant, the date of any such solicitation is included on the attached list.

1. Committee to Elect Jennifer Vrancken
\$1,000 / April 2, 2024

SUBCONTRACTOR DISCLOSURES

Below is a listing of all subcontractors, excluding full time employees, who may assist in providing professional services for the aforementioned SOQ.

1. Moses Engineers
909 Poydras Street, Suite 1100
New Orleans, LA 70112

DUPLANTIS DESIGN GROUP, PC

314 East Bayou Road; Thibodaux, LA 70301
(O) 985.447.0090 (F) 985.447.7009

THIBODAUX
NEW ORLEANS

BATON ROUGE
LAFAYETTE

COVINGTON
HOUSTON