

PE215T-10-4-AI

GENERAL PURPOSE ELECTRIC MOTOR

NEMA PREMIUM EFFICIENCY

TOTALLY ENCLOSED FAN COOLED

INVERTER DUTY 10:1 CT; 20:1 VT - NEMA MG1 PART 31

Factory Certified for T2B Class I, Division II, Groups A,B,C & D and Class II, Division II, Groups F & G

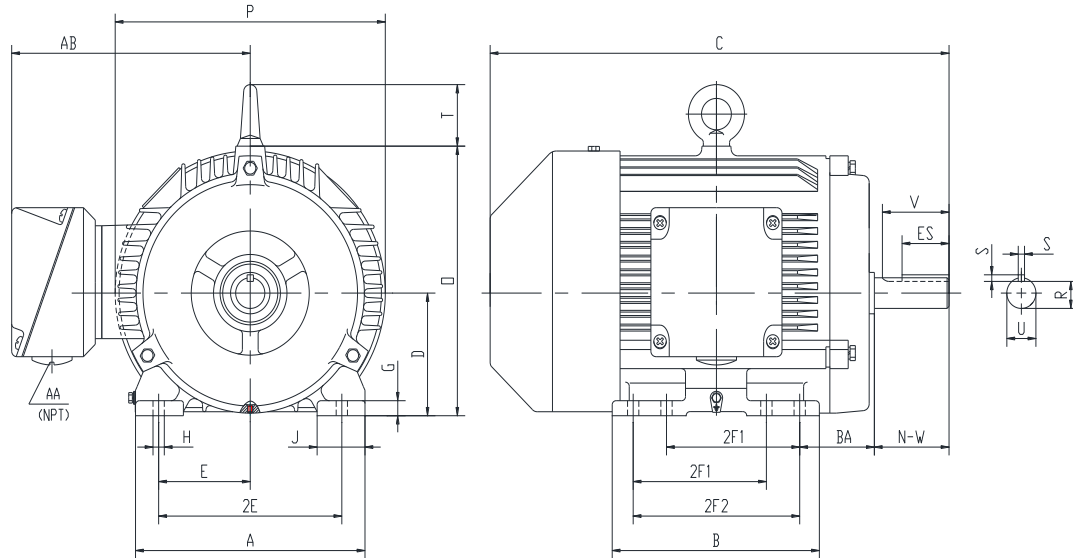

DIMENSIONS

HP	RPM	Frame	MOUNTING														
			A	B	C	D	G	H	J	E	2E	2F1	2F2	O	P	T	BA
10	1770	215T	10.5	9.37	20.7	5.25	0.7	0.41	2.16	4.25	8.5	5.5	7	11.37	11.7	1.73	3.5

Shaft Extension, Key Set						Conduit Box		Bearings		Mount
U	V	R	S	ES	N-W	AA	AB	DE	ODE	
1.375	3.12	1.201	0.312	2.41	3.38	1	9.8	6208-ZZ	6208-ZZ	F1

BEARING LUBRICATION: The bearings come lubricated with Mobil Polyrex EM Polyurea Grease.



PE215T-10-4-AI

GENERAL PURPOSE ELECTRIC MOTOR

NEMA PREMIUM EFFICIENCY

TOTALLY ENCLOSED FAN COOLED

INVERTER DUTY 10:1 CT; 20:1 VT - NEMA MG1 PART 31

Factory Certified for T2B Class I, Division II, Groups A,B,C & D and Class II, Division II, Groups F & G







PERFORMANCE DATA

HP	RPM	Frame	Voltage	Frequency (Hz)	Full Load S.F.	Insulation Class	NEMA Design	Slip (%)	NEMA Code	Enclosure Type	IP Rating	Max. Ambient
10	1750	215T	230/460	60	1.15	F	B	1.1	H	TEFC	55	40 °C

Amps (460V)		Efficiency (%)			Power Factor			Torque (ft-lb)			DE Bearing	ODE Bearing	Connection	Weight (lbs.)
FLA	LRA	100%	75%	50%	100%	75%	50%	FLT	LRT %	BDT %				
12	81	91.7	91.8	91.5	0.86	0.87	0.80	30	190	250	6208-ZZ	6208-ZZ	9 Lead 2Y/Y	196

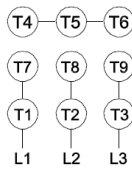
*Usable at 208 Volts

NAME PLATE

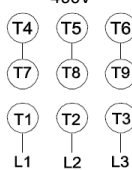
<div><div></div><div>AC INDUCTION MOTOR INVERTER DUTY 20:1 VT; 10:1 CT</div></div> <div></div>										CONNECTION DIAGRAMS			
CAT NO. PE215T-10-4-AI				FRAME 215T			PHASE 3			230V			
HZ 60		S.F. 1.15		HZ 50		S.F. 1.0		ENCL TEFC		IP 55			
HP 10		RPM 1750		HP 10		RPM 1460		DUTY CONT		DES B			
VOLTS 230/460			VOLTS 190/380			AMB 40 °C			INS F				
AMPS 24/12			AMPS 29.8/14.9			DE BRG 6208-ZZ							
CODE H		P.F. 0.86		CODE H		P.F. 0.86		ODE BRG 6208-ZZ					
EFF 91.7		MIN 90.2		EFF 91.0		MIN 89.5		LUB: Mobil Polyrex EM					
MOTOR WEIGHT 196 LBS		CONNECTION 9 Lead 2Y/Y		SER NO								460V	
<div><div><p>General purpose use on industrial machinery installed in damp, dusty or dirty environments.</p><p>Hernando, Mississippi</p></div><div><div>CC113B</div></div></div>													

APPLICATIONS:

General purpose use on pumps, fans, blowers, compressors, conveyors, material handling and other industrial machinery installed in damp, dusty or dirty environments.