



Bid Number 50-00143193

**Labor, Materials and Necessary Essentials to Perform Various
Construction Projects at the Bonnabel Pump Station Resident House**

BID DUE: September 22, 2023 AT 11:00 AM

ATTENTION VENDORS!!!

Please review all pages and respond accordingly, complying with all provisions in the technical specifications and Jefferson Parish Instructions for Bidders and General Terms and Conditions. All bids must be received on the Purchasing Department's eProcurement site, www.jeffparishbids.net, by the bid due date and time. Late bids will not be accepted.

**Jefferson Parish Purchasing Department
200 Derbigny Street
General Government Building, Suite 4400
Gretna, LA 70053
Purchasing Specialist I: Jill Truelove
Email: Jill.Truelove@jeffparish.net
Phone: 504-364-2682**

DATE: 9/13/2023

INVITATION TO BID
THIS IS NOT AN ORDER

Page: 5

BID NO.: 50-00143193

JEFFERSON PARISH

PURCHASING DEPARTMENT
P.O. BOX 9
GRETNA, LA. 70054-0009
504-364-2678

VENDOR: 27118 BLANK BID COPY VENDOR

PURCHASING SPECIALIST:
JTRUELOVE

As per LSA-RS 47:301 et seq., all governmental bodies are excluded from payment of sales taxes to any Louisiana taxing body. Quotations shall be based on F.O.B. Agency warehouse or jobsite, anywhere within the Parish as designated by the Purchasing Department.

JEFFERSON PARISH reserves the right to cancel all or any part of an order if not shipped promptly. No charges will be allowed for parking or cartage unless specified in quotation. The order must not be filled at a higher price than quoted. JEFFERSON PARISH reserves the right to cancel at any time and for any reason by issuing a THIRTY (30) day written notice to the contractor.

JEFFERSON PARISH is expecting all products to be new and all work to be done in workman-like manner, according to standard practices. Any deviations or alteration from the specifications must be indicated on the bid form for each item and upon request, product data for same must be submitted by the time specified by the Purchasing Department.

DELIVERY: FOB JEFFERSON PARISH

INDICATE DELIVERY DATE ON EQUIPMENT AND SUPPLIES

within 3 days of PO issuance

INDICATE STARTING TIME (IN DAYS) FOR CONSTRUCTION WORK immediately upon receipt of materials

INDICATE COMPLETION TIME (IN DAYS) FOR CONSTRUCTION WORK

3-4 days

In the event that addenda are issued with this bid, bidders MUST acknowledge all addenda on the bid form. Bidder must acknowledge receipt of an addendum on the bid form by placing the addendum number as indicated. Failure to acknowledge any addendum on the bid form will result in bid rejection.

Acknowledge Receipt of Addenda: NUMBER: no addenda

NUMBER: _____

NUMBER: _____

NUMBER: _____

LOUISIANA CONTRACTOR'S LICENSE NO.: (if applicable) 74904

***** ALL BIDDERS MUST COMPLETE SECTION BELOW *****

FIRM NAME:

VISIONAIRE CONSTRUCTION, LLC

SIGNATURE:

(Must be signed here)

TITLE:

OWNER/MANAGING MEMBER

PRINT OR TYPE NAME: *

GABRIEL MANSON

ADDRESS:

3413 44TH STREET

CITY, STATE:

METairie, LA

ZIP:

70001

TELEPHONE:

(504)333.1506

FAX:

(---)-----

EMAIL ADDRESS:

info@visionaireconstruction.com

TOTAL PRICE OF ALL BID ITEMS: \$ 17,400.00

INVITATION TO BID FROM JEFFERSON PARISH - continued

BID NO.: 50-00143193

SEALED BID

ITEM NUMBER	QUANTITY	U/M	DESCRIPTION OF ARTICLES	UNIT PRICE QUOTED	TOTALS
1	1.00	JOB	<p>Labor, Materials and Necessary Essentials to Perform Various Construction Projects at the Bonnabel Pump Station Resident House</p> <p>0010 LABOR, MATERIAL AND NECESSARY ESSENTIALS TO PERFORM VARIOUS CONSTRUCTION PROJECTS AT THE BONNABEL PUMP STATION RESIDENT HOUSE.</p> <p>SERVICE LOCATION: 1437 BEVERLY GARDENS DR. METAIRIE, LA 70002</p> <p>* SEE ATTACHED SPECIFICATIONS *</p> <p>*****</p> <p>FOR SITE VISITS, PLEASE CONTACT MR. CLAY LEDET, MONDAY - FRIDAY, 7:00 AM TO 3:00 PM, AT 504-838-4376 TO MAKE ARRANGEMENTS.</p> <p>*****</p>	\$ 17,400.00	\$ 17,400.00

BID # 50-00143193

Section 1.0 – Site Visit:

For a site visit please contact Clay Ledet @ 504-838-4376 between the hours of 7:00 - 3:00 to schedule a site visit at the Bonnabel Pump Station Resident House.

Section 2.0 – Scope:

We extend this bid to cover all labor, materials, and necessary equipment required to perform the various construction projects detailed in this bid at the Bonnabel Pump Station Resident House located at 1500 Beverly Garden Dr. Metairie, La. 70002.

Section 3.0 – Quantities/Inspection:

Bidders must inspect the site and perform their own measurements in order to determine the proper quantity of materials and equipment required to complete this project. All measurements given in these specifications are informational only.

Section 4.0 – License Requirements:

N/A

Section 5.0 – Bid Specifications:

Contractor will be responsible for confirming all dimensions and performing all field measurements before beginning construction.

Work to be performed includes:

- Front Porch Handrails and Stairs on West Side of House
 - Teardown existing handrails and stairs
 - Rebuild handrails (approx. 35 ft) and stairs using all new treated lumber
 - Use new composite decking for stair treads
- Cement Siding on West Side of House
 - Replace cement siding along front porch (approx. 40 ft)
 - Replace trim around cement siding using all new treated lumber (approx. 35 ft of 1x10 trim and 8 ft of 1x4 trim)
 - Replace any rotten lumber behind cement board skirting with treated 2x4's
- Back Porch on North Side of House
 - Tear down 4'x4' porch and stairs

- Replace with 8'x5' porch and new stairs using all new treated lumber
 - New porch shall utilize 2"x6" treated lumber on 16" centers
- Wrap bottom with cement board
- Use new composite decking for the stair treads and deck
- Install new handrails and front steps
- Cement Siding on North Side of House
 - Replace cement siding along West side of house (approx. 60 ft)
 - Replace trim on cement siding using all new treated lumber (approx. 60 ft of 1x4 trim)
 - Replace vent openings - three (3) 24"x24"
 - Replace any rotten lumber behind cement board skirting with treated 2x4's
- Wooden Fence on North Side of House
 - Teardown fence on North side
 - Rebuild fence using all new treated 1"x6"x6' pine
 - Install new fence 3' West from existing fence location, step in to the East 3' and turn 4' back to house (See attachment A for detailed illustration)
- Wooden Fence on South Side of House
 - Teardown fence on South Side
 - Rebuild fence using all new treated 1"x6"x6' pine
 - Install 4'6" wide gate in new fence and hardware to allow for locking
 - Confirm location of gate with resident operator before installation
 - Install new fence 5' west from existing fence location (See attachment B for detailed illustration)
- Fences, general
 - Old fence posts and concrete anchors shall be removed and the holes filled with sand
 - New fence posts shall be 2" sch. 40, hot dipped galvanized pipe
 - New fence posts shall be 8' in length, installed 2' into the ground, and anchored with 3,000 psi rated concrete
 - New fence posts shall have no more than 8' spacing on centerline of posts
 - All new fence boards shall be treated lumber
 - All new fencing shall have 3 horizontal runs of 2x4's on top – mid – bottom of fence and staggered joints
 - Only hot dipped hardware/nails and coated screws shall be used
- Use coated screws or galvanized nails for all treated lumber

Section 6.0 - Hours of Work:

Work shall be performed during normal working hours. All work must be scheduled with owner representative 5 days in advance. The successful bidder shall work

normal building working hours (8:00am – 4:00pm) to provide a safe work environment at no extra charge to Jefferson Parish.

Section 7.0 – Cleaning Area and Safety:

Job site must be clean and free of all litter and debris daily and upon completion of the project. Passageways must be kept clean and free of material, equipment, and debris at all times. All trash and debris material must be disposed of from the job site daily. Precautions must be exercised at all times to safeguard the welfare and safety of the general public, employees of Jefferson Parish, and other Parish officials.

Section 8.0 – Existing Structure

Should any cutting, patching, alteration, addition, or repairs to existing structure, wall, floor, ceiling, or part of building be required of this project, the successful bidder shall restore the alteration to its original condition, with the same type materials, finish, and workmanship.

Section 9.0 – Warranty:

All workmanship shall be done not to interfere with the existing thirty (30) year warranty in writing from the manufacturer from the date of acceptance of the project against defects. The bidder must agree, upon written notice from the owner, promptly and without charge, and to the satisfaction of the owner, to make changes, replacements, and corrections which may be required to make good all defects in materials and/or equipment under its intended use, within the warranty period, at no cost to the owner.

Section 10.0 – Permits:

The successful bidder shall obtain any and all permits required by the Jefferson Parish Department of Code Compliance and Enforcement. The successful bidder shall also be responsible for payment of these permits. All permits must be obtained prior to the start of the project.

Section 11.0 – Pre-Construction Conference, Notice to Proceed, and Construction Term:

A Pre-Construction Conference shall be held between the successful bidder and the owner before any work commences. No work shall be performed until the successful

bidder receives a written “Notice to Proceed” to begin work, from the Department of Drainage.

Upon receiving a notice to proceed, the successful bidder agrees that all work shall be completed as follows: Vendor will be given (6) weeks after the purchase order has been issued to complete all work.

Attachment A – North Side Fence

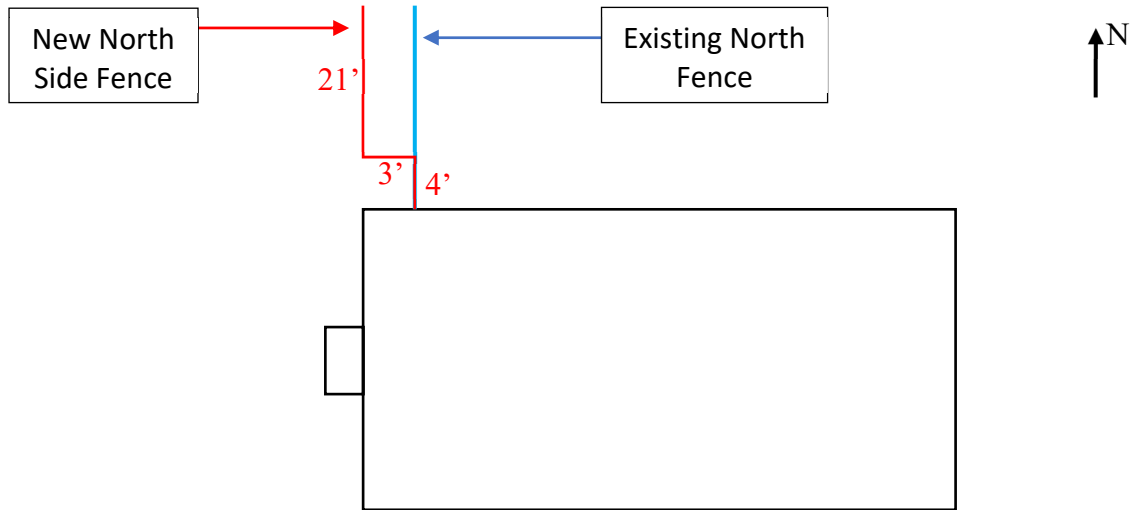

Attachment B – South Side Fence

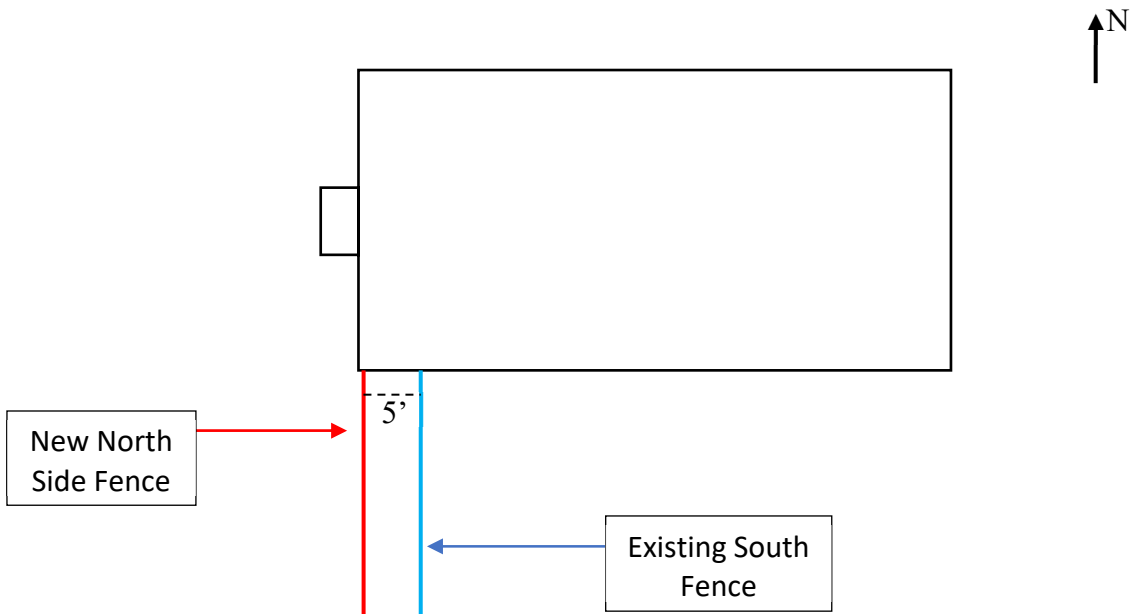



CERTIFICATE OF LIABILITY INSURANCE

DATE (MM/DD/YYYY)
02/28/2023

THIS CERTIFICATE IS ISSUED AS A MATTER OF INFORMATION ONLY AND CONFERS NO RIGHTS UPON THE CERTIFICATE HOLDER. THIS CERTIFICATE DOES NOT AFFIRMATIVELY OR NEGATIVELY AMEND, EXTEND OR ALTER THE COVERAGE AFFORDED BY THE POLICIES BELOW. THIS CERTIFICATE OF INSURANCE DOES NOT CONSTITUTE A CONTRACT BETWEEN THE ISSUING INSURER(S), AUTHORIZED REPRESENTATIVE OR PRODUCER, AND THE CERTIFICATE HOLDER.

IMPORTANT: If the certificate holder is an **ADDITIONAL INSURED**, the policy(ies) must have **ADDITIONAL INSURED** provisions or be endorsed. If **SUBROGATION IS WAIVED**, subject to the terms and conditions of the policy, certain policies may require an endorsement. A statement on this certificate does not confer rights to the certificate holder in lieu of such endorsement(s).

PRODUCER	Simply Business 1 Beacon Street 15th Floor Boston, MA 02108	CONTACT NAME:	Simply Business		
		PHONE (A/C, No, Ext):	(844) 654-7272	FAX (A/C, No):	
		E-MAIL ADDRESS:	contactus@simplybusiness.com		
		INSURER(S) AFFORDING COVERAGE		NAIC #	
		INSURER A :	Markel Insurance Company		38970
INSURED	Visionaire Construction, LLC 3413 44th St Metairie, Louisiana 70001	INSURER B :			
		INSURER C :			
		INSURER D :			
		INSURER E :			
		INSURER F :			

COVERAGES	CERTIFICATE NUMBER:	REVISION NUMBER:
-----------	---------------------	------------------

THIS IS TO CERTIFY THAT THE POLICIES OF INSURANCE LISTED BELOW HAVE BEEN ISSUED TO THE INSURED NAMED ABOVE FOR THE POLICY PERIOD INDICATED. NOTWITHSTANDING ANY REQUIREMENT, TERM OR CONDITION OF ANY CONTRACT OR OTHER DOCUMENT WITH RESPECT TO WHICH THIS CERTIFICATE MAY BE ISSUED OR MAY PERTAIN, THE INSURANCE AFFORDED BY THE POLICIES DESCRIBED HEREIN IS SUBJECT TO ALL THE TERMS, EXCLUSIONS AND CONDITIONS OF SUCH POLICIES. LIMITS SHOWN MAY HAVE BEEN REDUCED BY PAID CLAIMS.

INSR LTR	TYPE OF INSURANCE		ADDL INSD	SUBR WVD	POLICY NUMBER	POLICY EFF (MM/DD/YYYY)	POLICY EXP (MM/DD/YYYY)	LIMITS	
A	X	COMMERCIAL GENERAL LIABILITY	X		MKUS3892226XB	02/28/2023	02/28/2024	EACH OCCURRENCE	\$1,000,000
		CLAIMS-MADE <input checked="" type="checkbox"/> OCCUR						DAMAGE TO RENTED PREMISES (Ea occurrence)	\$100,000
								MED EXP (Any one person)	\$5,000
								PERSONAL & ADV INJURY	\$1,000,000
								GENERAL AGGREGATE	\$2,000,000
	GEN'L AGGREGATE LIMIT APPLIES PER:								
	X	POLICY <input type="checkbox"/> PRO-JECT <input type="checkbox"/> LOC						PRODUCTS - COMP/OP AGG	\$2,000,000
		OTHER:							
	AUTOMOBILE LIABILITY							COMBINED SINGLE LIMIT (Ea accident)	
		ANY AUTO						BODILY INJURY (Per person)	
		OWNED AUTOS ONLY						BODILY INJURY (Per accident)	
		HIRED AUTOS ONLY						PROPERTY DAMAGE (Per accident)	
		SCHEDULED AUTOS							
		NON-OWNED AUTOS ONLY							
	UMBRELLA LIAB							EACH OCCURRENCE	
		OCCUR						AGGREGATE	
	EXCESS LIAB								
		CLAIMS-MADE							
	DED	RETENTION							
	WORKERS COMPENSATION AND EMPLOYERS' LIABILITY							PER STATUTE	OTH-ER
	ANY PROPRIETOR/PARTNER/EXECUTIVE		Y/N					E.L. EACH ACCIDENT	
	OFFICER/MEMBER EXCLUDED? (Mandatory in NH)			N/A				E.L. DISEASE - EA EMPLOYEE	
	If yes, describe under DESCRIPTION OF OPERATIONS below							E.L. DISEASE - POLICY LIMIT	
	PROFESSIONAL LIABILITY							EACH CLAIM	
								AGGREGATE	

DESCRIPTION OF OPERATIONS / LOCATIONS / VEHICLES (ACORD 101, Additional Remarks Schedule, may be attached if more space is required)

CERTIFICATE HOLDER	CANCELLATION
	SHOULD ANY OF THE ABOVE DESCRIBED POLICIES BE CANCELLED BEFORE THE EXPIRATION DATE THEREOF, NOTICE WILL BE DELIVERED IN ACCORDANCE WITH THE POLICY PROVISIONS.
	AUTHORIZED REPRESENTATIVE



CERTIFICATE OF LIABILITY INSURANCE

DATE (MM/DD/YYYY)

08/08/23

THIS CERTIFICATE IS ISSUED AS A MATTER OF INFORMATION ONLY AND CONFERS NO RIGHTS UPON THE CERTIFICATE HOLDER. THIS CERTIFICATE DOES NOT AFFIRMATIVELY OR NEGATIVELY AMEND, EXTEND OR ALTER THE COVERAGE AFFORDED BY THE POLICIES BELOW. THIS CERTIFICATE OF INSURANCE DOES NOT CONSTITUTE A CONTRACT BETWEEN THE ISSUING INSURER(S), AUTHORIZED REPRESENTATIVE OR PRODUCER, AND THE CERTIFICATE HOLDER.

IMPORTANT: If the certificate holder is an ADDITIONAL INSURED, the policy(ies) must have ADDITIONAL INSURED provisions or be endorsed. If SUBROGATION IS WAIVED, subject to the terms and conditions of the policy, certain policies may require an endorsement. A statement on this certificate does not confer rights to the certificate holder in lieu of such endorsement(s).

PRODUCER	CONTACT NAME:
AMERICA'S COMMERCIAL AGENCY	PHONE (A/C, No, Ext): (972)248-6492
5916 Willow Wood Lane	FAX (A/C, No):
Dallas, TX 75252	E-MAIL ADDRESS: acaagency@sbcglobal.net
License #:	INSURER(S) AFFORDING COVERAGE
INSURED	INSURER A: MARKEL INSURANCE
VISIONAIRE CONSTRUCTION LLC	INSURER B: INFINITY INS
3413 44TH STREET	INSURER C:
METAIRIE, LA 70001	INSURER D:
	INSURER E:
	INSURER F:

COVERAGES

CERTIFICATE NUMBER:

REVISION NUMBER:

THIS IS TO CERTIFY THAT THE POLICIES OF INSURANCE LISTED BELOW HAVE BEEN ISSUED TO THE INSURED NAMED ABOVE FOR THE POLICY PERIOD INDICATED. NOTWITHSTANDING ANY REQUIREMENT, TERM OR CONDITION OF ANY CONTRACT OR OTHER DOCUMENT WITH RESPECT TO WHICH THIS CERTIFICATE MAY BE ISSUED OR MAY PERTAIN, THE INSURANCE AFFORDED BY THE POLICIES DESCRIBED HEREIN IS SUBJECT TO ALL THE TERMS, EXCLUSIONS AND CONDITIONS OF SUCH POLICIES. LIMITS SHOWN MAY HAVE BEEN REDUCED BY PAID CLAIMS.

INSR LTR	TYPE OF INSURANCE	ADDL INSD	SUBR WVD	POLICY NUMBER	POLICY EFF (MM/DD/YYYY)	POLICY EXP (MM/DD/YYYY)	LIMITS
	COMMERCIAL GENERAL LIABILITY						EACH OCCURRENCE
	CLAIMS-MADE						DAMAGE TO RENTED PREMISES (Ea occurrence)
							MED EXP (Any one person)
							PERSONAL & ADV INJURY
	GEN'L AGGREGATE LIMIT APPLIES PER:						GENERAL AGGREGATE
	POLICY						PRODUCTS - COMP/OP AGG
	PRO-JECT						
	LOC						
	OTHER:						
B	AUTOMOBILE LIABILITY			AU072121-1	073123	073124	COMBINED SINGLE LIMIT (Ea accident)
	ANY AUTO						
	OWNED AUTOS ONLY						BODILY INJURY (Per person)
	HIRED AUTOS ONLY						BODILY INJURY (Per accident)
	SCHEDULED AUTOS						PROPERTY DAMAGE (Per accident)
	NON-OWNED AUTOS ONLY						
	UMBRELLA LIAB						EACH OCCURRENCE
	EXCESS LIAB						AGGREGATE
	DED						
	RETENTION \$						
A	WORKERS COMPENSATION AND EMPLOYERS' LIABILITY			WC042722-2	070123	070124	PER STATUTE
	ANY PROPRIETOR/PARTNER/EXECUTIVE OFFICER/MEMBER EXCLUDED? (Mandatory in NH)	Y/N					OTH-ER
	If yes, describe under DESCRIPTION OF OPERATIONS below	N	N/A				E.L. EACH ACCIDENT
							E.L. DISEASE - EA EMPLOYEE
							E.L. DISEASE - POLICY LIMIT

DESCRIPTION OF OPERATIONS / LOCATIONS / VEHICLES (ACORD 101, Additional Remarks Schedule, may be attached if more space is required)

CERTIFICATE HOLDER

CANCELLATION

SHOULD ANY OF THE ABOVE DESCRIBED POLICIES BE CANCELLED BEFORE THE EXPIRATION DATE THEREOF, NOTICE WILL BE DELIVERED IN ACCORDANCE WITH THE POLICY PROVISIONS.

AUTHORIZED REPRESENTATIVE

© 1988-2015 ACORD CORPORATION. All rights reserved.

CORPORATE RESOLUTION

EXCERPT FROM MINUTES OF MEETING OF THE BOARD OF DIRECTORS OF
VISIONAIRE CONSTRUCTION, LLC

INCORPORATED.

AT THE MEETING OF DIRECTORS OF VISIONAIRE CONSTRUCTION, LLC
INCORPORATED, DULY NOTICED AND HELD ON 09/19/2023,
A QUORUM BEING THERE PRESENT, ON MOTION DULY MADE AND SECONDED. IT
WAS:

RESOLVED THAT GABRIEL MANSON, BE AND IS HEREBY
APPOINTED, CONSTITUTED AND DESIGNATED AS AGENT AND ATTORNEY-IN-
FACT OF THE CORPORATION WITH FULL POWER AND AUTHORITY TO ACT ON
BEHALF OF THIS CORPORATION IN ALL NEGOTIATIONS, BIDDING, CONCERNS
AND TRANSACTIONS WITH THE PARISH OF JEFFERSON OR ANY OF ITS AGENCIES,
DEPARTMENTS, EMPLOYEES OR AGENTS, INCLUDING BUT NOT LIMITED TO, THE
EXECUTION OF ALL BIDS, PAPERS, DOCUMENTS, AFFIDAVITS, BONDS, SURETIES,
CONTRACTS AND ACTS AND TO RECEIVE ALL PURCHASE ORDERS AND NOTICES
ISSUED PURSUANT TO THE PROVISIONS OF ANY SUCH BID OR CONTRACT, THIS
CORPORATION HEREBY RATIFYING, APPROVING, CONFIRMING, AND ACCEPTING
EACH AND EVERY SUCH ACT PERFORMED BY SAID AGENT AND ATTORNEY-IN-
FACT.

I HEREBY CERTIFY THE FOREGOING TO BE
A TRUE AND CORRECT COPY OF AN
EXCERPT OF THE MINUTES OF THE ABOVE
DATED MEETING OF THE BOARD OF
DIRECTORS OF SAID CORPORATION, AND
THE SAME HAS NOT BEEN REVOKED OR
RESCINDED.



SECRETARY-TREASURER

09/19/2023

DATE



State Licensing Board for Contractors

This is to Certify that:

VISIONAIRE CONSTRUCTION LLC
4924 Trenton St
Metairie, LA 70006

is duly licensed and entitled to practice the following classifications

BUILDING CONSTRUCTION; SPECIALTY: PAINTING, COATING AND BLASTING (INDUSTRIAL AND COMMERCIAL); SPECIALTY: ROOFING AND SHEET METAL, SIDING



Expiration Date: September 13, 2024

License No: 74904

Witness our hand and seal of the Board dated,
Baton Rouge, LA 14th day of September 2023

Director

Chairman

Treasurer

This License Is Not Transferrable