



CENTRALBIDDING
FROM CENTRAL AUCTION HOUSE

**5000146343 Two Year Contract for a Supply of Ductile Iron Fittings and
Adapter Kits for the Jefferson Parish Department of Public Works- Water
and all Jefferson Parish Agencies and Municipalities
Jefferson Parish Government**

Project documents obtained from www.CentralBidding.com

23-Oct-2024 10:46:31 AM



Bid Number 50-00146343

Two Year Contract for a Supply of Ductile Iron Fittings and Adapter Kits for the Jefferson Parish Department of Public Works- Water and all Jefferson Parish Agencies and Municipalities

Bid Due: November 07, 2024 at 2:00 pm

ATTENTION VENDORS!!!

Please review all pages and respond accordingly, complying with all provisions in the technical specifications and Jefferson Parish Instructions for Bidders and General Terms and Conditions. All bids must be received on the Purchasing Department's eProcurement site by the bid due date and time.

**Jefferson Parish Purchasing Department
200 Derbigny Street
General Government Building, Suite 4400
Gretna, LA 70053**

**Purchasing Specialist Name: Donna M Evans, Purchasing Specialist II
Purchasing Specialist Email: donna.evans@jeffparish.gov
Purchasing Specialist Phone: 504-364-2691**

DATE: 10/23/2024
BID NO.: 50-00146343

INVITATION TO BID
THIS IS NOT AN ORDER

Page: 1

JEFFERSON PARISH

PURCHASING DEPARTMENT
P.O. BOX 9
GRETN, LA. 70054-0009
504-364-2678

PURCHASING SPECIALIST:
DMEVANS@jeffparish.net

BIDS WILL BE RECEIVED ONLINE VIA WWW.JEFFPARISHBIDS.NET UNTIL 2:00 PM, 11/07/2024 AND PUBLICLY OPENED THEREAFTER IN THE WEST BANK PURCHASING DEPT, SUITE 4400, JEFFERSON PARISH GENERAL GOVERNMENT BUILDING, 200 DERBIGNY STREET, GRETN, LA 70053. At no charge, bidders are to submit via Jefferson Parish's electronic procurement page by visiting www.jeffparishbids.net to register for this free site. Additional instructions are included in the text box highlighting electronic procurement.

LATE BIDS WILL NOT BE ACCEPTED

NOTE: ONLY BIDS WRITTEN IN INK OR TYPEWRITTEN, AND PROPERLY SIGNED BY A MEMBER OF THE FIRM OR AUTHORIZED REPRESENTATIVE, WILL BE ACCEPTED. PENCIL AND/OR PHOTOSTATIC FIGURES OR SIGNATURES SHALL RESULT IN BID REJECTION. HOWEVER, ELECTRONIC SIGNATURES AS DEFINED IN LSA - R.S. 9:2620(8) ARE ACCEPTABLE. SIGNATURE MUST BE A SECURED DIGITAL SIGNATURE AND MUST PROVIDE PROOF OF THE SECURED SIGNATURE WITH BID SUBMISSION.

INSTRUCTIONS FOR BIDDERS AND GENERAL CONDITIONS
THE FOLLOWING INSTRUCTIONS APPLY TO ALL BIDS

All bids submitted are subject to these instructions and general conditions and any special conditions and specifications contained herein, all of which are made part of this bid proposal reference. By submitting a bid, vendor agrees to comply with all provisions of Louisiana Law as well be in compliance with the Jefferson Parish Code of Ordinances, Louisiana Code of Ethics, applicable Jefferson Parish ethical standards and Jefferson Parish Resolution No. 136353 and/or Resolution No. 141125 as amended.

Jefferson Parish adheres to the Louisiana Code of Governmental Ethics, contained in Louisiana Revised Statutes Annotated, R.S. 42:1101, et seq. Vendor/Proposer by this submission, warrants that there are no "conflicts of interest" related to this procurement that would violate applicable Louisiana Law. Violation of the Louisiana Code of Governmental Ethics may result in rescission of contract, permit or licenses, and the imposition of fines and/or penalties, without contractual liability to the public in accordance with applicable law.

All vendors submitting bids should register as a Jefferson Parish vendor if not already yet registered. Registration forms may be downloaded from <http://www.jeffparish.gov/464/Purchasing> and by clicking on Vendor Information. Current W-9 forms with respective Tax Identification numbers and vendor applications may be submitted at any time; however, if your company is not registered and/or a current W-9 form is not on file, vendor registration is mandatory. Vendors may experience a delay in payment if your company is not a registered vendor with Jefferson Parish.

All quotations shall be based on F.O.B. Agency warehouse or job site, anywhere within the Parish as designated by the Purchasing Department. This provision does not apply to public works projects

JEFFERSON PARISH requires all products to be new (current) and all work must be performed according to standard practices for the project. Unless otherwise specified, no aftermarket parts will be accepted. Unless otherwise specified, all workmanship and materials must have at least one (1) year guaranty, in writing, from the date of delivery and/or acceptance of the project. Any deviations or alterations from the specifications must be indicated and/or supporting documentation supplied with bid submission.

Bidders should submit all questions in writing via email to the Purchasing Specialist's email address as indicated above, no later than Five (5) working days prior to the bid opening. Bid numbers should be mentioned in all requests. If submitting online, vendors may send questions via the E-Procurement site no later than Five (5) working days prior to the bid opening.

If this bid requires a pre-bid conference (see Additional Requirements section), bidders are advised that such conference will be held to allow bidders the opportunity to identify any discrepancies in the bid specifications and seek further clarification regarding instructions. The Purchasing Department will issue a written response to bidders' questions in the form of an Addendum. Please note that all official communication will be expressed in the form of an addendum.

Visit our website at [HTTP://WWW.JEFFPARISH.GOV/464/PURCHASING](http://WWW.JEFFPARISH.GOV/464/PURCHASING)

All formal Addenda require written acknowledgement on the bid form by the bidder. Failure to acknowledge any Addendum on the bid form shall cause the bid to be rejected. JEFFERSON PARISH reserves the right to award bid to next lowest responsive and responsible bidder in this event.

JEFFERSON PARISH will accept one price for each item unless otherwise indicated. Two or more prices for one item will result in bid rejection. Bidders are required to complete, sign and return the bid form and/or complete and return the associated line item pricing forms as indicated. Vendors must not alter the bid forms. Doing so will cause the bid to be rejected.

A corporate resolution or written evidence of the individual signing the bid having such authority must be submitted with the bid. Failure to comply will cause bid to be rejected. For corporate entities, such written evidence may be a printout of the Louisiana Secretary of State's website listing the signatory as an officer. Such printout shall be included with the bid submission. Bids submitted by Owners or Sole Proprietorships must include certification that he or she owns the entity for which the bid is signed. This documentation must be submitted with the bid. Failure to do so will result in bid rejection.

NOTE: A sample corporate resolution can be downloaded from our website <http://www.jeffparish.gov/464/Purchasing> or you may provide your own document. A sample certification of sole proprietorship can also be downloaded from our website <http://www.jeffparish.gov/464/Purchasing> or you may provide your own document.

INSTRUCTIONS FOR BIDDERS AND GENERAL CONDITIONS

A. AWARD OF CONTRACT: JEFFERSON PARISH reserves the right to award contracts or place orders on a lump sum or individual item basis, or such combination, as shall in its judgment be in the best interest of JEFFERSON PARISH. Every contract or order shall be awarded to the LOWEST RESPONSIVE and RESPONSIBLE BIDDER, taking into consideration the CONFORMITY WITH THE SPECIFICATIONS and the DELIVERY AND/OR COMPLETION DATE. SPLIT AWARDS MADE TO SEVERAL VENDORS WILL ONLY BE GRANTED TO THOSE DEEMED RESPONSIVE AND RESPONSIBLE.

All bid prices shall remain valid for 45 days. Jefferson Parish and the lowest responsive and responsible bidder(s) by mutual written consent may mutually agree to extend the deadline for award by one (1) or more extensions of thirty (30) calendar days.

PROTESTS: Only those vendors that submit bids in response to this solicitation may protest any element of the procurement, in writing to the Director of the Purchasing Department. Written protest must be received within 48 hours of the release of the bid tabulation by the Purchasing Department. After consultation, the Parish Attorney's Office will then respond to protests in writing. (For more information, please see Chapter 2, Article VII, Division 2, Sec. 2-914.1 of the Jefferson Parish Code of Ordinances.)

PREFERENCE: Unless federal funding is directly spent by Jefferson Parish for this purchase, preference is hereby given to materials, supplies, and provisions produced, manufactured or grown in Louisiana, quality being equal to articles offered by competitors outside the state. "LSA – R.S. 38:2251-2261"

B. USE OF BRAND NAMES AND STOCK NUMBERS: Where brand names and stock numbers are specified, it is for the purpose of establishing certain minimum standards of quality. Bids may be submitted for products of equal quality, provided brand names and stock numbers are specified. Complete product data may be required prior to award.

C. CANCELLATION OF CONTRACT: JEFFERSON PARISH reserves the right to cancel all or any part if not shipped promptly. No charges will be allowed for parking or cartage unless specified in quotation. The order must not be filled at a higher price than quoted. JEFFERSON PARISH reserves the right to cancel any contract at anytime and for any reason by issuing a THIRTY (30) day written notice to the contractor.

For good cause and as consideration for executing a contract with Jefferson Parish, vendor conveys, sells, assigns and transfers to Jefferson Parish or its assigns all rights, title and interest in and to all causes of action it may now or hereafter acquire under the antitrust laws of the United States and the State of Louisiana, relating to the particular good or services purchased or acquired by Jefferson Parish.

D. PRICES: Jefferson Parish is exempt from paying sales tax under LSA-R.S. 47:301 (8)(c). All prices for purchases by Jefferson Parish of supplies and materials shall be quoted in the unit of measure specified and unless otherwise specified, shall be exclusive of state and local taxes. The price quoted for work shall be stated in figures. In the event there is a difference in unit prices and totals, the unit price shall prevail.

Quantities listed are for bidding purposes only. Actual requirements may be more or less than quantities listed.

Bidders are not to exclude from participation in, deny the benefits of, or subject to discrimination under any program or activity, any person in the United States on the grounds of race, color, national origin, or sex; nor discriminate on the basis of age under the Age Discrimination Act of 1975, or with respect to an otherwise qualified handicapped individual as provided in Section 504 of the Rehabilitation Act of 1973, or on the basis of religion, except that any exemption from such prohibition against discrimination on the basis of religion as provided in the Civil Rights Act of 1964, or Title VI and VII of the Act of April 11, 1968, shall also apply. This assurance includes compliance with the administrative requirements of the Revenue Sharing final handicapped discrimination provisions contained in Section 51.55 (c), (d), (e), and (k)(5) of the Regulations. New construction or renovation projects must comply with Section 504 of the 1973 Rehabilitation Act, as amended, in accordance with the American National Standard Institute's specifications (ANSI A17.1-1961).

INSTRUCTIONS FOR BIDDERS AND GENERAL CONDITIONS

Jefferson Parish and its partners as the recipients of federal funds are fully committed to awarding a contract(s) to firm(s) that will provide high quality services and that are dedicated to diversity and to containing costs. Thus, Jefferson Parish strongly encourages the involvement of minority and/or woman-owned business enterprises (DBE's, including MBE's, WBE's and SBE's) to stimulate participation in procurement and assistance programs.

The purpose and intention of this invitation to bid is to afford all suppliers an equal opportunity to bid on all construction, maintenance, repair, operating supplies and/or equipment listed in this bid proposal. JEFFERSON PARISH WILL ACCEPT ONE BID ONLY FROM EACH VENDOR. Items bid must meet specifications.

Advertised bids will be tabulated and a copy of the tabulation will be forwarded to each responding bidder.

IN ACCORDANCE WITH STATE REGULATIONS JEFFERSON PARISH OFFERS ELECTRONIC PROCUREMENT TO ALL VENDORS

This electronic procurement system allows vendors the convenience of reviewing and submitting bids online. This is a secure site and authorized personnel have limited read access only. Bidders are to submit electronically using this free service; while the website accepts various file types, one single PDF file containing all appropriate and required bid documents is preferred. Bidders submitting uploaded images of bid responses are solely responsible for clarity. If uploaded images/documents are not legible, then bidder's submission will be rejected. Please note all requirements contained in this bid package for electronic bid submission.

Please visit our E-Procurement Page at www.jeffparishbids.net to register and view Jefferson Parish solicitations. For more information, please visit the Purchasing Department page at <http://www.jeffparish.gov/464/Purchasing>.

The general specifications for construction projects and the purchase of materials, services and/or supplies are those adopted by the JEFFERSON PARISH Council by Resolution No. 136353 or 141125 as amended. The general conditions adopted by this resolution shall be considered as much a part of this document as if they were written wholly herein. A copy may be obtained from the Office of the Parish Clerk, Suite 6700, Jefferson Parish General Government Building, 200 Derbigny Street, Gretna, LA 70053. You may also obtain a copy by visiting the Purchasing Department webpage at <http://www.jeffparish.gov/464/Purchasing> and clicking on Online Forms.

ADDITIONAL REQUIREMENTS FOR THIS BID

PLEASE MATCH THE NUMBERS PRINTED IN THIS BOX WITH THE CORRESPONDING INSTRUCTIONS BELOW. IF THE NUMBER IS NOT SPECIFIED IN THIS BOX, IT IS NOT APPLICABLE FOR THIS BID.

10, 12, 13, 15

1. All bidders must attend the MANDATORY pre-bid conference and will be required to sign in and out as evidence of attendance. In accordance with LSA R.S. 38:2212(1), all prospective bidders shall be present at the beginning of the MANDATORY pre-bid conference and shall remain in attendance for the duration of the conference. Any prospective bidder who fails to attend the conference or remain for the duration shall be prohibited from submitting a bid for the project.
2. Attendance to this pre-bid conference is optional. However, failure to attend the pre-bid conference shall not relieve the bidder of responsibility for information discussed at the conference. Furthermore, failure to attend the pre-bid conference and inspection does not relieve the successful bidder from the necessity of furnishing materials or performing any work that may be required to complete the work in accordance with the specification with no additional cost to the owner.
3. Contractor must hold current applicable JEFFERSON PARISH licenses with the Department Building Permits. Contractor shall obtain any and all permits required by the JEFFERSON PARISH Department of Building Permits. The contractor shall be responsible for the payment of these permits. All permits must be obtained prior to the start of the project. Contractor must also hold any and all applicable municipality, Federal and State licenses. Contractor shall be responsible for the payment of these permits and shall obtain them prior to the start of the project.

INSTRUCTIONS FOR BIDDERS AND GENERAL CONDITIONS

4. A LA State Contractor's License will be required in accordance with LSA R.S. 37-2150 et. seq. and such license number will be shown on the outside of the bid electronic envelope. Failure to comply will cause the bid to be rejected. When submitting the bid electronically, the license number must be entered in the appropriate field in the electronic procurement system. Failure to comply will cause the bid to be rejected.
5. It is the bidder's responsibility to visit the job site and evaluate the job before submitting a bid.
6. Job site must be clean and free of all litter and debris daily and upon completion of the contract. Passageways must be kept clean and free of material, equipment, and debris at all times. Flammable material must be removed from the job site daily because storage will not be permitted on the premises. Precaution must be exercised at all times to safeguard the welfare of JEFFERSON PARISH and the general public.
7. PUBLIC WORKS BIDS: All awards for public works in excess of \$5,000.00 will be reduced to a formal contract which shall be recorded at the contractor's expense with the Clerk of Court and Ex-Officio Recorder of Mortgages for the Parish of Jefferson. A price list of recordation costs may be obtained from the Clerk of Court and Ex-Officio Recorder of Mortgages for the Parish of Jefferson. All awards in excess of \$25,000.00 will require both a performance and a payment bond. Unless otherwise stated in the bid specifications, the performance bond requirements shall be 100% of the contract price. Unless otherwise stated in the bid specifications, the payment bond requirements shall be 100% of the contract price. Both bonds shall be supplied at the signing of the contract.
8. NON-PUBLIC WORKS BIDS: A performance bond will be required for this bid. The amount of the bond will be 100% of the contract price unless otherwise indicated in the specifications. The performance bond shall be supplied at the signing of the contract.
9. NON-PUBLIC WORKS BIDS: A payment bond will be required for this bid. The amount of the bond will be 100% of the contract price unless otherwise indicated in the specifications. The payment bond shall be supplied at the signing of the contract.
10. All bidders must comply with the requirements stated in the attached "Standard Insurance Requirements" sheet attached to this bid solicitation. Any deviation from the Standard Insurance Requirements must be requested in writing prior to bid opening. Written approval for any deviation, must be submitted with your bid submission. Failure to comply with this instruction will result in bid rejection.
11. A bid bond will be required with bid submission in the amount of 5% of the total bid, unless otherwise stated in the bid specifications. All sureties must be in original format (no copies) When submitting a bid online, vendors must submit an electronic bid bond through the respective online clearinghouse bond management system(s) as indicated in the electronic bid solicitation on Central Auction House. No scanned paper copies of any bid bond will be accepted as part of the electronic bid submission.
12. This is a requirements contract to be provided on an as needed basis. JEFFERSON PARISH makes no representations on warranties with regard to minimum guaranteed quantities unless otherwise stated in the bid specifications.
13. Freight charges should be included in total cost when quoting. If not quoted FOB DELIVERED, freight must be quoted as a separate item. Bid may be rejected if not quoted FOB DELIVERED or if freight charges are not indicated on bid form.
14. PUBLIC WORKS BIDS - Completed, Signed and Properly Notarized Affidavits Required; This applies to all solicitations for construction, alteration or demolition of public buildings or projects, in conformity with the provisions contained in LSA-RS 38:2212.9, LSA-RS 38:2212.10, LSA-RS 38:2224, and Sec 2-923.1 of the Jefferson Parish Code of Ordinances. For bidding purposes, all bidders must submit with bid submission COMPLETED, SIGNED and PROPERLY NOTARIZED Affidavits, including: Non-Conviction Affidavit, Non-Collusion Affidavit, Campaign Contribution Affidavit, Debt Disclosures Affidavit and E-Verify Affidavit. For the convenience of vendors, all affidavits have been combined into one form entitled PUBLIC WORKS BID AFFIDAVIT. This affidavit must be submitted in its original format, and without material alteration, in order to be compliant and for the bid to be considered responsive. A scanned copy of the completed, signed and properly notarized affidavit may be submitted with the bid, however, the successful bidder must submit the original affidavit in its original format and without material alteration upon contract execution. Failure to comply will result in the bid submission being rejected as non-responsive. The Parish reserves the right to award bid to the next lowest responsive and responsible bidder in this event.

INSTRUCTIONS FOR BIDDERS AND GENERAL CONDITIONS

15. NON PUBLIC WORK BIDS - Completed, Signed and Properly Notarized Affidavits Required in conformity with the provisions contained in LSA – RS 38:2224 and Sec 2-923.1 of the Jefferson Parish Code of Ordinances. For bidding purposes, all bidders must submit with bid submission COMPLETED, SIGNED and PROPERLY NOTARIZED Affidavits, including: Non-Collusion Affidavit, Debt Disclosures Affidavit and Campaign Contribution Affidavit. For the convenience of vendors, all affidavits have been combined into one form entitled NON PUBLIC WORKS BID AFFIDAVIT. This affidavit must be submitted in its original format, and without material alteration, in order to be compliant and for the bid to be considered responsive. A scanned copy of the completed, signed and properly notarized affidavit may be submitted with the bid, however, the successful bidder must submit the original affidavit in its original format and without material alteration upon contract execution. Failure to comply will result in the bid submission being rejected as non-responsive. The Parish reserves the right to award bid to the next lowest responsive and responsible bidder in this event.

16. The ensuing contract for this bid solicitation may be eligible for FEMA reimbursement and/or Federal funding/reimbursement. As such, the referenced appendix will be applicable accordingly and shall be considered a part of the bid documents. All applicable certifications must be duly completed, signed and submitted as per the appendix instructions. Failure to submit applicable certifications per the appendix instructions will result in bid rejection.

17. For this project, the Contractor shall not pay any state or local sales or use taxes on materials and equipment which are affixed and made part of the immovable property of the project or which is permanently incorporated in the project (hereinafter referred to as "applicable materials and equipment."). All purchases of applicable materials or equipment shall be made by the contractor on behalf of and as the agent of Jefferson Parish (Owner), a political subdivision of the State of Louisiana. No state and local sales and use taxes are owed on applicable materials and equipment under the provisions of Act 1029 of the 1991 Regular Session - Louisiana Revised Statute 47:301(8)(c). Owner will furnish to contractor a certificate form which certifies that Owner is not required to pay such state or local sales and use taxes, and contractor shall furnish a copy of such certificate to all vendors or suppliers of the applicable materials and equipment, and report to Owner the amount of taxes not incurred.

It shall be the duty of every parish officer, employee, department, agency, special district, board, and commission; and the duty of every contractor, subcontractor, and licensee of the parish, and the duty of every applicant for certification of eligibility for a parish contract or program, to cooperate with the Inspector General in any investigation, audit, inspection, performance review, or hearing pursuant to JPCO 2-155.10(19). By signing this document, every corporation, partnership, or person contracting with PARISH, whether by cooperative endeavor, intergovernmental agreement, bid, proposal, application or solicitation for a parish contract, and every application for certification of eligibility for a parish contract or program, attests that it understands and will abide by all provisions of JPCO 2-155.10.

BID FORM
Non Public Works

All Public Work Projects are required to use the Louisiana Uniform Public Work Bid Form

All prices must be held firm unless an escalation provision is requested in this bid. Jefferson Parish will allow one escalation during the term of the contract, which may not exceed the U.S. Bureau of Labor Statistics National Index for all Urban Consumers, unadjusted 12 month figure. The most recently published figure issued at the time an adjustment is requested will be used. A request must be made in writing by the vendor, and the escalation will only be applied to purchases made after the request is made.

Are you requesting an escalation provision?

YES _____ NO ☒

MAXIMUM ESCALATION PERCENTAGE REQUESTED _____ %

INITIAL BID PRICES WILL REMAIN FIRM THROUGH THE DATE OF _____.

For the purposes of comparison of bids when an escalation provision is requested, Jefferson Parish will apply the maximum escalation percentage quoted by the bidder to the period to which it is applied in the bid. The initial price and the escalation will be used to calculate the total bid price. It will be assumed, for comparison of prices only, that an equal amount of material or labor is purchased each month throughout the entire contract.

DELIVERY: FOB JEFFERSON PARISH

STOCK - 4 WEEKS ARO

INDICATE DELIVERY DATE ON EQUIPMENT AND SUPPLIES _____

LOUISIANA CONTRACTOR'S LICENSE NO.: (if applicable) _____

THIS SECTION MUST BE COMPLETED BY BIDDER:

FIRM NAME: CIMSCO, INC.

ADDRESS: 1840 L&A RD.

CITY, STATE: METAIRIE, LA ZIP: 70001

TELEPHONE: () 504-835-7319 FAX: () 504-832-0820

EMAIL ADDRESS: HUNTER@CIMSCOINC.COM

In the event that addenda are issued with this bid, bidders MUST acknowledge all addenda on the bid form. Bidder must acknowledge receipt of an addendum on the bid form by placing the addendum number as indicated. Failure to acknowledge any addendum on the bid form will result in bid rejection.

Acknowledge Receipt of Addenda: NUMBER: _____

NUMBER: _____

NUMBER: _____

NUMBER: _____

TOTAL PRICE OF ALL BID ITEMS: \$ 639,064.00

AUTHORIZED
SIGNATURE: 

HUNTER BURGESS

Printed Name

TITLE: SALESMAN

SIGNING INDICATES YOU HAVE READ AND COMPLY WITH THE INSTRUCTIONS AND CONDITIONS.

NOTE: All bids should be returned with the BID NUMBER and BID OPENING DATE indicated on the outside of the envelope submitted to the Purchasing Department.

INVITATION TO BID FROM JEFFERSON PARISH - continued

BID NO.: 50-00146343

SEALED BID

ITEM NUMBER	QUANTITY	U/M	DESCRIPTION OF ARTICLES	UNIT PRICE QUOTED	TOTALS
1	2.00	EA	<p>TWO YEAR CONTRACT FOR A SUPPLY OF DUCTILE IRON FITTINGS AND ADAPTER KITS FOR THE JEFFERSON PARISH DEPARTMENT OF PUBLIC WORKS- WATER AD ALL JEFFESON PARISH AGENCIES AND MUNCIPALITIES</p> <p>0010 MECHANICAL JOINT SOLID REPAIR SLEEVES 3 INCH (LONG BODY)</p> <p>GROUP 1</p> <p>ENGINEERING DEPT.-CHANEN JOSEPH (FOR EB & WB WAREHOUSE)</p>	\$ 77.00	\$ 154.00
2	2.00	EA	<p>TWO (2) YEAR CONTRACT FOR A SUPPLY OF DUCTILE IRON FITTINGS AND ADAPTER KITS FOR THE JEFFERSON PARISH DEPARTMENT OF PUBLIC WORKS - WATER AND ALL JEFFERSON PARISH AGENCIES AND MUNICIPALITIES</p> <p>0030 MECHANICAL JOINT SOLID REPAIR SLEEVES 4 INCH (LONG BODY) (10001A)</p> <p>GROUP 1</p>	\$ 76.00	\$ 152.00
3	2.00	EA	<p>0040 MECHANICAL JOINT SOLID REPAIR SLEEVES 4 INCH (COMPACT BODY) (10001)</p> <p>GROUP 1</p>	\$ 59.00	\$ 118.00
4	2.00	EA	<p>0050 MECHANICAL JOINT SOLID REPAIR SLEEVES 6 INCH (LONG BODY)</p> <p>GROUP 1</p>	\$ 293.00	\$ 586.00
5	16.00	EA	<p>0060 MECHANICAL JOINT SOLID REPAIR SLEEVES 6 INCH (COMPACT BODY) (10002)</p> <p>GROUP 1</p>	\$ 293.00	\$ 4688.00
6	2.00	EA	<p>0070 MECHANICAL JOINT SOLID REPAIR SLEEVES 8 INCH (LONG BODY)</p> <p>GROUP 1</p>	\$ 385.00	\$ 770.00
7	2.00	EA	<p>0080 MECHANICAL JOINT SOLID REPAIR SLEEVES 8 INCH (COMPACT BODY) (10003)</p>	\$ 293.00	\$ 586.00

INVITATION TO BID FROM JEFFERSON PARISH - continued

BID NO.: 50-00146343

SEALED BID

ITEM NUMBER	QUANTITY	U/M	DESCRIPTION OF ARTICLES	UNIT PRICE QUOTED	TOTALS
			GROUP 1		
8	2.00	EA	0090 MECHANICAL JOINT SOLID REPAIR SLEEVES 10 INCH (LONG BODY) (10004A)	\$ 245.00	\$ 490.00
			GROUP 1		
9	2.00	EA	0100 MECHANICAL JOINT SOLID REPAIR SLEEVES 10 INCH (COMPACT BODY) (10004)	\$ 245.00	\$ 490.00
			GROUP 1		
10	2.00	EA	0110 MECHANICAL JOINT SOLID REPAIR SLEEVES 12 INCH (LONG BODY) (10005A)	\$ 596.00	\$ 1192.00
			GROUP 1		
11	2.00	EA	0120 MECHANICAL JOINT SOLID REPAIR SLEEVES 12 INCH (COMPACT BODY) (10005)	\$ 267.00	\$ 534.00
			GROUP 1		
12	2.00	EA	0130 MECHANICAL JOINT SOLID REPAIR SLEEVES 14 INCH (LONG BODY)	\$ 437.00	\$ 874.00
			GROUP 1		
13	2.00	EA	0140 MECHANICAL JOINT SOLID REPAIR SLEEVES 14 INCH (COMPACT BODY) (10006)	\$ 388.00	\$ 776.00
			GROUP 1		
14	2.00	EA	0145 MECHANICAL JOINT SOLID REPAIR SLEEVES 16 INCH (LONG BODY) (10007A)	\$ 921.00	\$ 1842.00
			GROUP 1		
15	2.00	EA	0150 MECHANICAL JOINT SOLID REPAIR SLEEVES 16 INCH (COMPACT BODY) (10007)	\$ 617.00	\$ 1234.00
			GROUP 1		
16	2.00	EA	0160 MECHANICAL JOINT SOLID REPAIR SLEEVES 18 INCH (LONG BODY) (10008A)	\$ 1182.00	\$ 2364.00

INVITATION TO BID FROM JEFFERSON PARISH - continued

BID NO.: 50-00146343

SEALED BID

ITEM NUMBER	QUANTITY	U/M	DESCRIPTION OF ARTICLES	UNIT PRICE QUOTED	TOTALS
			GROUP 1		
17	2.00	EA	0170 MECHANICAL JOINT SOLID REPAIR SLEEVES 18 INCH (COMPACT BODY) (10008)	\$ 785.00	\$ 1570.00
			GROUP 1		
18	2.00	EA	0180 MECHANICAL JOINT SOLID REPAIR SLEEVES 20 INCH (LONG BODY) (10009A)	\$ 1367.00	\$ 2734.00
			GROUP 1		
19	2.00	EA	0190 MECHANICAL JOINT SOLID REPAIR SLEEVES 20 INCH (COMPACT BODY) (10009)	\$ 960.00	\$ 1920.00
			GROUP 1		
20	2.00	EA	0195 MECHANICAL JOINT SOLID REPAIR SLEEVES 24 INCH (LONG BODY) (10010A)	\$ 1787.00	\$ 3574.00
			GROUP 1		
21	2.00	EA	0200 MECHANICAL JOINT SOLID REPAIR SLEEVES 24 INCH (COMPACT BODY) (10010)	\$ 1272.00	\$ 2544.00
			GROUP 1		
22	2.00	EA	0210 MECHANICAL JOINT SOLID REPAIR SLEEVES 30 INCH (LONG BODY) (10011A)	\$ 2950.00	\$ 5900.00
			GROUP 1		
23	2.00	EA	0220 MECHANICAL JOINT SOLID REPAIR SLEEVES 30 INCH (COMPACT BODY) (10011)	\$ 2600.00	\$ 5200.00
			GROUP 1		
24	2.00	EA	0230 MECHANICAL JOINT SOLID REPAIR SLEEVES 36 INCH (LONG BODY) C-110 (10012A)	\$ 6678.00	\$ 13,356.00
			GROUP 1		
25	2.00	EA	0240 MECHANICAL JOINT SOLID REPAIR SLEEVES 36 INCH (COMPACT BODY) C-110	\$ 5600.00	\$ 11,200.00

INVITATION TO BID FROM JEFFERSON PARISH - continued

BID NO.: 50-00146343

SEALED BID

ITEM NUMBER	QUANTITY	U/M	DESCRIPTION OF ARTICLES	UNIT PRICE QUOTED	TOTALS
			(10012)		
			GROUP 1		
26	2.00	EA	0250 MECHANICAL JOINT SOLID REPAIR SLEEVES 42 INCH (LONG BODY) C-110	\$ 7463.00	\$ 14,926.00
			GROUP 1		
27	2.00	EA	0260 MECHANICAL JOINT SOLID REPAIR SLEEVES 42 INCH (COMPACT BODY) C-110	\$ 4183.00	\$ 8366.00
			(10013)		
			GROUP 1		
28	2.00	EA	0270 MECHANICAL JOINT SOLID REPAIR SLEEVES 48 INCH (LONG BODY) C-110	\$ 11,891.00	\$ 23,782.00
			(10014A)		
			GROUP 1		
29	2.00	EA	0280 MECHANICAL JOINT SOLID REPAIR SLEEVES 48 INCH (COMPACT BODY) C-110	\$ 6289.00	\$ 12,578.00
			(10014)		
			GROUP 1		
30	2.00	EA	0290 MECHANICAL JOINT, 90 DEGREE BENDS 3 INCH (06475)	\$ 87.00	\$ 174.00
			GROUP 2		
31	2.00	EA	0295 MECHANICAL JOINT, 90 DEGREE BENDS 4 INCH (06476)	\$ 98.00	\$ 196.00
			GROUP 2		
32	16.00	EA	0300 MECHANICAL JOINT, 90 DEGREE BENDS 6 INCH (06477)	\$ 238.00	\$ 3808.00
			GROUP 2		
33	2.00	EA	0310 MECHANICAL JOINT, 90 DEGREE BENDS 8 INCH (06478)	\$ 210.00	\$ 420.00

INVITATION TO BID FROM JEFFERSON PARISH - continued

BID NO.: 50-00146343

SEALED BID

ITEM NUMBER	QUANTITY	U/M	DESCRIPTION OF ARTICLES	UNIT PRICE QUOTED	TOTALS
			GROUP 2		
34	2.00	EA	0320 MECHANICAL JOINT, 90 DEGREE BENDS 10 INCH (06479)	\$ 309.00	\$ 618.00
			GROUP 2		
35	2.00	EA	0330 MECHANICAL JOINT, 90 DEGREE BENDS 12 INCH (06480)	\$ 444.00	\$ 888.00
			GROUP 2		
36	2.00	EA	0340 MECHANICAL JOINT, 90 DEGREE BENDS 14 INCH (06481)	\$ 576.00	\$ 1152.00
			GROUP 2		
37	2.00	EA	0360 MECHANICAL JOINT, 90 DEGREE BENDS 18 INCH (06483)	\$ 698.00	\$ 1396.00
			GROUP 2		
38	2.00	EA	0390 MECHANICAL JOINT, 90 DEGREE BENDS 30 INCH C-110	\$ 4269.00	\$ 8538.00
			GROUP 2		
39	2.00	EA	0400 MECHANICAL JOINT, 90 DEGREE BENDS 36 INCH C-110	\$ 9276.00	\$ 18,552.00
			GROUP 2		
40	2.00	EA	0410 MECHANICAL JOINT X FLANGE, 90 DEGREE BENDS, 3 INCH	\$ 92.00	\$ 184.00
			GROUP 3		
41	2.00	EA	0420 MECHANICAL JOINT X FLANGE, 90 DEGREE BENDS, 4 INCH	\$ 121.00	\$ 242.00
			GROUP 3		
42	2.00	EA	0430 MECHANICAL JOINT X FLANGE, 90 DEGREE BENDS, 6 INCH (06277)	\$ 198.00	\$ 396.00

INVITATION TO BID FROM JEFFERSON PARISH - continued

BID NO.: 50-00146343

SEALED BID

ITEM NUMBER	QUANTITY	U/M	DESCRIPTION OF ARTICLES	UNIT PRICE QUOTED	TOTALS
			GROUP 3		
43	2.00	EA	0450 MECHANICAL JOINT X FLANGE, 90 DEGREE BENDS, 30 INCH C-110	\$ 5300.00	\$ 10,600.00
			GROUP 3		
44	2.00	EA	0460 MECHANICAL JOINT X FLANGE, 90 DEGREE BENDS, 36 INCH C-110	\$ 8700.00	\$ 17,400.00
			GROUP 3		
45	2.00	EA	0470 MECHANICAL JOINT, 45 DEGREE BENDS 3 INCH (06450)	\$ 78.00	\$ 156.00
			GROUP 4		
46	2.00	EA	0480 MECHANICAL JOINT, 45 DEGREE BENDS 4 INCH (06451)	\$ 78.00	\$ 156.00
			GROUP 4		
47	2.00	EA	0490 MECHANICAL JOINT, 45 DEGREE BENDS 6 INCH (06452)	\$ 273.00	\$ 546.00
			GROUP 4		
48	2.00	EA	0500 MECHANICAL JOINT, 45 DEGREE BENDS 8 INCH (06453)	\$ 364.00	\$ 728.00
			GROUP 4		
49	8.00	EA	0520 MECHANICAL JOINT, 45 DEGREE BENDS 12 INCH (06455)	\$ 453.00	\$ 3624.00
			GROUP 4		
50	2.00	EA	0540 MECHANICAL JOINT, 45 DEGREE BENDS 16 INCH (06457)	\$ 705.00	\$ 1410.00
			GROUP 4		
51	2.00	EA	0570 MECHANICAL JOINT, 45 DEGREE BENDS 24 INCH (06460)	\$ 1632.00	\$ 3264.00

INVITATION TO BID FROM JEFFERSON PARISH - continued

BID NO.: 50-00146343

SEALED BID

ITEM NUMBER	QUANTITY	U/M	DESCRIPTION OF ARTICLES	UNIT PRICE QUOTED	TOTALS
52	2.00	EA	GROUP 4 0580 MECHANICAL JOINT, 45 DEGREE BENDS 30 INCH C-110	\$ 6700.00	\$ 13400.00
53	2.00	EA	GROUP 4 0600 MECHANICAL JOINT X FLANGE, 45 DEGREE BENDS, 3 INCH	\$ 114.00	\$ 228.00
54	2.00	EA	GROUP 5 0620 MECHANICAL JOINT X FLANGE, 45 DEGREE BENDS, 6 INCH (06252)	\$ 168.00	\$ 336.00
55	2.00	EA	GROUP 5 0630 MECHANICAL JOINT X FLANGE, 45 DEGREE BENDS, 8 INCH (06253)	\$ 319.00	\$ 638.00
56	2.00	EA	GROUP 5 0640 MECHANICAL JOINT, 22-1/2 DEGREE BENDS, 3 INCH	\$ 52.00	\$ 104.00
57	2.00	EA	GROUP 6 0650 MECHANICAL JOINT, 22-1/2 DEGREE BENDS, 4 INCH (06426)	\$ 83.00	\$ 166.00
58	2.00	EA	GROUP 6 0660 MECHANICAL JOINT, 22-1/2 DEGREE BENDS, 6 INCH (06427)	\$ 106.00	\$ 212.00
59	2.00	EA	GROUP 6 0670 MECHANICAL JOINT, 22-1/2 DEGREE BENDS, 8 INCH (06428)	\$ 165.00	\$ 330.00
60	2.00	EA	GROUP 6 0720 MECHANICAL JOINT, 22-1/2 DEGREE BENDS, 18 INCH (06433)	\$ 717.00	\$ 1434.00

INVITATION TO BID FROM JEFFERSON PARISH - continued

BID NO.: 50-00146343

SEALED BID

ITEM NUMBER	QUANTITY	U/M	DESCRIPTION OF ARTICLES	UNIT PRICE QUOTED	TOTALS
61	2.00	EA	GROUP 6 0730 MECHANICAL JOINT, 22-1/2 DEGREE BENDS, 20 INCH (06434)	\$ 926.00	\$ 1852.00
62	2.00	EA	GROUP 6 0750 MECHANICAL JOINT, 11-1/4 DEGREE BENDS, 6 INCH (06502)	\$ 78.00	\$ 156.00
63	2.00	EA	GROUP 7 0760 MECHANICAL JOINT, 11-1/4 DEGREE BENDS, 8 INCH (06503)	\$ 149.00	\$ 298.00
64	2.00	EA	GROUP 7 0770 MECHANICAL JOINT, 11-1/4 DEGREE BENDS, 12 INCH (06505)	\$ 292.00	\$ 584.00
65	2.00	EA	GROUP 7 0780 MECHANICAL JOINT, 11-1/4 DEGREE BENDS, 20 INCH (06509)	\$ 841.00	\$ 1682.00
66	2.00	EA	GROUP 7 0790 MECHANICAL JOINT TEES, 3 INCH BY 3 INCH	\$ 116.00	\$ 232.00
67	2.00	EA	GROUP 8 0800 MECHANICAL JOINT TEES, 4 INCH BY 4 INCH (10402)	\$ 139.00	\$ 278.00
68	2.00	EA	GROUP 8 0810 MECHANICAL JOINT TEES, 6 INCH BY 4 INCH (10403)	\$ 218.00	\$ 436.00
69	2.00	EA	GROUP 8 0820 MECHANICAL JOINT TEES, 6 INCH BY 6 INCH (10404)	\$ 390.00	\$ 780.00

INVITATION TO BID FROM JEFFERSON PARISH - continued

BID NO.: 50-00146343

SEALED BID

ITEM NUMBER	QUANTITY	U/M	DESCRIPTION OF ARTICLES	UNIT PRICE QUOTED	TOTALS
70	2.00	EA	GROUP 8 0830 MECHANICAL JOINT TEES, 8 INCH BY 6 INCH (10406)	\$ 449.00	\$ 898.00
71	2.00	EA	GROUP 8 0840 MECHANICAL JOINT TEES, 8 INCH BY 8 INCH (10407)	\$ 490.00	\$ 980.00
72	2.00	EA	GROUP 8 0850 MECHANICAL JOINT TEES, 10 INCH BY 6 INCH (10408)	\$ 322.00	\$ 644.00
73	2.00	EA	GROUP 8 0860 MECHANICAL JOINT TEES, 10 INCH BY 8 INCH (10409)	\$ 355.00	\$ 710.00
74	2.00	EA	GROUP 8 0870 MECHANICAL JOINT TEES, 10 INCH BY 10 INCH (10410)	\$ 426.00	\$ 852.00
75	2.00	EA	GROUP 8 0880 MECHANICAL JOINT TEES, 12 INCH BY 6 INCH (10411)	\$ 652.00	\$ 1304.00
76	2.00	EA	GROUP 8 0890 MECHANICAL JOINT TEES, 12 INCH BY 8 INCH (10412)	\$ 663.00	\$ 1326.00
77	2.00	EA	GROUP 8 0900 MECHANICAL JOINT TEES, 12 INCH BY 12 INCH (10414)	\$ 640.00	\$ 1280.00
78	2.00	EA	GROUP 8 0910 MECHANICAL JOINT TEES, 16 INCH BY 6 INCH	\$ 923.00	\$ 1846.00

INVITATION TO BID FROM JEFFERSON PARISH - continued

BID NO.: 50-00146343

SEALED BID

ITEM NUMBER	QUANTITY	U/M	DESCRIPTION OF ARTICLES	UNIT PRICE QUOTED	TOTALS
			GROUP 8		
79	2.00	EA	0920 MECHANICAL JOINT TEES, 16 INCH BY 8 INCH (10421)	\$ 918.00	\$ 1836.00
			GROUP 8		
80	2.00	EA	0970 MECHANICAL JOINT X FLANGE TEES, 6 INCH BY 4 INCH	\$ 250.00	\$ 500.00
			GROUP 9		
81	2.00	EA	0980 MECHANICAL JOINT X FLANGE TEES, 6 INCH BY 6 INCH (10504)	\$ 362.00	\$ 724.00
			GROUP 9		
82	2.00	EA	0990 MECHANICAL JOINT X FLANGE TEES, 8 INCH BY 6 INCH (10506)	\$ 477.00	\$ 954.00
			GROUP 9		
83	2.00	EA	1000 MECHANICAL JOINT X FLANGE TEES, 10 INCH BY 6 INCH	\$ 510.00	\$ 1020.00
			GROUP 9		
84	2.00	EA	1020 MECHANICAL JOINT X FLANGE TEES, 12 INCH BY 6 INCH (10511)	\$ 592.00	\$ 1184.00
			GROUP 9		
85	2.00	EA	1025 MECHANICAL JOINT X FLANGE TEES, 14 INCH BY 6 INCH	\$ 603.00	\$ 1206.00
			GROUP 9		
86	20.00	EA	1040 MECHANICAL JOINT X SWIVEL TEES, 6 INCH BY 6 INCH (10700)	\$ 431.00	\$ 8620.00
			GROUP 10		
87	32.00	EA	1050 MECHANICAL JOINT X SWIVEL TEES, 8 INCH BY 6 INCH (10701)	\$ 489.00	\$ 15,648.00

INVITATION TO BID FROM JEFFERSON PARISH - continued

BID NO.: 50-00146343

SEALED BID

ITEM NUMBER	QUANTITY	U/M	DESCRIPTION OF ARTICLES	UNIT PRICE QUOTED	TOTALS
			GROUP 10		
88	2.00	EA	1060 MECHANICAL JOINT X SWIVEL TEES, 8 INCH BY 8 INCH (10702)	\$ 359.00	\$ 718.00
			GROUP 10		
89	2.00	EA	1070 MECHANICAL JOINT X SWIVEL TEES, 10 INCH BY 6 INCH (10703)	\$ 359.00	\$ 718.00
			GROUP 10		
90	2.00	EA	1080 MECHANICAL JOINT X SWIVEL TEES, 12 INCH BY 6 INCH (10705)	\$ 713.00	\$ 1426.00
			GROUP 10		
91	2.00	EA	1090 MECHANICAL JOINT X SWIVEL TEES, 12 INCH BY 8 INCH (10706)	\$ 494.00	\$ 988.00
			GROUP 10		
92	2.00	EA	1110 MECHANICAL JOINT X SWIVEL TEES, 16 INCH BY 6 INCH (10709)	\$ 750.00	\$ 1500.00
			GROUP 10		
93	2.00	EA	1130 MECHANICAL JOINT CROSSES, 4 INCH BY 4 INCH	\$ 255.00	\$ 510.00
			GROUP 11		
94	2.00	EA	1140 MECHANICAL JOINT CROSSES, 4 INCH BY 6 INCH	\$ 278.00	\$ 556.00
			GROUP 11		
95	2.00	EA	1150 MECHANICAL JOINT CROSSES, 6 INCH BY 6 INCH	\$ 322.00	\$ 644.00
			GROUP 11		
96	2.00	EA	1160 MECHANICAL JOINT CONCENTRIC REDUCERS, 4 INCH BY 3 INCH (09401)	\$ 83.00	\$ 166.00

INVITATION TO BID FROM JEFFERSON PARISH - continued

BID NO.: 50-00146343

SEALED BID

ITEM NUMBER	QUANTITY	U/M	DESCRIPTION OF ARTICLES	UNIT PRICE QUOTED	TOTALS
			GROUP 12		
97	2.00	EA	1170 MECHANICAL JOINT CONCENTRIC REDUCERS, 6 INCH BY 4 INCH (09402)	\$ 187.00	\$ 374.00
			GROUP 12		
98	2.00	EA	1180 MECHANICAL JOINT CONCENTRIC REDUCERS, 8 INCH BY 4 INCH (09403)	\$ 124.00	\$ 248.00
			GROUP 12		
99	2.00	EA	1190 MECHANICAL JOINT CONCENTRIC REDUCERS, 8 INCH BY 6 INCH (09404)	\$ 380.00	\$ 760.00
			GROUP 12		
100	2.00	EA	1210 MECHANICAL JOINT CONCENTRIC REDUCERS, 10 INCH BY 8 INCH (09406)	\$ 184.00	\$ 368.00
			GROUP 12		
101	2.00	EA	1220 MECHANICAL JOINT CONCENTRIC REDUCERS, 12 INCH BY 6 INCH (09407)	\$ 222.00	\$ 444.00
			GROUP 12		
102	2.00	EA	1230 MECHANICAL JOINT CONCENTRIC REDUCERS, 12 INCH BY 8 INCH (09408)	\$ 211.00	\$ 422.00
			GROUP 12		
103	2.00	EA	1240 MECHANICAL JOINT CONCENTRIC REDUCERS, 12 INCH BY 10 INCH (09409)	\$ 244.00	\$ 488.00
			GROUP 12		
104	2.00	EA	1250 MECHANICAL JOINT CONCENTRIC REDUCERS, 14 INCH BY 6 INCH (09410)	\$ 392.00	\$ 784.00
			GROUP 12		
105	2.00	EA	1270 MECHANICAL JOINT X FLANGE ADAPTERS, 4 INCH (09900)	\$ 123.00	\$ 246.00

INVITATION TO BID FROM JEFFERSON PARISH - continued

BID NO.: 50-00146343

SEALED BID

ITEM NUMBER	QUANTITY	U/M	DESCRIPTION OF ARTICLES	UNIT PRICE QUOTED	TOTALS
			GROUP 13		
106	2.00	EA	1280 MECHANICAL JOINT X FLANGE ADAPTERS, 6 INCH (09901)	\$ 172.00	\$ 344.00
			GROUP 13		
107	2.00	EA	1290 MECHANICAL JOINT X FLANGE ADAPTERS, 8 INCH (09902)	\$ 188.00	\$ 376.00
			GROUP 13		
108	2.00	EA	1310 MECHANICAL JOINT CAP, 4 INCH (06701)	\$ 39.00	\$ 78.00
			GROUP 14		
109	2.00	EA	1320 MECHANICAL JOINT CAP, 6 INCH (06702)	\$ 76.00	\$ 152.00
			GROUP 14		
110	2.00	EA	1330 MECHANICAL JOINT CAP, 8 INCH (06703)	\$ 99.00	\$ 198.00
			GROUP 14		
111	2.00	EA	1380 MECHANICAL JOINT PLUG, 4 INCH (09001)	\$ 59.00	\$ 118.00
			GROUP 15		
112	2.00	EA	1390 MECHANICAL JOINT PLUG, 6 INCH (09002)	\$ 98.00	\$ 196.00
			GROUP 15		
113	2.00	EA	1400 MECHANICAL JOINT PLUG, 8 INCH (09003)	\$ 127.00	\$ 254.00
			GROUP 15		
114	2.00	EA	1420 MECHANICAL JOINT PLUG, 12 INCH (09005)	\$ 215.00	\$ 430.00

INVITATION TO BID FROM JEFFERSON PARISH - continued

BID NO.: 50-00146343

SEALED BID

ITEM NUMBER	QUANTITY	U/M	DESCRIPTION OF ARTICLES	UNIT PRICE QUOTED	TOTALS
			GROUP 15		
115	2.00	EA	1470 MECHANICAL JOINT OFFSET, 6 INCH BY 12 INCH (10778)	\$ 336.00	\$ 672.00
			GROUP 16		
116	2.00	EA	1480 MECHANICAL JOINT OFFSET, 8 INCH BY 12 INCH (10781)	\$ 471.00	\$ 942.00
			GROUP 16		
117	2.00	EA	1500 PRICE BROTHERS PIPE ADAPTER KITS, 16 INCH BY 24 INCH LENGTH (56760)	\$ 9,235.00	\$ 18,470.00
			GROUP 17		
118	2.00	EA	1510 PRICE BROTHERS PIPE ADAPTER KITS, 18 INCH BY 24 INCH LENGTH (56761)	\$ 11,502.00	\$ 23,004.00
			GROUP 17		
119	2.00	EA	1520 PRICE BROTHERS PIPE ADAPTER KITS, 20 INCH BY 24 INCH LENGTH (56762)	\$ 12,800.00	\$ 25,600.00
			GROUP 17		
120	2.00	EA	1530 PRICE BROTHERS PIPE ADAPTER KITS, 24 INCH BY 24 INCH LENGTH (56763)	\$ 13,751.00	\$ 27,502.00
			GROUP 17		
121	2.00	EA	1540 PRICE BROTHERS PIPE ADAPTER KITS, 30 INCH BY 24 INCH LENGTH (56764)	\$ 15,248.00	\$ 30,496.00
			GROUP 17		
122	2.00	EA	1550 PRICE BROTHERS PIPE ADAPTER KITS, 36 INCH BY 24 INCH LENGTH (56765)	\$ 19,717.00	\$ 39,434.00
			GROUP 17		
123	2.00	EA	1560 PRICE BROTHERS PIPE ADAPTER KITS, 42 INCH BY 24 INCH LENGTH (56766)	\$ 21,000.00	\$ 42,000.00

INVITATION TO BID FROM JEFFERSON PARISH - continued

BID NO.: 50-00146343

SEALED BID

ITEM NUMBER	QUANTITY	U/M	DESCRIPTION OF ARTICLES	UNIT PRICE QUOTED	TOTALS
			GROUP 17		
124	2.00	EA	1570 PRICE BROTHERS PIPE ADAPTER KITS, 48 INCH BY 24 INCH LENGTH (56767)	\$ 23,000.00	\$ 46,000.00
			GROUP 17		
125	2.00	EA	1710 FLANGED JOINT, 45 DEGREE BEND (PROTECTO 401 CERAMIC INTERIOR LINING)	\$ 948.00	\$ 1896.00
			10 INCH		
			Group 18		
126	2.00	EA	1715 FLANGED JOINT, 45 DEGREE BEND (PROTECTO 401 CERAMIC INTERIOR LINING)	\$ 1100.00	\$ 2200.00
			12 INCH (06155)		
			Group 18		
127	2.00	EA	1770 FLANGED JOINT, 90 DEGREE BEND (PROTECTO 401 CERAMIC INTERIOR LINING)	\$ 398.00	\$ 796.00
			3 INCH (06175)		
			Group 19		
128	2.00	EA	1780 FLANGED JOINT, 90 DEGREE BEND (PROTECTO 401 CERAMIC INTERIOR LINING)	\$ 408.00	\$ 816.00
			4 INCH (06176)		
			Group 19		
129	8.00	EA	1790 FLANGED JOINT, 90 DEGREE BEND (PROTECTO 401 CERAMIC INTERIOR LINING)	\$ 670.00	\$ 5360.00
			6 INCH (06177)		
			Group 19		
130	2.00	EA	1800 FLANGED JOINT, 90 DEGREE BEND (PROTECTO 401 CERAMIC INTERIOR LINING)	\$ 762.00	\$ 1524.00
			8 INCH (06178)		
			Group 19		
131	2.00	EA	1820 FLANGED JOINT, 90 DEGREE BEND (PROTECTO 401 CERAMIC INTERIOR LINING)	\$ 1339.00	\$ 2678.00

INVITATION TO BID FROM JEFFERSON PARISH - continued

BID NO.: 50-00146343

SEALED BID

ITEM NUMBER	QUANTITY	U/M	DESCRIPTION OF ARTICLES	UNIT PRICE QUOTED	TOTALS
			12 INCH (06180) Group 19		
132	2.00	EA	1870 FLANGED JOINT, 90 DEGREE BEND REDUCING (PROTECTO 401 CERAMIC INTERIOR LINING) 12 INCH BY 10 INCH (06200) Group 20	\$ 1084.00	\$ 2168.00
133	2.00	EA	1880 FLANGED JOINT, 90 DEGREE BEND REDUCING (PROTECTO 401 CERAMIC INTERIOR LINING) 14 INCH BY 10 INCH (06203) Group 20	\$ 948.00	\$ 1896.00
134	2.00	EA	1890 FLANGED JOINT, CROSSES (PROTECTO 401 CERAMIC INTERIOR LINING) 4 INCH BY 4 INCH (07202) Group 21	\$ 672.00	\$ 1344.00
135	2.00	EA	1900 FLANGED JOINT, CROSSES (PROTECTO 401 CERAMIC INTERIOR LINING) 6 INCH BY 6 INCH (07203) Group 21	\$ 760.00	\$ 1520.00
136	2.00	EA	1930 FLANGED JOINT, CROSSES (PROTECTO 401 CERAMIC INTERIOR LINING) 12 INCH BY 12 INCH (07206) Group 21	\$ 1254.00	\$ 2508.00
137	2.00	EA	1940 FLANGED JOINT, CROSSES (PROTECTO 401 CERAMIC INTERIOR LINING) 12 INCH BY 6 INCH (07209) A Group 21	\$ 983.00	\$ 1966.00
138	2.00	EA	1950 FLANGED JOINT, CROSSES (PROTECTO 401 CERAMIC INTERIOR LINING) 16 INCH BY 6 INCH (07212) A Group 21	\$ 1960.00	\$ 3920.00
139	6.00	EA	1960 FLANGED JOINT, CONCENTRIC REDUCERS	\$ 349.00	\$ 2094.00

INVITATION TO BID FROM JEFFERSON PARISH - continued

BID NO.: 50-00146343

SEALED BID

ITEM NUMBER	QUANTITY	U/M	DESCRIPTION OF ARTICLES	UNIT PRICE QUOTED	TOTALS
140	2.00	EA	(PROTECTO 401 CERAMIC INTERIOR LINING) 4 INCH BY 3 INCH (09101) A Group 22 1970 FLANGED JOINT, CONCENTRIC REDUCERS	\$ 399.00	\$ 798.00
141	6.00	EA	(PROTECTO 401 CERAMIC INTERIOR LINING) 6 INCH BY 3 INCH (09102) A Group 22 1980 FLANGED JOINT, CONCENTRIC REDUCERS	\$ 585.00	\$ 3510.00
142	2.00	EA	(PROTECTO 401 CERAMIC INTERIOR LINING) 6 INCH BY 4 INCH (09103) A Group 22 1990 FLANGED JOINT, CONCENTRIC REDUCERS	\$ 578.00	\$ 1156.00
143	2.00	EA	(PROTECTO 401 CERAMIC INTERIOR LINING) 8 INCH BY 6 INCH (09104) A Group 22 2000 FLANGED JOINT, CONCENTRIC REDUCERS	\$ 731.00	\$ 1462.00
144	2.00	EA	(PROTECTO 401 CERAMIC INTERIOR LINING) 10 INCH BY 6 INCH (09105) A Group 22 2010 FLANGED JOINT, CONCENTRIC REDUCERS	\$ 849.00	\$ 1698.00
145	2.00	EA	(PROTECTO 401 CERAMIC INTERIOR LINING) 10 INCH BY 8 INCH (09106) A Group 22 2020 FLANGED JOINT, CONCENTRIC REDUCERS	\$ 788.00	\$ 1576.00
146	2.00	EA	(PROTECTO 401 CERAMIC INTERIOR LINING) 12 INCH BY 6 INCH (09107) A Group 22 2030 FLANGED JOINT, CONCENTRIC REDUCERS	\$ 860.00	\$ 1720.00

INVITATION TO BID FROM JEFFERSON PARISH - continued

BID NO.: 50-00146343

SEALED BID

ITEM NUMBER	QUANTITY	U/M	DESCRIPTION OF ARTICLES	UNIT PRICE QUOTED	TOTALS
			(PROTECTO 401 CERAMIC INTERIOR LINING) 12 INCH BY 8 INCH (09108) A Group 22		
147	2.00	EA	2040 FLANGED JOINT, CONCENTRIC REDUCERS	\$ 648.00	\$ 1296.00
			(PROTECTO 401 CERAMIC INTERIOR LINING) 12 INCH BY 10 INCH (09109) A Group 22		
148	2.00	EA	2050 FLANGED JOINT, CONCENTRIC REDUCERS	\$ 726.00	\$ 1452.00
			(PROTECTO 401 CERAMIC INTERIOR LINING) 14 INCH BY 8 INCH (09110) A Group 22		
149	2.00	EA	2060 FLANGED JOINT, CONCENTRIC REDUCERS	\$ 810.00	\$ 1620.00
			(PROTECTO 401 CERAMIC INTERIOR LINING) 14 INCH BY 10 INCH (09111) A Group 22		
150	2.00	EA	2070 FLANGED JOINT, CONCENTRIC REDUCERS	\$ 977.00	\$ 1954.00
			(PROTECTO 401 CERAMIC INTERIOR LINING) 16 INCH BY 12 INCH (09112) A Group 22		
151	2.00	EA	2080 FLANGED JOINT, CONCENTRIC REDUCERS	\$ 780.00	\$ 1560.00
			(PROTECTO 401 CERAMIC INTERIOR LINING) 16 INCH BY 10 INCH (09114) A Group 22		
152	8.00	EA	2090 FLANGED JOINT, TEES (PROTECTO 401 CERAMIC INTERIOR LINING) 4 INCH BY 4 INCH BY 4 INCH (10102) Group 23	\$ 555.00	\$ 4440.00
153	2.00	EA	2095 FLANGED JOINT, TEES (PROTECTO 401 CERAMIC INTERIOR LINING)	\$ 652.00	\$ 1304.00

INVITATION TO BID FROM JEFFERSON PARISH - continued

BID NO.: 50-00146343

SEALED BID

ITEM NUMBER	QUANTITY	U/M	DESCRIPTION OF ARTICLES	UNIT PRICE QUOTED	TOTALS
154	2.00	EA	4 INCH BY 4 INCH BY 6 INCH (10102A) Group 23 2100 FLANGED JOINT, TEES (PROTECTO 401 CERAMIC INTERIOR LINING) 6 INCH BY 6 INCH BY 4 INCH (10103) A Group 23	\$ 651.00	\$ 1302.00
155	2.00	EA	2110 FLANGED JOINT, TEES (PROTECTO 401 CERAMIC INTERIOR LINING) 6 INCH BY 6 INCH BY 6 INCH (10104) A Group 23	\$ 652.00	\$ 1304.00
156	2.00	EA	2120 FLANGED JOINT, TEES (PROTECTO 401 CERAMIC INTERIOR LINING) 8 INCH BY 8 INCH BY 6 INCH (10105) A Group 23	\$ 859.00	\$ 1718.00
157	2.00	EA	2130 FLANGED JOINT, TEES (PROTECTO 401 CERAMIC INTERIOR LINING) 8 INCH BY 8 INCH BY 8 INCH (10106) A Group 23	\$ 944.00	\$ 1888.00
158	2.00	EA	2140 FLANGED JOINT, TEES (PROTECTO 401 CERAMIC INTERIOR LINING) 10 INCH BY 10 INCH BY 6 INCH (10108) A Group 23	\$ 867.00	\$ 1734.00
159	2.00	EA	2150 FLANGED JOINT, TEES (PROTECTO 401 CERAMIC INTERIOR LINING) 10 INCH BY 10 INCH BY 10 INCH (10110) A Group 23	\$ 1054.00	\$ 2108.00
160	2.00	EA	2160 FLANGED JOINT, TEES (PROTECTO 401 CERAMIC INTERIOR LINING) 12 INCH BY 12 INCH BY 6 INCH (10112) A Group 23	\$ 1471.00	\$ 2942.00
161	2.00	EA	2170 FLANGED JOINT, TEES (PROTECTO 401 CERAMIC INTERIOR LINING)	\$ 1535.00	\$ 3070.00

INVITATION TO BID FROM JEFFERSON PARISH - continued

BID NO.: 50-00146343

SEALED BID

ITEM NUMBER	QUANTITY	U/M	DESCRIPTION OF ARTICLES	UNIT PRICE QUOTED	TOTALS
162	2.00	EA	12 INCH BY 12 INCH BY 8 INCH (10113) A Group 23 2180 FLANGED JOINT, TEES (PROTECTO 401 CERAMIC INTERIOR LINING)	\$ 1788.00	\$ 3576.00
163	2.00	EA	12 INCH BY 12 INCH BY 12 INCH (10115) A Group 23 2190 FLANGED JOINT, TEES (PROTECTO 401 CERAMIC INTERIOR LINING)	\$ 1822.00	\$ 3644.00
164	2.00	EA	14 INCH BY 14 INCH BY 6 INCH (10117)A Group 23 2200 FLANGED JOINT, TEES (PROTECTO 401 CERAMIC INTERIOR LINING)	\$ 2047.00	\$ 4094.00
165	2.00	EA	14 INCH BY 14 INCH BY 10 INCH (10119) A Group 23 2210 FLANGED JOINT, TEES (PROTECTO 401 CERAMIC INTERIOR LINING)	\$ 2366.00	\$ 4732.00
166	2.00	EA	16 INCH BY 16 INCH BY 16 INCH (10121) A Group 23 2220 FLANGED JOINT, TRUE WYES (PROTECTO 401 CERAMIC INTERIOR LINING)	\$ 430.00	\$ 860.00
167	2.00	EA	4 INCH (10802) A Group 24 2710 - FLANGE JOINT,TEE,4 IN X 4 IN X 4 IN,DUCTILE IRON,FLANGED,FUSION EPOXY COATED,NO ACCESSORIES,MUST HAVE AWWA, ASTM,OR ANSI APPROVAL AND WRITTEN PROOF OF ISO9001 CERTIFICATION (10102B) GROUP 25	\$ 305.00	\$ 610.00
168	2.00	EA	2720 - FLANGE JOINT, TEE,6 INCH X 6 INCH X 4 INCH,DUCTILE IRON, FLANGED,FUSION EPOXY COATED,NO ACCESSORIES,MUST HAVE AWWA,ASTM,OR ANSI APPROVAL AND WRITTEN	\$ 391.00	\$ 782.00

INVITATION TO BID FROM JEFFERSON PARISH - continued

BID NO.: 50-00146343

SEALED BID

ITEM NUMBER	QUANTITY	U/M	DESCRIPTION OF ARTICLES	UNIT PRICE QUOTED	TOTALS
169	2.00	EA	PROOF OF ISO9001 CERTIFICATION (101030) GROUP 25 2730 - FLANGED JOINT,TEE 6 IN X 6 IN X 6 IN, DUCTILE IRON,FLANGED,FUSION EPOXY COATED, WITHOUT ACCESSORIES,MUST HAVE AWWA, ASTM, OR ANSI APPROVAL AND WRITTEN PROOF OF ISO9001 CERTIFICATION (101040) GROUP 25	\$ 398.00	\$ 796.00
170	2.00	EA	2740 - FLANGE JOINT,TEE,8 INCH X 8 INCH X 6 INCH ,DUCTILE IRON,FLANGED,FUSION EPOXY COATED,NO ACCESSORIES,MEETS AWWA, ASTM, OR ANSI APPROVAL AND WRITTEN PROOF OF ISO 9000 CERTIFICATION (101050) GROUP 25	\$ 659.00	\$ 1318.00
171	2.00	EA	2750 - FLANGED JOINT, TEE,8 INCH X 8 INCH X 8 INCH, DUCTILE IRON,FLANGED, FUSION EPOXY COATED IN, NO ACCESSORIES, MEETS AWWA, ASTM,OR ANSI AND WRITTEN PROOF OF ISO 9000 CERTIFICATION. (101060) GROUP 25	\$ 560.00	\$ 1120.00
172	2.00	EA	2780 - FLANGED JOINT,TEE,12 IN X 12 IN DUCTILE IRON,FLANGED,FUSION EPOXY COATED WITHOUT ACCESSORIES,MUST HAVE AWWA,ASTM OR ANSI APPROVAL AND WRITTEN PROOF OF ISO9001 CERTIFICATION (101150) GROUP 25	\$ 1424.00	\$ 2848.00
173	2.00	EA	2790 - REDUCER,CONCENTRIC,4 IN X 3 IN, DUCTILE IRON, FLANGED,FUSION EPOXY COATED,WITHOUT ACCESSORIES. 00-0091010 GROUP 26	\$ 260.00	\$ 520.00
174	2.00	EA	2800 - PLUG,6 IN,DUCTILE IRON,MECH JOINT,WITH 2 IN FEMALE PIPE THREAD TAP	\$ 159.00	\$ 318.00

INVITATION TO BID FROM JEFFERSON PARISH - continued

BID NO.: 50-00146343

SEALED BID

ITEM NUMBER	QUANTITY	U/M	DESCRIPTION OF ARTICLES	UNIT PRICE QUOTED	TOTALS
175	2.00	EA	IN CENTER,EPOXY COATED IN AND OUT. 00-009002A 2810 - PLUG,8 IN,DUCTILE IRON,MECH JOINT,WITH 2 IN FEMALE PIPE THREAD TAP	\$ 195.00	\$ 390.00
176	2.00	EA	IN CENTER,EPOXY COATED IN AND OUT. 00-009003A 2820 - PLUG,12 IN DUCTILE IRON, MECH JOINT WITH 2 IN FEMALE PIPE THREAD	\$ 288.00	\$ 576.00
177	16.00	EA	TAP IN CENTER,EPOXY COATED IN AND OUT, DOMESTIC, NO ACCESSORIES 00-009005A 2830 - REDUCER,CONCENTRIC,6 IN X 4 IN, DUCTILE IRON,FLANGED,FUSION EPOXY COATED,WITHOUT ACESSORIES 00-0091030 GROUP 26	\$ 282.00	\$ 4512.00
178	2.00	EA	2840 - REDUCER,CONCENTRIC,8 IN X 6 IN, DUCTILE IRON, FLANGED EPOXY COATED IN AND OUT DOMESTIC, MEETS AWWA 00-0091040 GROUP 26	\$ 305.00	\$ 610.00
179	2.00	EA	2850 - REDUCER,CONCENTRIC,12 IN X 8 IN, DUCTILE IRON, FLANGED,FUSION EPOXY COATED, WITHOUT ACCESSORIES. 00-0091080 GROUP 26	\$ 659.00	\$ 1318.00
180	2.00	EA	2860 - BEND,45 DEGREE,6 INCH ,DUCTILE IRON,FLANGED,FUSION EPOXY COATED WITHOUT ACCESSORIES 00-006152 GROUP 18	\$ 334.00	\$ 668.00
181	2.00	EA	2870 - BEND,90 DEGREE,3 INCH ,DUCTILE IRON, FLANGED,FUSION EPOXY COATED, WITHOUT ACCESSORIES 00-006175 GROUP 19	\$ 211.00	\$ 422.00

DATE: 10/23/2024

Page 29

INVITATION TO BID FROM JEFFERSON PARISH - continued

BID NO.: 50-00146343

SEALED BID

ITEM NUMBER	QUANTITY	U/M	DESCRIPTION OF ARTICLES	UNIT PRICE QUOTED	TOTALS
			FOR EB & WB WAREHOUSE ENGINEERING DEPT.-CHANEN JOSEPH 504-736-6824		

Ductile Iron Fittings Contract

(Ductile Iron Fittings and Price Brothers' Pipe Adapter Kits)

ITEMS INCLUDED IN THIS CONTRACT:

- | | |
|-----------|--|
| GROUP 1. | Mechanical Joint Repair Sleeves (Lines 0010 thru 0280) |
| GROUP 2. | Mechanical Joint 90° Bends (Lines 0290 thru 0400) |
| GROUP 3. | Mechanical Joint x Flange 90° Bends (Lines 0410 thru 0460) |
| GROUP 4. | Mechanical Joint 45° Bends (Lines 0470 thru 0580) |
| GROUP 5. | Mechanical Joint x Flange 45° Bends (Lines 0600 thru 0630) |
| GROUP 6. | Mechanical Joint 22-½° Bends (Lines 0640 thru 0730) |
| GROUP 7. | Mechanical Joint 11-¼° Bends (Lines 0750 thru 0780) |
| GROUP 8. | Mechanical Joint Tees (Lines 0790 thru 0920) |
| GROUP 9. | Mechanical Joint x Flange Tees (Lines 0970 thru 1025) |
| GROUP 10. | Mechanical Joint Swivel Tees (Lines 1040 thru 1110) |
| GROUP 11. | Mechanical Joint Crosses (Lines 1130 thru 1150) |
| GROUP 12. | Mechanical Joint Concentric Reducers (Lines 1160 thru 1250) |
| GROUP 13. | Mechanical Joint x Flange Adapters (Lines 1270 thru 1290) |
| GROUP 14. | Mechanical Joint Caps (Lines 1310 thru 1330) |
| GROUP 15. | Mechanical Joint Plugs (Lines 1380 thru 1420) |
| GROUP 16. | Mechanical Joint Offsets (Lines 1470 thru 1480) |
| GROUP 17. | Price Brothers Adapter Kits (Lines 1500 thru 1570) |
| GROUP 18. | Flanged Joint, 45° Bend (Protecto 401 Ceramic Interior Lining)
(Lines 1710 thru 1715 and Line 2860) |
| GROUP 19. | Flanged Joint, 90° Bend (Protecto 401 Ceramic Interior Lining)
(Lines 1770 thru 1820 and Line 2870) |
| GROUP 20. | Flanged Joint, 90° Bend, Reducing (Protecto 401 Ceramic Interior
Lining) (Lines 1870 thru 1880) |
| GROUP 21. | Flanged Joint, Crosses (Protecto 401 Ceramic Interior Lining)
(Lines 1890 thru 1950) |
| GROUP 22. | Flanged Joint, Concentric Reducers (Protecto 401 Ceramic Interior
Lining) (Lines 1960 thru 2080) |
| GROUP 23. | Flanged Joint, Tees (Protecto 401 Ceramic Interior Lining)
(Lines 2090 thru 2210) |
| GROUP 24. | Flanged Joint, True Wyes (Protecto 401 Ceramic Interior Lining) (Line
2220) |
| GROUP 25. | Flange Joint, Tees (Protecto 401 Ceramic Lining)
(Lines 2710 thru 2780) |
| GROUP 26. | Flange Joint, Concentric Reducer (Protecto 401 Ceramic Lining)
(Line 2790 and Lines 2830 thru 2850) |

***** Note: This contract may be awarded accordingly to the low bidder of each group mentioned above. *****

Contract Terms:

This is a two (2) year contract for supply of Ductile Iron Fittings and Adapter Kits for Price Brothers pipe for the Department of Public Works, Waterworks, and all Jefferson Parish agencies and municipalities.

Warranty:

Products shall be warranted that they are manufactured in accordance with the applicable material specifications and are free from defects in workmanship and materials for one year after delivery. Any defective items sold under this contract shall be replaced at no cost to the purchaser.

General Specifications:

This specification is prepared for a two (2) year contract for a supply of Ductile Iron Fittings and Adapter Kits for Price Brothers pipe for the Parish of Jefferson, Department of Water, East and Westbank.

The quantities shown on the proposal guide are approximate quantities to be acquired by Jefferson Parish over a two (2) year period. Actual usage will be on an "as needed" basis.

Domestic as well as globally sourced (foreign) ductile iron fittings shall be allowed. All globally sourced (foreign) fittings shall also be manufactured at an ISO (International Organization for Standardization) registered manufacturer, which manufacturer shall have current ISO 9001 certification for standardization for fitting products. These manufacturing facilities must be covered under periodic audits by third party accreditation bodies for evaluations. These evaluations shall include manufacturing processes, quality control, corrective and preventive actions, and document control. In addition, distribution centers must be audited by third party approval agencies for periodic confirmation tests and surveillance audits. These periodic confirmation tests and surveillance audits shall document continuation of product approvals by auditing the entire quality systems including design, infrastructure, system implementation, distribution, training, quality control and assurance, and document control. All fittings must be manufactured in accordance with NSF 61.

For material bid as equal, technical literature with the brand must be submitted with the bid.

Upon request, all technical literature containing the brand and part numbers that your company is bidding on must be submitted.

The manufacturer's name and the country of origin must be stamped on all fittings.

Bid delivery shall include all freight and delivery costs to Jefferson Parish warehouse locations on the East and West Banks of Jefferson Parish.

Technical Specifications:**I. Ductile Iron Fittings:**

Fittings shall be available in 3" through 48" sizes and shall be cast from ductile iron in accordance with ANSI/AWWA C110/A21.10 and ANSI/AWWA C111/A21.11. Compact fittings shall be available in 3" through 24" and shall be cast from ductile iron in accordance with ANSI/AWWA C153/A21.53. All fittings shall have working pressure rating of 350 psi.

Ductile iron fittings shall have factory applied fusion bonded epoxy coating inside and out, in accordance with all applicable provisions of AWWA C-550 and ANSI/AWWA C116/A21.16-98 (protective fusion-bonded epoxy coatings for the interior and exterior surfaces of ductile iron fittings for water supply services).

II. Adapter Kits For Price Brothers Pipe (16" - 48"):

The purpose of these adapter kits is to connect Price Brothers pipe (Prestressed Concrete Cylinder Pipe, or PCCP) to valves, PVC C-900 or ductile iron pipe. Each kit shall include the following for each size:

- A) One each, price brother bell x mechanical joint spigot, minimum 18" long.
- B) One each, price brother spigot x mechanical joint spigot, minimum 18" long.
- C) Two each, PCCP O-ring gaskets.
- D) Two each, PCCP diaper (grout bands).

III. Ductile Iron Fittings (Protecto 401 Interior Lining):

Fittings shall be available in 3" through 48" sizes and shall be cast from ductile iron in accordance with ANSI/AWWA C110/A21.10 and ANSI/AWWA C111/A21.11. Compact fittings shall be available in 3" through 24" and shall be cast from ductile iron in accordance with ANSI/AWWA C153/A21.53. All fittings shall have working pressure rating of 350 psi.

Ductile iron fittings shall have a factory applied interior coating/lining of "Protecto 401" ceramic epoxy lining as per manufacturer's recommendations and requirements for sanitary sewer applications and factory asphaltic exterior coating.

Non-Public Works Bid Affidavit Instructions

- Affidavit is supplied as a courtesy to Affiants, but it is the responsibility of the affiant to insure the affidavit they submit to Jefferson Parish complies, in both form and content, with federal, state and parish laws.
- Affidavit must be signed by an authorized representative of the entity or the affidavit will not be accepted.
- Affidavit must be notarized or the affidavit will not be accepted.
- Notary must sign name, print name, and include bar/notary number, or the affidavit will not be accepted.
- Affiant **MUST** select either A or B when required or the affidavit will not be accepted.
- Affiants who select choice A must include an attachment or the affidavit will not be accepted.
- If both choice A and B are selected, the affidavit will not be accepted.
- Affidavit marked N/A will not be accepted.
- It is the responsibility of the Affiant to submit a new affidavit if any additional campaign contributions are made after the affidavit is executed but prior to the time the council acts on the matter.

Instruction sheet may be omitted when submitting the affidavit

Non-Public Works Bid

AFFIDAVIT

STATE OF Louisiana

PARISH/COUNTY OF Jefferson

BEFORE ME, the undersigned authority, personally came and appeared: Hunter
Burgess, (Affiant) who after being by me duly sworn, deposed and said that
he/she is the fully authorized Salesman of CIMSCO, Inc. (Entity),
the party who submitted a bid in response to Bid Number 5000146343, to the Parish of
Jefferson.

Affiant further said:

Campaign Contribution Disclosures

(Choose A or B, if option A is indicated please include the required attachment):

Choice A _____

Attached hereto is a list of all campaign contributions, including the date and amount of each contribution, made to current or former elected officials of the Parish of Jefferson by Entity, Affiant, and/or officers, directors and owners, including employees, owning 25% or more of the Entity during the two-year period immediately preceding the date of this affidavit or the current term of the elected official, whichever is greater. Further, Entity, Affiant, and/or Entity Owners have not made any contributions to or in support of current or former members of the Jefferson Parish Council or the Jefferson Parish President through or in the name of another person or legal entity, either directly or indirectly.

Choice B  _____

there are NO campaign contributions made which would require disclosure under Choice A of this section.

Debt Disclosures

(Choose A or B, if option A is indicated please include the required attachment):

Choice A _____ Attached hereto is a list of all debts owed by the affiant to any elected or appointed official of the Parish of Jefferson, and any and all debts owed by any elected or appointed official of the Parish to the Affiant.

Choice B ✓ There are NO debts which would require disclosure under Choice A of this section.

Affiant further said:

That Affiant has employed no person, corporation, firm, association, or other organization, either directly or indirectly, to secure the public contract under which he received payment, other than persons regularly employed by the Affiant whose services in connection with the construction, alteration or demolition of the public building or project or in securing the public contract were in the regular course of their duties for Affiant; and

[The remainder of this page is intentionally left blank.]

That no part of the contract price received by Affiant was paid or will be paid to any person, corporation, firm, association, or other organization for soliciting the contract, other than the payment of their normal compensation to persons regularly employed by the Affiant whose services in connection with the construction, alteration or demolition of the public building or project were in the regular course of their duties for Affiant.



Signature of Affiant

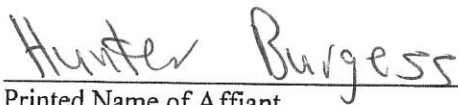

Printed Name of Affiant

SWORN AND SUBSCRIBED TO BEFORE ME

ON THE 6TH DAY OF November, 2024

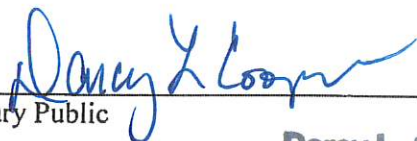
Notary Public

Darcy L. Cooper

Notary Public ID #87529

Printed Name of Notary **Louisiana Statewide Jurisdiction**

My Commission is for Life

Notary/Bar Roll Number _____

My commission expires _____.

CORPORATE RESOLUTION

EXCERPT FROM MINUTES OF MEETING OF THE BOARD OF DIRECTORS OF
CIMSCO, INC.
INCORPORATED.

AT THE MEETING OF DIRECTORS OF CIMSCO, INC.
INCORPORATED, DULY NOTICED AND HELD ON March 28, 2024
A QUORUM BEING THERE PRESENT, ON MOTION DULY MADE AND SECONDED. IT
WAS:

RESOLVED THAT Hunter Burgess, BE AND IS HEREBY
APPOINTED, CONSTITUTED AND DESIGNATED AS AGENT AND ATTORNEY-IN-
FACT OF THE CORPORATION WITH FULL POWER AND AUTHORITY TO ACT ON
BEHALF OF THIS CORPORATION IN ALL NEGOTIATIONS, BIDDING, CONCERNS
AND TRANSACTIONS WITH THE PARISH OF JEFFERSON OR ANY OF ITS AGENCIES,
DEPARTMENTS, EMPLOYEES OR AGENTS, INCLUDING BUT NOT LIMITED TO, THE
EXECUTION OF ALL BIDS, PAPERS, DOCUMENTS, AFFIDAVITS, BONDS, SURETIES,
CONTRACTS AND ACTS AND TO RECEIVE ALL PURCHASE ORDERS AND NOTICES
ISSUED PURSUANT TO THE PROVISIONS OF ANY SUCH BID OR CONTRACT, THIS
CORPORATION HEREBY RATIFYING, APPROVING, CONFIRMING, AND ACCEPTING
EACH AND EVERY SUCH ACT PERFORMED BY SAID AGENT AND ATTORNEY-IN-
FACT.

I HEREBY CERTIFY THE FOREGOING TO BE
A TRUE AND CORRECT COPY OF AN
EXCERPT OF THE MINUTES OF THE ABOVE
DATED MEETING OF THE BOARD OF
DIRECTORS OF SAID CORPORATION, AND
THE SAME HAS NOT BEEN REVOKED OR
RESCINDED.

Ashley Riviere
SECRETARY-TREASURER

10/29/24

DATE

STANDARD INSURANCE REQUIREMENTS FOR BIDDING PURPOSES

All required insurance under this bid shall conform to Jefferson Parish Resolution No. 136353 or No. 141125, as applicable. Contractors may not commence any work under any ensuing contract unless and until all required insurance and associated evidentiary requirements thereto have been met, along with any additional specifications contained in the Invitation to Bid. Except as where otherwise precluded by law, the Parish Attorney or her designee, with the concurrence of the Director of Risk Management or her designee, may agree on a case-by-case basis, to deviate from Jefferson Parish's standard insurance requirements, as provided in this Section. **Vendors requesting deviation therefrom shall submit such requests in writing, along with compelling substantiation, to the Purchasing Department prior to the bid's due date.** Any changes to the insurance requirements will be reflected in the bid specifications and addenda. Prior to contract execution and at all times thereafter during the term of such contract, contractors must provide and continuously maintain all coverages as required by the foregoing Resolutions, and the contract documents. Failure to do so shall be grounds for suspension, discontinuation or termination of the contract.

For bidding purposes, bidders must submit with bid submission a current (valid) insurance certificate evidencing the required coverages. **Failure to comply will cause the bid to be rejected.** The current insurance certificate will be used for proof of insurance at time of evaluation. Thereafter, and prior to contract execution, the low bidder will be required to provide final insurance certificates to the Parish which shall name the Parish of Jefferson, its Districts Departments and Agencies under the direction of the Parish President and the Parish Council as additional insureds regarding negligence by the contractor for the Commercial General Liability and the Comprehensive Automobile Liability policies. Additionally, said certificates should reflect the name of the Parish Department receiving goods and services and reference the respective Jefferson Parish bid number.

JEFFERSON PARISH REQUIRED STANDARD INSURANCE

☒ WORKER'S COMPENSATION INSURANCE

As required by Worker's Compensation Law of the State of the Contractor's headquarters. Employer's Liability is included, with minimum limits of \$500,000 per occurrence, except it shall be \$1,000,000 per occurrence when Work is to be over water and involves maritime exposures to cover all employees not covered under the State Worker's Compensation Act.

With a Waiver of Subrogation in favor of The Parish of Jefferson, its Districts, Departments, Agencies and Employees under the direction of the Parish President and the Parish Council, and any other entities who may require waivers by specific contract.

Note: If your company is not required by law to carry workmen's compensation insurance, i.e. sole employee of the company, then bidders must request a workmen's compensation insurance declaration affidavit prior to the bid opening date. This insurance declaration affidavit must be fully completed, signed, properly notarized and submitted with the bid. A scanned copy may be submitted with the

bid; however, the successful bidder must submit the original affidavit in its original format and without material alteration upon contract execution. Failure to comply will result in the bid submission being rejected as non-responsive. The Parish reserves the right to award bid to the next lowest responsive and responsible bidder in this event.

☒ **COMMERCIAL GENERAL LIABILITY**

Limits of not less than the following: \$1,000,000.00 Combined Single Limit Per Occurrence; 2 million General Aggregate for bodily injury and property damage.

With a Waiver of Transfer of Rights of Recovery Against Others to Us in favor of The Parish of Jefferson, its Districts, Departments, Agencies and Employees under the direction of the Parish President and the Parish Council.

☒ **BUSINESS AUTOMOBILE LIABILITY**

Limits of not less than the following: Bodily injury liability \$1,000,000.00 each person; \$1,000,000.00 each occurrence. Property Damage Liability \$1,000,000.00 each occurrence. Liability coverage to be provided for Any Auto or for ALL Owned Autos and Hired and Non-owned Autos.

With a Waiver of Transfer of Rights of Recovery Against Others to Us in favor of The Parish of Jefferson, its Districts, Departments, Agencies and Employees under the direction of the Parish President and the Parish Council.

Note: This category may be omitted if bidders do not/will not utilize vehicles for the project AS DETERMINED BY Risk Management and Parish Attorney's Office after properly requesting a deviation as discussed above. Bidder must request a deviation prior to bid opening and may be given an automobile insurance declaration affidavit to execute. This insurance declaration affidavit must be fully completed, signed, properly notarized and submitted with the bid. A scanned copy of the completed, signed and properly notarized affidavit may be submitted with the bid; however, the successful bidder must submit the original affidavit in its original format and without material alteration upon contract execution. Failure to comply will result in the bid submission being rejected as non-responsive. The Parish reserves the right to award bid to the next lowest responsive and responsible bidder in this event.

DEDUCTIBLES - The Parish Attorney with concurrence of the Director of Risk Management have waived the deductible section of the Terms and Conditions for all Invitations to Bid, until further notice.

UMBRELLA LIABILITY COVERAGE - An umbrella policy or excess may be used to meet minimum requirements. Certificate of Insurance must state which coverage the Umbrella sits over.

FOR CONSTRUCTION AND RENOVATION PROJECTS:

The following are required if selected below. Such insurance is due upon contract execution.

☐ **OWNER'S PROTECTIVE LIABILITY**

To be for the same limits of liability for bodily injury and property damage liability established for commercial general liability.

☐ **BUILDER'S RISK INSURANCE**

The contractor shall maintain Builder's Risk Insurance at his own expense to insure both the owner (Parish of Jefferson) and contractor as their interest may appear.



CERTIFICATE OF LIABILITY INSURANCE

DATE (MM/DD/YYYY)

09/03/2024

THIS CERTIFICATE IS ISSUED AS A MATTER OF INFORMATION ONLY AND CONFERS NO RIGHTS UPON THE CERTIFICATE HOLDER. THIS CERTIFICATE DOES NOT AFFIRMATIVELY OR NEGATIVELY AMEND, EXTEND OR ALTER THE COVERAGE AFFORDED BY THE POLICIES BELOW. THIS CERTIFICATE OF INSURANCE DOES NOT CONSTITUTE A CONTRACT BETWEEN THE ISSUING INSURER(S), AUTHORIZED REPRESENTATIVE OR PRODUCER, AND THE CERTIFICATE HOLDER.

IMPORTANT: If the certificate holder is an ADDITIONAL INSURED, the policy(ies) must have ADDITIONAL INSURED provisions or be endorsed. If SUBROGATION IS WAIVED, subject to the terms and conditions of the policy, certain policies may require an endorsement. A statement on this certificate does not confer rights to the certificate holder in lieu of such endorsement(s).

PRODUCER E B Ducasse Insurance Agency, Inc 3200 Ridgeline Dr, Suite 401 Metairie LA 70002		CONTACT NAME: Darly Osar PHONE (A/C, No, Ext): (504) 840-9883 FAX (A/C, No): (504) 840-9889 E-MAIL ADDRESS: dosar@ebducasse.com													
INSURED Cimsco Inc P O Box 9130 Station A Metairie LA 70055		INSURER(S) AFFORDING COVERAGE <table><tr><td>INSURER A: Wesco Insurance Co</td><td>NAIC # 25011</td></tr><tr><td>INSURER B: Technology Insurance Co</td><td>19879</td></tr><tr><td>INSURER C: Security National Insurance Co</td><td>15954</td></tr><tr><td>INSURER D: Amtrust Insurance Co</td><td></td></tr><tr><td>INSURER E:</td><td></td></tr><tr><td>INSURER F:</td><td></td></tr></table>		INSURER A: Wesco Insurance Co	NAIC # 25011	INSURER B: Technology Insurance Co	19879	INSURER C: Security National Insurance Co	15954	INSURER D: Amtrust Insurance Co		INSURER E:		INSURER F:	
INSURER A: Wesco Insurance Co	NAIC # 25011														
INSURER B: Technology Insurance Co	19879														
INSURER C: Security National Insurance Co	15954														
INSURER D: Amtrust Insurance Co															
INSURER E:															
INSURER F:															

COVERAGES**CERTIFICATE NUMBER:** CL249304830**REVISION NUMBER:**

THIS IS TO CERTIFY THAT THE POLICIES OF INSURANCE LISTED BELOW HAVE BEEN ISSUED TO THE INSURED NAMED ABOVE FOR THE POLICY PERIOD INDICATED. NOTWITHSTANDING ANY REQUIREMENT, TERM OR CONDITION OF ANY CONTRACT OR OTHER DOCUMENT WITH RESPECT TO WHICH THIS CERTIFICATE MAY BE ISSUED OR MAY PERTAIN, THE INSURANCE AFFORDED BY THE POLICIES DESCRIBED HEREIN IS SUBJECT TO ALL THE TERMS, EXCLUSIONS AND CONDITIONS OF SUCH POLICIES. LIMITS SHOWN MAY HAVE BEEN REDUCED BY PAID CLAIMS.

INSR LTR	TYPE OF INSURANCE	ADDL INSD	SUBR WVD	POLICY NUMBER	POLICY EFF (MM/DD/YYYY)	POLICY EXP (MM/DD/YYYY)	LIMITS														
A	<input checked="" type="checkbox"/> COMMERCIAL GENERAL LIABILITY <input type="checkbox"/> CLAIMS-MADE <input checked="" type="checkbox"/> OCCUR GEN'L AGGREGATE LIMIT APPLIES PER: <input type="checkbox"/> POLICY <input checked="" type="checkbox"/> PROJECT <input type="checkbox"/> LOC OTHER:			WPP192911203	09/01/2024	09/01/2025	<table><tr><td>EACH OCCURRENCE</td><td>\$ 1,000,000</td></tr><tr><td>DAMAGE TO RENTED PREMISES (Ea occurrence)</td><td>\$ 100,000</td></tr><tr><td>MED EXP (Any one person)</td><td>\$ 5,000</td></tr><tr><td>PERSONAL & ADV INJURY</td><td>\$ 1,000,000</td></tr><tr><td>GENERAL AGGREGATE</td><td>\$ 2,000,000</td></tr><tr><td>PRODUCTS - COMP/OP AGG</td><td>\$ 2,000,000</td></tr><tr><td></td><td>\$</td></tr></table>	EACH OCCURRENCE	\$ 1,000,000	DAMAGE TO RENTED PREMISES (Ea occurrence)	\$ 100,000	MED EXP (Any one person)	\$ 5,000	PERSONAL & ADV INJURY	\$ 1,000,000	GENERAL AGGREGATE	\$ 2,000,000	PRODUCTS - COMP/OP AGG	\$ 2,000,000		\$
EACH OCCURRENCE	\$ 1,000,000																				
DAMAGE TO RENTED PREMISES (Ea occurrence)	\$ 100,000																				
MED EXP (Any one person)	\$ 5,000																				
PERSONAL & ADV INJURY	\$ 1,000,000																				
GENERAL AGGREGATE	\$ 2,000,000																				
PRODUCTS - COMP/OP AGG	\$ 2,000,000																				
	\$																				
B	<input checked="" type="checkbox"/> AUTOMOBILE LIABILITY <input checked="" type="checkbox"/> ANY AUTO <input type="checkbox"/> OWNED AUTOS ONLY <input type="checkbox"/> SCHEDULED AUTOS <input type="checkbox"/> HIRED AUTOS ONLY <input type="checkbox"/> NON-OWNED AUTOS ONLY			WPP123964200	09/01/2024	09/01/2025	<table><tr><td>COMBINED SINGLE LIMIT (Ea accident)</td><td>\$ 1,000,000</td></tr><tr><td>BODILY INJURY (Per person)</td><td>\$</td></tr><tr><td>BODILY INJURY (Per accident)</td><td>\$</td></tr><tr><td>PROPERTY DAMAGE (Per accident)</td><td>\$</td></tr><tr><td></td><td>\$</td></tr></table>	COMBINED SINGLE LIMIT (Ea accident)	\$ 1,000,000	BODILY INJURY (Per person)	\$	BODILY INJURY (Per accident)	\$	PROPERTY DAMAGE (Per accident)	\$		\$				
COMBINED SINGLE LIMIT (Ea accident)	\$ 1,000,000																				
BODILY INJURY (Per person)	\$																				
BODILY INJURY (Per accident)	\$																				
PROPERTY DAMAGE (Per accident)	\$																				
	\$																				
C	<input checked="" type="checkbox"/> UMBRELLA LIAB <input checked="" type="checkbox"/> OCCUR <input type="checkbox"/> EXCESS LIAB <input type="checkbox"/> CLAIMS-MADE DED RETENTION \$			SMB181015900	09/01/2024	09/01/2025	<table><tr><td>EACH OCCURRENCE</td><td>\$ 1,000,000</td></tr><tr><td>AGGREGATE</td><td>\$ 1,000,000</td></tr><tr><td></td><td>\$</td></tr></table>	EACH OCCURRENCE	\$ 1,000,000	AGGREGATE	\$ 1,000,000		\$								
EACH OCCURRENCE	\$ 1,000,000																				
AGGREGATE	\$ 1,000,000																				
	\$																				
D	WORKERS COMPENSATION AND EMPLOYERS' LIABILITY ANY PROPRIETOR/PARTNER/EXECUTIVE OFFICER/MEMBER EXCLUDED? (Mandatory in NH) If yes, describe under DESCRIPTION OF OPERATIONS below Y/N <input type="checkbox"/> N/A			KWC1365991	09/01/2024	09/01/2025	<table><tr><td><input checked="" type="checkbox"/> PER STATUTE <input type="checkbox"/> OTHER</td><td></td></tr><tr><td>E.L. EACH ACCIDENT</td><td>\$ 1,000,000</td></tr><tr><td>E.L. DISEASE - EA EMPLOYEE</td><td>\$ 1,000,000</td></tr><tr><td>E.L. DISEASE - POLICY LIMIT</td><td>\$ 1,000,000</td></tr></table>	<input checked="" type="checkbox"/> PER STATUTE <input type="checkbox"/> OTHER		E.L. EACH ACCIDENT	\$ 1,000,000	E.L. DISEASE - EA EMPLOYEE	\$ 1,000,000	E.L. DISEASE - POLICY LIMIT	\$ 1,000,000						
<input checked="" type="checkbox"/> PER STATUTE <input type="checkbox"/> OTHER																					
E.L. EACH ACCIDENT	\$ 1,000,000																				
E.L. DISEASE - EA EMPLOYEE	\$ 1,000,000																				
E.L. DISEASE - POLICY LIMIT	\$ 1,000,000																				

DESCRIPTION OF OPERATIONS / LOCATIONS / VEHICLES (ACORD 101, Additional Remarks Schedule, may be attached if more space is required)

The general liability and auto liability policies contain a blanket additional insured and blanket waiver of subrogation if required by written contract. The general liability is primary and non contributory. Umbrella policy follows the underlying liability.

Bid #5000146343 Two year contract for supply of ductile iron fittings & adapter kits for the Jefferson Parish Department of Public Works- Water & all Jefferson Parish Agencies and Municipalities

CERTIFICATE HOLDER**CANCELLATION**

Jefferson Parish Purchasing Department 200 Derbigny Street Suite 4400 Gretna LA 70063	SHOULD ANY OF THE ABOVE DESCRIBED POLICIES BE CANCELLED BEFORE THE EXPIRATION DATE THEREOF, NOTICE WILL BE DELIVERED IN ACCORDANCE WITH THE POLICY PROVISIONS. AUTHORIZED REPRESENTATIVE <i>Edward B. Ducasse, Sr.</i>
--	--

© 1988-2015 ACORD CORPORATION. All rights reserved.



C153 Mechanical Joint Ductile Iron Fittings

**C
O
M
P
A
C
T

M
J**





SIGMA

Weights in Pounds, Less Accessories / Dimensions in Inches
Ductile Iron Class 350 per ANSI/AWWA C153/A21.53

C153 Mechanical Joint Compact Fittings

3-48" Ductile Iron Mechanical Joint Fittings Class 350

MATERIAL: Ductile Iron ASTM A536

PRESSURE: 350PSI WATER WORKING PRESSURE (CLASS 350) 3" - 24": & 250 PSI 30" - 48"

TESTING: In accordance with ANSI / AWWA C153 / A21.53 & UL - FM requirements

LAYING LENGTH: Short body design - straight section of body deleted to provide a compact and lighter fitting without reducing strength or flow characteristics, in accordance with ANSI / AWWA C153 / A21.53

CEMENT LINING: In accordance with ANSI / AWWA C104 / A21.4 **COATING:** Tar coated (bituminous) inside and out in accordance with ANSI / AWWA C104 / A21.4

GASKETS: SBR in accordance with ANSI / AWWA C111 / A21.11

T-BOLTS: Low Alloy corrosion resistant high strength steel in accordance with ANSI / AWWA C111 / A21.11

APPROVALS: 3"-16" Underwriters Laboratories listed and Factory Mutual Approved.

STANDARDS: Certified to NSF61 Standard ANSI / AWWA C153 / A21.53 for Compact Ductile Iron Fittings 3"-48" for water and other liquids.

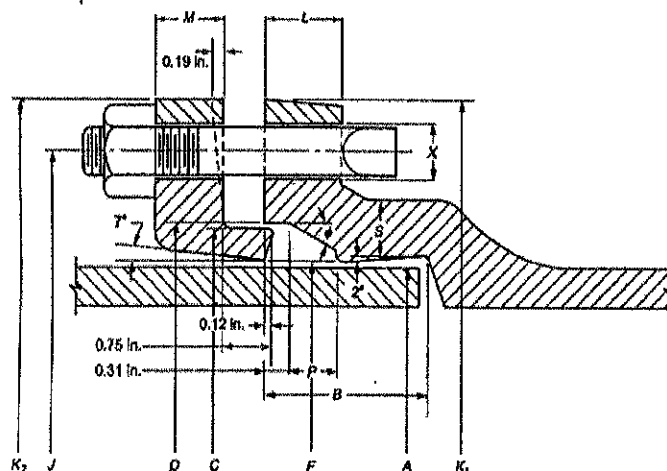

Mechanical Joint Detail

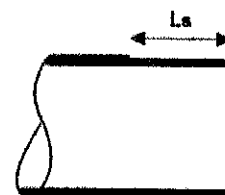

Plain End Detail

Size	A	B	C	D	F	J	K1	K2	L	M	P	S	X	Bolts			
														No	Size	Len	Ls
3	3.96	2.50	4.84	4.94	4.06	6.19	7.62	7.69	0.58	0.62	0.63	0.39	3/4	4	5/8	3.0	5.5
4	4.80	2.50	5.92	6.02	4.90	7.50	9.06	9.12	0.60	0.75	0.75	0.39	7/8	4	3/4	3.5	5.5
6	6.90	2.50	8.02	8.12	7.00	9.50	11.06	11.12	0.63	0.88	0.75	0.43	7/8	6	3/4	3.5	5.5
8	9.05	2.50	10.17	10.27	9.15	11.75	13.31	13.37	0.66	1.00	0.75	0.45	7/8	6	3/4	3.5	5.5
10	11.10	2.50	12.22	12.34	11.20	14.00	15.62	15.62	0.70	1.00	0.75	0.47	7/8	8	3/4	3.5	5.5
12	13.20	2.50	14.32	14.44	13.30	16.25	17.88	17.88	0.73	1.00	0.75	0.49	7/8	8	3/4	3.5	5.5
14	15.30	3.50	16.40	16.54	15.44	18.75	20.25	20.25	0.79	1.25	0.75	0.55	7/8	10	3/4	4.0	8.0
16	17.40	3.50	18.50	18.64	17.54	21.00	22.50	22.50	0.85	1.31	0.75	0.58	7/8	12	3/4	4.0	8.0
18	19.50	3.50	20.60	20.74	19.64	23.25	24.83	24.75	1.00	1.38	0.75	0.68	7/8	12	3/4	4.0	8.0
20	21.60	3.50	22.70	22.84	21.74	25.50	27.08	27.00	1.02	1.44	0.75	0.69	7/8	14	3/4	4.0	8.0
24	25.80	3.50	26.90	27.04	25.94	30.00	31.58	31.50	1.02	1.56	0.75	0.75	7/8	16	3/4	4.5	8.0
30	32.00	4.00	33.29	33.46	32.17	36.88	39.12	39.12	1.31	2.00	1.00	0.82	1 1/8	20	1	5.5	8.0
36	38.30	4.00	39.59	39.76	38.47	43.75	46.00	46.00	1.45	2.00	1.00	1.00	1 1/8	24	1	5.5	8.0
42	44.50	4.00	45.79	45.96	44.67	50.62	53.12	53.12	1.45	2.00	1.00	1.25	1 3/8	28	1 1/4	6.0	8.0
48	50.80	4.00	52.09	52.26	50.97	57.50	60.00	60.00	1.45	2.00	1.00	1.35	1 3/8	32	1 1/4	6.0	8.0

SIGMA PROTECTIVE FUSION BONDED EPOXY COATED AWWA FITTINGS

Product Information Sheet

SIGMA FBE Coated Fittings are NSF61 and Annex G approved for potable water applications. The Epoxy Coated Fittings meet or exceed ANSI/AWWA C116/A21.16 and C550 standards (Protective Fusion-Bonded Epoxy Coatings for the Interior and Exterior surfaces of Ductile-Iron and Gray-Iron fittings for water supply service).



Product Description

FBE is a high performance anti-corrosion coating that provides excellent protection for ductile and gray iron fittings with moderate operating temperatures.

Applications

FBE coating has a successful long history of usage in the waterworks industry on the following categories of products:

- Fire hydrant components
- Check valves
- Resilient wedge seated gate valve
- Industrial valves

Approvals and Standards



Corrosion Protection

- FBE's excellent adhesion to fittings provides superior long term corrosion resistance and protection of SIGMA's fittings operating at moderate temperatures.
- Superior adhesion properties provide excellent resistance to cathodic disbondment which reduces the total cost of cathodic protection during the operation of the pipeline.

Properties

Color	Red
Coating Thickness	8 mils min.
Adhesion	5A of ASTM D3359 Method A -- X cut and tape.
Adhesion	5B of ASTM D3359 Method B -- Crosscut and tape.

- FBE coated fittings of SIGMA are available from 2" to 48" in accordance with ANSI/AWWA C153/A21.53 and ANSI/AWWA C110/A21.10
- Coating provides a smooth inner surface with less frictional losses.
- Epoxy coating allows for use in many wastewater applications where cement lining is not acceptable.



ONE



LOK

Series SLCE for PVC Pipe

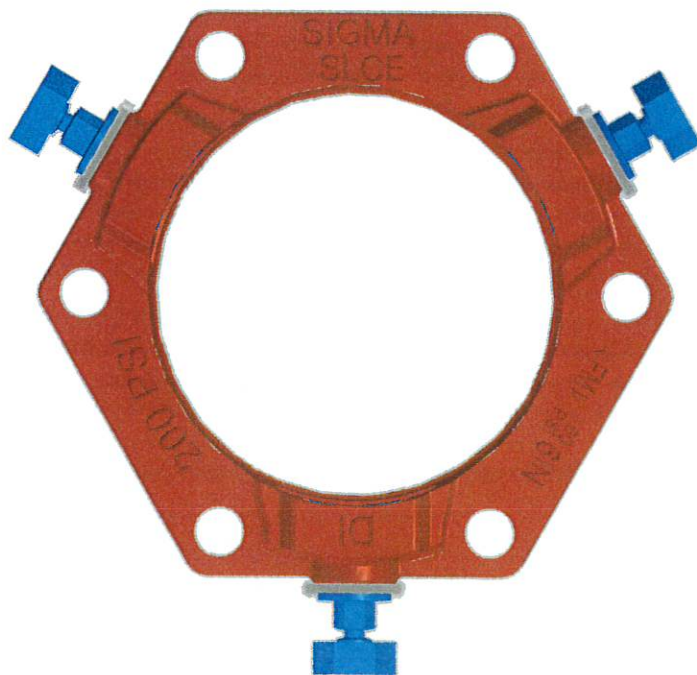
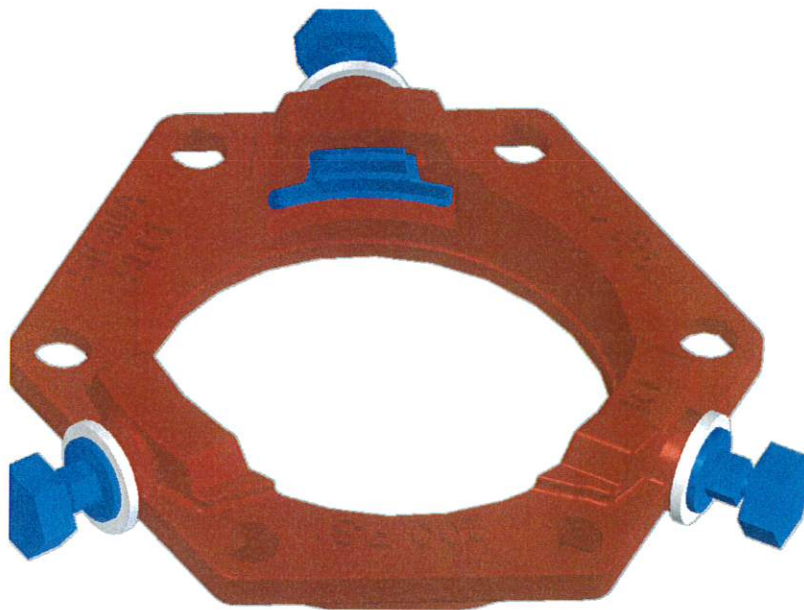

Sigma Corporation
700 Goldman Drive
PO Box 300
Cream Ridge, NJ 08514
(800) 999-2550

©2011 Sigma Corporation, All Rights Reserved



ONE-LOK



Series SLCE for PVC Pipe

The SIGMA ONE-LOK™ Series SLCE is a mechanical joint restraining gland that implements a series of individually activated wedges into the mechanical joint follower gland. When the wedge segment is engaged by the actuating bolt, the primary contact edges of each wedge segment lock onto the pipe wall. This action causes the primary contact edges to grip the pipe and effectively restrain all classifications of both AWWA C900/C905 and ASTM D2241 IPS size PVC pipe.

ONE-LOK SLCE's precision contoured wedges provide proper contact and support of the PVC pipe wall. Each wedge is manufactured with an elongated contour that evenly matches the outside circumference of each nominal diameter of PVC pipe.

ONE-LOK SLCE's wedge actuating bolt provides the installer with two visual torque indicators. The breakaway top and secondary shoulder stop ensure proper engagement of the wedge segment at the time of installation. Unlike other actuating bolts, the ONE-LOK SLCE is manufactured with a proprietary quality control system that ensures the breakaway tops will activate at the correct torque. The breakaway top is sized to match the same dimensions of the bolts and nuts used to assemble the mechanical joint fitting and follower gland, eliminating the need for special installation tools. Once engaged, the actuating bolt leaves a residual hex-head shank, allowing post-installation disassembly of the restrained joint, if necessary.

ONE-LOK SLCE also features a non-corrosive, two-piece ABS plastic spacer that is removed when using the product to restrain IPS sized pipes meeting ASTM D2241. The two-piece design of this spacer allows it to be removed without requiring disassembly of the product. When the ONE-LOK SLCE is used to restrain pipes meeting AWWA C900, the spacer is left intact on the actuating bolt.

ONE-LOK SLCE's unique wedge segment and actuating bolt design allows the two components to interface using a cam action principle, allowing the wedge segments to rock and increase their grip on the pipe wall as thrust on the assembled joint increases. This also allows improved resistance to subsidence, seismic forces, and other movement within the maximum deflection limitations of the mechanical joint under applicable AWWA standards.

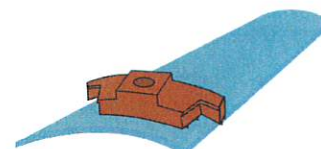
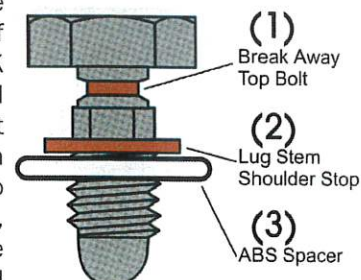

Series SLCE for PVC Pipe

Dimensions in Inches, Weights in Pounds

Size	Item #	Weight (lbs)	PVC Pipe DI OD	IPS Pipe OD	Dimensions								Bolts and Inserts		
					C	F	K2	T	p	P*	X	J	No	Size	Torque
3	SLCE3	6.21		3.50	4.76	3.60	7.69	0.60	9.42	8.50	0.750	6.14	2	7/8	45-55
4	SLCE4	6.78	4.80	4.50	5.92	4.90	7.92	0.60	10.22	9.30	0.875	7.50	2	7/8	50-60
6	SLCE6	10.28	6.90	6.63	8.01	7.00	10.00	0.60	12.87	11.95	0.875	9.50	3	7/8	50-60
8	SLCE8	14.48	9.05	8.63	10.17	9.15	12.18	0.75	14.37	13.45	0.875	11.75	4	7/8	50-60
10	SLCE10	21.40	11.10	10.75	12.22	11.20	14.60	0.85	16.68	15.76	0.875	14.00	6	7/8	50-60
12	SLCE12	26.96	13.20	12.75	14.32	13.30	16.64	0.85	18.58	17.66	0.875	16.25	8	7/8	50-60
14	SLCE14	33.67	15.30		16.40	15.44	20.25	1.20	21.68	19.98	0.875	18.75	10	7/8	55-65
16	SLCE16	41.67	17.40		18.50	17.54	22.45	1.21	23.65	21.95	0.875	21.00	12	7/8	55-65
18	SLCE18	49.50	19.50		20.60	19.64	24.75	1.25	25.79	24.09	0.875	23.25	12	7/8	55-65
20	SLCE20	61.17	21.60		22.70	21.74	27.00	1.34	28.16	26.46	0.875	25.50	14	7/8	55-65
24	SLCE24	79.33	25.80		26.90	25.94	31.50	1.46	32.70	31.00	0.875	30.00	16	7/8	55-65
30	SLCE30	198.00	32.00		33.29	32.17	38.42	2.00	41.92	39.92	1.125	36.88	20	1.00	65-75
36	SLCE36	248.00	38.30		39.59	38.47	46.00	2.00	48.78	46.78	1.125	43.75	24	1.00	65-75

ONE-LOK SLCE was previously referred to as model SLC

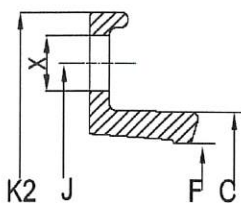
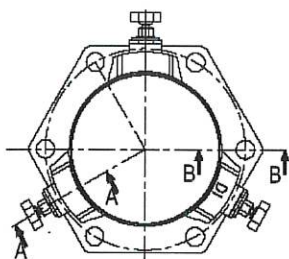

SECTION B - B

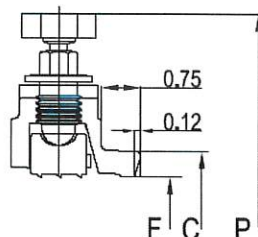

SECTION A - A



Sizes 4" - 12" are FM approved for 150 psi on AWWA C900 pipe and have been tested in accordance with ASTM F1674.

3-12" pressure rated at 200psi working pressure
 14-24" pressure rated at 235psi working pressure
 30-36" pressure rated at 165psi working pressure



ONE LOK

Sample Specification: Restraint for standard mechanical joint fittings shall be incorporated in the design of the follower gland and shall utilize multiple wedge segments that act against the pipe, increasing their resistance as the line pressure increases. The assembled joint shall maintain the maximum flexibility and deflection of all nominal pipe sizes after burial. Restraining gland, wedge segments, and actuating bolts shall be manufactured of high strength ductile iron conforming to the requirements of ASTM A536, Grade 65-45-12. Dimensions shall be compatible with standardized mechanical joints conforming to the requirements AWWA C111/ANSI A21.11 and AWWA C153/ANSI 21.53 through 24" (latest revision). Breakaway tops shall be incorporated in the design of the actuating bolts to visually ensure proper torque. The manufacturing of the actuating bolt must incorporate a quality control procedure that is deemed acceptable by the specifier and positively assures precise and consistent operating torque of the breakaway top. The mechanical joint restraining devices shall have a working pressure rating of 200psi (235psi for sizes 14-36") minimum and provide no less than a safety factor of 2:1. Restraint shall be FM approved in applicable sizes. Restraining device shall be SIGMA ONE-LOK™ or approved equal.



Installation Instructions

Note: This product is not designed to be used on plain end fittings.

1. Clean fitting socket and pipe end. Lubricate gasket and pipe end with soapy water (or approved pipe lubricant meeting AWWA C111). Install ONE-LOK™ restrainer on the pipe with the lip extension facing the pipe end, followed by the gasket, tapered side toward end of pipe. Insert pipe into fitting outlet and seat the gasket firmly and evenly into the gasket cavity. Maintain a straight joint during assembly.

NOTE: SIGMASEAL Gasket is recommended for ONE-LOK 30-48". When installing SIGMASEAL gasket, the tapered edges of the gasket must face away from the pipe wall.

2. Push the ONE-LOK gland toward the fitting and center it around the pipe with the lip evenly against the gasket. Insert the T-bolts and hand-tighten the nuts. If deflection is required, make up after joint assembly but before tightening T-bolts.

3. Tighten T-bolts in an alternating manner maintaining an even gap between the gland and the fitting face at all points around the socket. Repeat until all the T-bolts are within the recommended torque value of AWWA C111/C600.

4. For installation on IPS O.D. PVC Pipe, twist, break, and remove the ABS spacers from the actuating bolts. DO NOT REMOVE SPACERS when installing product on C900 PVC. Hand tighten all actuating bolt until complete contact of all wedge segments is made with the pipe.

5. Tighten each actuating in a clockwise direction, alternating between the bolts in a star pattern until all the break-off tops have been removed. Never tighten an actuating bolt more than 180 degrees before moving to the next bolt.

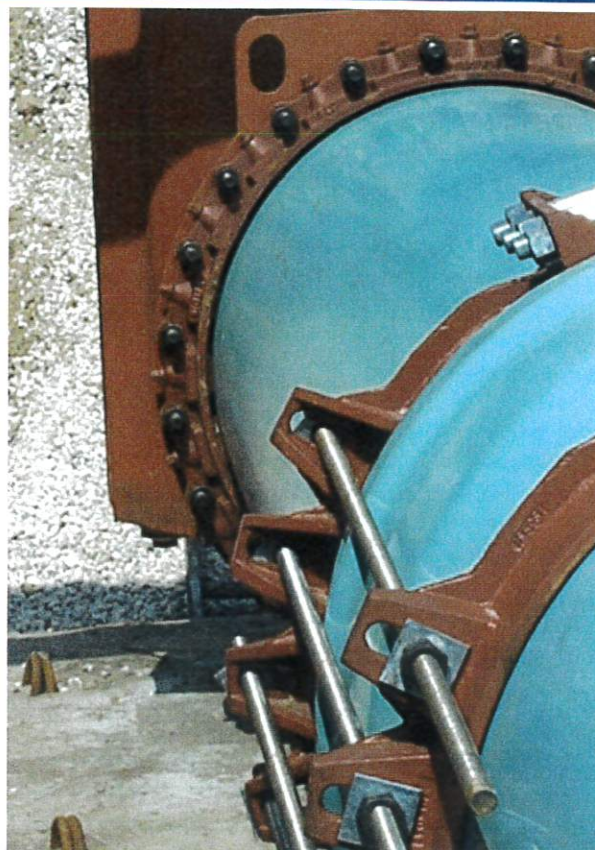

www.sigmaco.com

Cream Ridge, NJ (800)-999-2550 crm-sales@sigmaco.com	Houston, TX (800)-999-0109 htn-sales@sigmaco.com	Alexander City, AL (800)-824-4513 rps-sales@sigmaco.com	Ontario, CA (800)-688-6230 ont-sales@sigmaco.com	Sauk Village, IL (888)-999-0420 chi-sales@sigmaco.com
--	--	---	--	---

New York	Texas	Alabama	California	Illinois
New Jersey	Louisiana	Florida	Arizona	Indiana
Maryland	Arkansas	Georgia	Colorado	Wisconsin
Delaware	Missouri	North Carolina	Alaska, Hawaii	Michigan
Virginia	Kansas	South Carolina	Idaho, Utah	Minnesota
New England	New Mexico	Tennessee	Nevada	North Dakota
Eastern Canada	Nebraska	Mississippi	Washington	South Dakota
Pennsylvania	Oklahoma		Oregon, Wyoming	Ohio
	Iowa		Montana	Kentucky
	Puerto Rico		Western Canada	West Virginia

ONE-LOK SLCE for PVC Pipe



**Ceramic Epoxy Lined Ductile Iron
Fittings**



Quality – Service – Commitment – Delivered.

PROTECTO 401™ CERAMIC EPOXY LINED DUCTILE IRON FITTINGS

Product Information Sheet



SIGMA's PROTECTO 401 Lined Ductile Iron Fittings with 40 mils dry film thickness provide excellent protection and the strength required to carry out the job in tough sewer pipe applications. PROTECTO 401 has been successfully used in thousands of sanitary sewer applications and has been proven with both laboratory testing and two decades of actual sewer service on all sizes of ductile Iron pipe and fittings.

PROTECTO 401 Ceramic Epoxy Lining was designed specifically for protection of ductile iron for sanitary sewer service by providing reliability similar to cement mortar lining in drinking water service but having the excellent chemical resistance of epoxy for septic sewer service.

PROTECTO 401 has been tested and withstood:

- **Salt Spray Testing**

Two years with no undercutting on a scribed ductile iron panel when measured using ASTM B 117 and when rated using ASTM D 714 evaluating degrees of blistering.

- **20% Sulfuric Acid**

Two years with no effect when rated using ASTM D 714 evaluating degree of blistering.

- **25% Sodium Hydroxide Immersion**

At 140°F two years with no effect when rated using ASTM D 714 evaluating degree of blistering.

- **Distilled Water Immersion**

At 160°F two years with no effect when rated using ASTM D 714 evaluating degree of blistering.

- **Abrasion Resistance**

Less than .075mm (3 mils) loss after one million cycles on a plus 22.5° to minus 22.5° sliding aggregate slurry abrasion tester using a sharp natural siliceous gravel with a particle size between 2mm and 10 mm.

Benefits:

Ceramic epoxy lining offers excellent resistance to abrasion, mechanical damage and chemical attack. In pipelines conveying slurries or septic sewage this coating can provide a robust effective protection enhancing the longevity of performance.

Ceramic Epoxy Coating Provides:

- High abrasion resistance
- Flexible film characteristics
- High corrosion resistance
- High dielectric strength
- Low permeability
- Class 1 fire and smoke rating
- Machinable film
- Acceptable for food contact

STANDARD SPECIFICATION FOR LINING DUCTILE IRON FITTINGS FOR SEWER SERVICE

I. Condition of ductile iron prior to surface preparation

All ductile iron pipe fittings shall be delivered to the application facility without asphalt, cement lining, or any other lining on the interior surface. Because removal of old linings may not be possible, the intent of this specification is that the entire interior of the ductile iron fittings shall not have been lined with any substance prior to the application of the specified lining material.

II. Lining material

The standard of quality is Protecto 401™ Ceramic Epoxy. The material shall be an amine cured novolac epoxy containing at least 20% by volume of ceramic quartz pigment. Any request for substitution must be accompanied by a successful history of lining fittings for sewer service, a test report verifying the following properties, and a certification of the test results.

A. A permeability rating of 0.00 when tested according to Method A of ASTM E-96-66, Procedure A with a test duration of 30 days.

B. The following test must be run on coupons from factory lined ductile iron fitting:

- ASTM B-117 Salt Spray (scribed panel) - Results to equal 0.0 undercutting after two weeks.
- ASTM G-95 Cathodic Disbondment 1.5 volts @ 77°F. Results to equal no more than 0.5 mm undercutting after 30 days.
- Immersion testing rated using ASTM D-714-87.
 - 20% Sulfuric acid—No effect after two years.
 - 140°F 25% Sodium Hydroxide—No effect after two years.
 - 160°F Distilled Water—No effect after two years.
 - 120°F Tap Water (scribed panel) - 0.0 after undercutting after two years with no effect.
- ASTM G-22 90 Standard practice for determining resistance of Synthetic Polymeric materials to bacteria. The test should determine the resistance to growth of Acidithiobacillus Bacteria and should be conducted at 30 degrees centigrade for a period of 7 days on a minimum of 4 panels. The growth must be limited only to trace amounts of bacteria.

C. An abrasion resistance of no more than 3 mils

III. Application**Applicator**

The lining shall be applied by a certified firm with a successful history of applying linings to the interior of ductile iron fittings. All applicators must be independently inspected at least two times per year to insure compliance with the requirements of this specification. This inspection must be coordinated and reviewed by the manufacturer of the lining material and any deviation from the application and/or quality requirements shall be corrected by the applicator. All inspections shall be in writing and a permanent record maintained.

Surface Preparation

Prior to abrasive blasting, the entire area to receive the protective compound shall be inspected for oil, grease, etc. Any areas with oil, grease, or any substance that can be removed by solvent, shall be solvent cleaned to remove those substances. After the surface has been made free of grease, oil or other substances, all areas to receive the protective compounds shall be abrasive blasted using sand or grit abrasive media. The entire surface to be lined shall be struck with the blast media so that all rust, loose oxides, etc., are removed from the surface. Only slight stains and tightly adhering oxide may be left on the surface. Any area where rust reappears before lining must be re-blasted.



**Ceramic Epoxy Lined Ductile Iron
Fittings**



Quality – Service – Commitment – Delivered.

Lining

After surface preparation and within 12 hours of surface preparation, the interior of the fitting shall receive 40 mils nominal dry film thickness. No lining shall take place when the substrate or ambient temperature is below 40°F. The surface also must be dry and dust free. If flange fittings are included in the project, the lining shall not be used on the face of the flange.

Coating of Bell Sockets and Spigot Ends

Due to the tolerances involved, the gasket area and spigot end up to 6 inches back from the end of the spigot end must be coated with 6 mils nominal, 10 mils maximum using Protecto 401™ Joint Compound. The Joint Compound shall be applied by brush to ensure coverage. Care should be taken that the Joint Compound is smooth without excess buildup in the gasket seat or on the spigot ends. Coating of the gasket seat and spigot ends shall be done after the application of the lining.

Number of Coats

The number of coats of lining material applied shall be as recommended by the lining manufacturer. However, in no case shall this material be applied above the dry thickness per coat recommended by the lining manufacturer in printed literature. The maximum or minimum time between coats shall be that time recommended by the lining material manufacturer. To prevent delamination between coats, no material shall be used for lining which is not indefinitely recoatable with itself without roughening of the surface.

Touch-Up and Repair

Protecto 401™ Joint Compound shall be used for touch-up or repair in accordance with manufacturer's recommendations.

IV. Inspection and certification

Inspection

All ductile iron fitting linings shall be checked for thickness using a magnetic film thickness gauge. The thickness testing shall be done using the method outlined in SSPC PA-2 Film Thickness Rating.

The interior lining of all fittings shall be tested for pinholes with a non-destructive 2,500 volt test. Any defects found shall be repaired prior to shipment. Each fitting shall be marked with the date of application of the lining system along with its numerical sequence of application on that date and records maintained by the applicator of his work.

Certification

The fitting manufacturer must supply a certificate attesting to the fact that the applicator met the requirements of this specification, and that the material used was as specified.

V. Handling

Lined fittings must be handled only from the outside of the pipe and fittings. No forks, chains, straps, hooks, etc. shall be placed inside the fittings for lifting, positioning, or laying. The fitting shall not be dropped or unloaded by rolling. Care should be taken not to let the fitting strike sharp objects while swinging or being off loaded.

C110 Flanged Fittings



2-64in CAST IRON/DUCTILE IRON FLANGED FITTINGS **BASIC SPECIFICATIONS**

MATERIAL:	Ductile Iron ASTM A536 Grade 60-42-10, 65-45-12 or 70-50-05.
PRESSURE:	250 PSI Water Working Pressure for Cast Iron sizes 2" - 12" 250 PSI Water Working Pressure for Ductile Iron sizes 2" - 48" 150 PSI Water Working Pressure for Ductile Iron sizes 54" - 64" 150 PSI Water Working Pressure for Cast Iron sizes 14" - 64"
TESTING:	In accordance with ANSI / AWWA C110 / A21.10 where applicable. Other items are in accordance with manufacturer's standards. 54" and above Flanged Fittings are manufactured as per AWWA C153/A21.53
LAYING LENGTH:	In accordance with ANSI / AWWA C110 / A21.10 where applicable. Other items are in accordance with manufacturer's standards. 54" and above Flanged Fittings are manufactured as per AWWA C153/A21.53
CEMENT LINING:	In accordance with ANSI / AWWA C104 / A21.4
COATING:	Interior of fitting is seal coated (asphalt material) in accordance with ANSI / AWWA C104/ A21.4 and NSF61 approved Red Primer Outside For special conditions, other types of coatings and linings are available Please specify when ordering
APPROVALS:	2"-16" Underwriters Laboratories listed and Factory Mutual Approved.
STANDARDS:	Certified to NSF61 Standard ANSI / AWWA C110 / A21.10 Where applicable. Other items are in accordance with manufacturer's standards. 54" and above Flanged Fittings are manufactured as per AWWA C153/A21.53

Note: call for Cast Iron Fittings





ONE
LOK



Series SLDE for Ductile Iron Pipe



Sigma Corporation
700 Goldman Drive
PO Box 300
Cream Ridge, NJ 08514
(800) 999-2550



ONE LOK



Series SLDE for Ductile Iron Pipe

The SIGMA ONE-LOK™ Series SLDE is a mechanical joint restraining gland that implements a series of individually activated wedges into the mechanical joint follower gland. When the wedge segment is engaged by the actuating bolt, the primary contact edges of each wedge segment lock onto the pipe wall. This action causes the primary contact edges to grip the pipe and effectively restrain all classifications of ductile iron pipe.

ONE-LOK SLDE's precision contoured wedges provide proper contact and support of the ductile iron pipe wall. Each wedge is manufactured with an elongated contour that evenly matches the outside circumference of each nominal diameter of ductile iron pipe. This elongated contour also eliminates the concern of damage to both the pipe wall and the interior cement mortar lining caused by point loading, even on the thinner pressure classes of ductile iron pipe.

ONE-LOK SLDE's wedge actuating bolt provides the installer with a visual torque indicator. The breakaway top ensures proper engagement of the wedge segment at the time of installation. Unlike other actuating bolts, the ONE-LOK SLDE is manufactured with a proprietary quality control system that ensures the breakaway tops will activate at the correct torque. The breakaway top is sized to match the same dimensions of the bolts and nuts used to assemble the mechanical joint fitting and follower gland, eliminating the need for special installation tools. Once engaged, the actuating bolt leaves a residual hex-head shank, allowing post-installation disassembly of the restrained joint, if necessary.

ONE-LOK SLDE's unique wedge segment and actuating bolt design allows the two components to interface using a cam action principle, allowing the wedge segments to rock and increase their grip on the pipe wall as thrust on the assembled joint increases. This also allows improved resistance to subsidence, seismic forces, and other movement within the maximum deflection limitations of the mechanical joint under applicable AWWA standards.





Series SLDE for Ductile Iron Pipe

Dimensions in Inches, Weights in Pounds

Size	Item #	Wt (lbs)	Pipe OD	Dimensions								Bolts and Inserts		
				C	F	D	T	P*	B	J	K2	No.	Size	Torque
3	SLDE3	5.5	3.96	4.84	4.16	1.58	0.55	9.40	0.750	6.19	7.69	2	7/8	80-90
4	SLDE4	6.5	4.80	5.92	5.00	1.58	0.55	10.24	0.875	7.50	9.12	2	7/8	80-90
6	SLDE6	10.0	6.90	8.02	7.10	1.58	0.60	12.34	0.875	9.50	11.12	3	7/8	80-90
8	SLDE8	14.5	9.05	10.17	9.25	1.63	0.75	14.32	0.875	11.75	13.37	4	7/8	80-90
10	SLDE10	23.0	11.10	12.22	11.30	1.58	0.85	16.54	0.875	14.00	15.62	6	7/8	80-90
12	SLDE12	29.0	13.20	14.32	13.40	1.58	0.85	18.80	0.875	16.25	17.88	8	7/8	80-90
14	SLDE14	39.6	15.30	16.40	15.55	1.58	1.13	21.20	0.875	18.75	20.25	10	7/8	80-90
16	SLDE16	49.7	17.40	18.50	17.54	1.77	1.21	23.74	0.875	21.00	22.50	12	7/8	80-90
18	SLDE18	60.3	19.50	20.60	19.64	1.77	1.25	25.84	0.875	23.25	24.75	12	7/8	80-90
20	SLDE20	69.0	21.60	22.70	21.74	1.87	1.25	27.94	0.875	25.50	27.00	14	7/8	80-90
24	SLDE24	103.7	25.80	26.88	25.95	1.92	1.47	32.14	0.875	30.00	31.50	16	7/8	80-90
30*	SLDE30	158.7	32.00	33.29	32.17	2.13	1.65	39.30	1.125	36.88	39.12	20	1	100-120
36*	SLDE36	234.5	38.30	39.59	38.47	3.15	1.75	46.07	1.125	43.75	46.00	24	1	110-120
42*	SLDE42	336.8	44.50	45.79	44.67	3.56	2.25	53.25	1.38	50.62	53.38	28	1 1/4	110-120
48*	SLDE48	443.8	50.80	52.09	50.97	3.81	2.25	59.55	1.38	57.5	60.26	32	1 1/4	110-120

ONE-LOK SLDE was previously referred to as model SLD

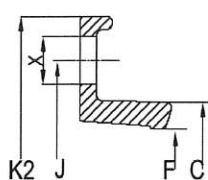
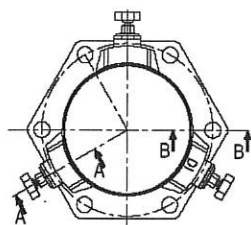

SECTION B - B

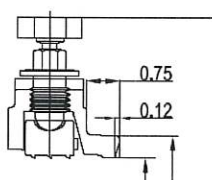

SECTION A - A



ONE LOK

* Product is provided with SIGMASEAL™ improved mechanical joint gasket.

Sizes 3" - 16" are pressure rated and UL listed for 350 psi on DI pipe and 250 psi sizes 18" - 36".

Sizes 42" and 48" are pressure rated at 250 psi.

Sizes 4" - 12" are FM approved for 175 psi on DI pipe.

Sample Specification: Restraint for standard mechanical joint fittings shall be incorporated in the design of the follower gland and shall utilize multiple wedge segments that act against the pipe, increasing their resistance as the line pressure increases. The assembled joint shall maintain the maximum flexibility and deflection of all nominal pipe sizes after burial. Restraining gland, wedge segments, and actuating bolts shall be manufactured of high strength ductile iron conforming to the requirements of ASTM A536, Grade 65-45-12. Wedge segments shall be heat treated to a hardness of 370 BHN minimum. Dimensions shall be compatible with standardized mechanical joints conforming to the requirements AWWA C111/ANSI A21.11 and AWWA C153/ANSI 21.53 through 24" (latest revision). Breakaway tops shall be incorporated in the design of the actuating bolts to visually ensure proper torque. The manufacturing of the actuating bolt must incorporate a quality control procedure that is deemed acceptable by the specifier and positively assures precise and consistent operating torque of the breakaway top. The mechanical joint restraining devices shall have a working pressure rating of 350psi (250psi for sizes 18-48") minimum and provide no less than a safety factor of 2:1. Restraint shall be UL Listed and FM approved in applicable sizes. Restraining device shall be SIGMA ONE-LOK™ or approved equal.



Installation Instructions

Note: This product is designed for use on ductile iron pipe. Contact SIGMA for use on plain end fittings.

1. Clean fitting socket and pipe end. Lubricate gasket and pipe end with soapy water (or approved pipe lubricant meeting AWWA C111). Install ONE-LOK™ restrainer on the pipe with the lip extension facing the pipe end, followed by the gasket, tapered side toward end of pipe.

NOTE: SIGMASEAL Gasket is recommended for ONE-LOK 30-48". When installing SIGMASEAL gasket, the tapered edges of the gasket must face away from the pipe wall.

2. Insert pipe into fitting outlet and seat the gasket firmly and evenly into the gasket cavity. Maintain a straight joint during assembly.

3. Push the ONE-LOK gland toward the fitting and center it around the pipe with the lip evenly against the gasket. Insert the T-bolts and hand tighten the nuts. If deflection is required, make up after joint assembly but before tightening T-bolts.

4. Tighten T-bolts in an alternating manner maintaining an even gap between the gland and the fitting face at all points around the socket. Repeat until all the T-bolts are within the recommended torque value of AWWA C111/C600.

5. Following proper assembly of the mechanical joint, hand tighten actuating bolts until all wedges until complete contact is made with the pipe.

6. Tighten each actuating bolt in a clockwise direction, alternating between the bolts in a star pattern, until all the break-off tops have been removed. Never tighten a wedge bolt more than 180 degrees before moving to the next bolt.



www.sigmaco.com

Cream Ridge, NJ (800)-999-2550 crm-sales@sigmaco.com	Houston, TX (800)-999-0109 htn-sales@sigmaco.com	Alexander City, AL (800)-824-4513 rps-sales@sigmaco.com	Ontario, CA (800)-688-6230 ont-sales@sigmaco.com	Sauk Village, IL (888)-999-0420 chi-sales@sigmaco.com
New York	Texas	Alabama	California	Illinois
New Jersey	Louisiana	Florida	Arizona	Indiana
Maryland	Arkansas	Georgia	Colorado	Wisconsin
Delaware	Missouri	North Carolina	Alaska, Hawaii	Michigan
Virginia	Kansas	South Carolina	Idaho, Utah	Minnesota
New England	New Mexico	Tennessee	Nevada	North Dakota
Eastern Canada	Nebraska	Mississippi	Washington	South Dakota
Pennsylvania	Oklahoma		Oregon, Wyoming	Ohio
	Iowa		Montana	Kentucky
	Puerto Rico		Western Canada	West Virginia

ONE-LOK SLDE for Ductile Iron Pipe